

15' ALLEY

N81°32'00"W 51.79'

635
J. & D. DIXON
VOL. 349 PG. 505

634
J. & D. DIXON
VOL. 192 PG. 104

633

632
STOKES

S08°28'00"W 100.00'

N08°28'00"E 100.00'

CENTER of 4'x4' FILLED IN
CISTERN 3' W of LOT LINE

RESID.

RESID.

GAR.

S81°32'00"E 51.79'

51.79'

50.0'

51.79'

S08°28'00"W, 2.00'

20.00'

SEAM @ CONC. RET. WALL

NOTE: BEARINGS ARE USED TO DENOTE ANGULAR RELATIONSHIPS ONLY

MAPLE ST. IS APPROX. FACE OF NORTH CURBING

NOTE: NO ORIGINAL MONUMENTATION FOUND.

- SOUTH LINE of A.L. HARTS ADD. APPEARS TO 20' N. of FACE of CURB (AS VERIFIED BY MONUMENTATION FOUND ON LOT 632 AND ALIGNMENT of NORTH SIDE of NORTH ALLEY EXTENDED WEST of ADDITION)
- EAST & WEST LOT LINES AS REESTABLISHED CONFIRMED BY MONUMENT FOUND @ S.E. CORNER LOT 632, IR PIPE FOUND S08°28'W, 2.00' of S.E. CORNER LOT 635, LOCATION of CISTERN on LOT 634, SEAM of CONC. RET. WALL

RESURVEY of LOT 634 of
A.L. HARTS ADDITION TO GLOUSTER
(FORMERLY SEDALIA). PLAT of WHICH
IS RECORDED AS SLIDE 129 B, PLAT
RECORDS, ATHENS CO. RECORDERS OFF.

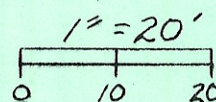

- IR. & CONC. FD.
- IR. PIPE FD.
- IR. PIN & CAP SET

Robert C. Canter

SURVEYED 8-15-1991 BY ROBERT C. CANTER
P.S. # 7226

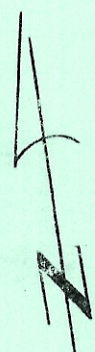
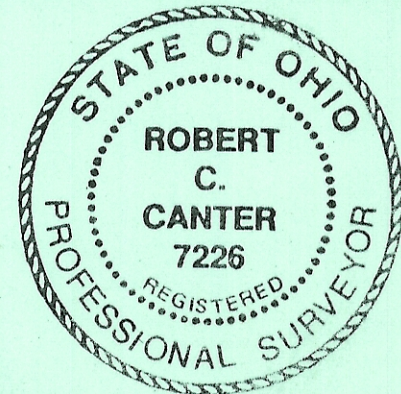

15' ALLEY

15' ALLEY