

CHARLES F. HUGHES, JR.
PROFESSIONAL SURVEYOR
PO BOX 216
MINERAL WELLS WV 26150
304 - 489 - 9640

March 5, 1993
93-0204

4.060 Acre Parcel
to be conveyed

Situated in the State of Ohio, Athens County, Troy Township, Section 11, Town 5 North, Range 11 West, more particularly described as follows;

Beginning for reference at a stone at the center of Section 11, thence N 05-47-00 E a distance of 1574.04 feet to a point in the center of Township Road 177; thence S 72-00-00 E a distance of 47.00 feet to a point at the intersection of Township Road 177 and Township Road 180; thence along or near the center of Township Road 180 the following two (2) courses, N 21-58 E a distance of 101.83 feet; thence N 08-09 E a distance of 105.86 feet, said point being the True Point of Beginning for the parcel herein described; thence continuing along Township Road 180 N 03-55-20 W a distance of 183.72 feet to a point; thence leaving said Township Road S 73-12-03 E a distance of 951.48 feet to an iron pin set, passing iron pins set at 20.15 feet and 744.05 feet; thence S 11-27-00 W a distance of 211.65 feet to an iron pin set; thence N 70-44-37 W a distance of 907.03 feet to the Point of Beginning, passing iron pins set at 192.28 feet and 895.52 feet, containing 4.060 Acres more or less but subject to all legal highways, right of ways, easements and restrictions of record.

Grantors hereby convey a 20 foot wide right of way for the purpose of ingress and egress beginning at an iron pin set at the Northeast corner of the above described tract and being described as a 20 foot wide strip laying east of a line bearing S 11-27-00 W and running a distance of 391.16 feet to the center of Township Road 177 more particularly shown on the attached plat to be made a part hereof.

This legal description was prepared by Charles F. Hughes, Jr. Professional Surveyor No. 7182 based on surveys in February 1993.

Troy #11

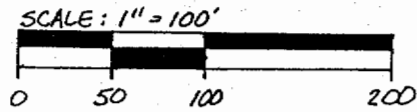

FLOYD HAPNEY et al 31.84 Ac.
VOL. 108 PG. 753

573°12'03"E 951.48' 207.43'

4.060 Ac.
VERNA MCCLUNG

OK to transfer family transfer Athens City - to H.D. Dexter Conrad, P.S. 3-16-93.

20' WIDE RIGHT-OF-WAY
511°27'00"W 211.65'

N70°44'37"W 907.03'(TOTAL)

RAYMOND F. HAPNEY
VOL. 360 PG. 407
VOL. 50 PG. 696
4.06 Ac.

DONALD D. & BONNIE M. BUCK
VOL. 333 PG. 487
40.38 Ac.

VOL. 203 PG. 69
0.75 Ac.

11.51'
N08°09'E 105.86'

N21°58'E 101.83'

JIM D. JACKSON
VOL. 25 PG. 1002
4.45 Ac.

RANDALL L. & DENISE A. HAPNEY
VOL. 91 PG. 64
4.45 Ac.

LONNIE E. & SUE HAPNEY
VOL. 316 PG. 353
2.46 Ac.

CHARLES & MARTHA ROUPE
VOL. 353 PG. 575
20.64 Ac.

LEGEND

- IRON PIN SET
- IRON PIN FOUND
- △ RAILROAD SPIKE FOUND
- IRON PIPE FOUND

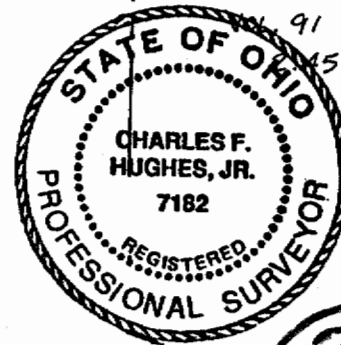

3

CHARLES F. HUGHES, JR.
PROFESSIONAL SURVEYOR

P.O. BOX 216, MINERAL WELLS, WV 26150
1-304-489-9640

DATE ASSIGNED:	DWN BY: LKM	FIELD CONTROL: F.H.
DATE COMPLETED: 3-3-93	DWN BY:	SCALE: 1" = 100'

Charles F. Hughes, Jr.
CHARLES F. HUGHES, JR.
P.S. No. 7182

3-5-93
DATE

SCALE: 1"=100'
NAME OF ALLOTMENT:
SECTION: 11
TOWN: 5N
RANGE: 11W
TAX MAP NO.

OWNER: VERNA MCCLUNG
STATE OF: OHIO
COUNTY OF: ATHENS
POLITICAL TOWNSHIP: TROY
CITY OF:
PLAT BOOK PG
DEED VOL PG

505°47'W 1,574.09'
TO STONE AT CENTER OF SECTION

572°00'E 47.00'

TROY TOWNSHIP ROAD 177

TROY TOWNSHIP ROAD 180
N05°55'20"W 183.72'

20.15'

20.00'

20.00'