



Know all Men by these Presents

That **STERLING SINGLETON and MARIE SINGLETON**, husband and wife

of Athens County, State of Ohio, for valuable consideration paid, grant

with general warranty covenants, to **LUTHER B. WILLIAMSON and JOYCE A. WILLIAMSON**, husband and wife, for their joint lives, remainder to the survivor thereof,

whose tax mailing address is Route 2, Box 124
Belpre, Ohio 45714

the following real property:

Situate in the State of Ohio, County of Athens and Township of Troy, being in the Southeast Quarter of Section 16, Town 5, Range 11:

Beginning at an iron spike in the center of Township Road T175 and Northwest corner of Southeast quarter of Section 16 corner to Leona M. Hubbard Volume 274, Page 665 with line of Hubbard; thence S 85° 36' 35" E 500.10 feet to an X found in a stream on the rock bed passing #5 rebar set at 20.00 feet and 340.00 feet referenced by rebars found N 87° 16' 22" W 12.93 feet and S 82° 49' 29" E 10.18 feet; thence S 15° 55' 43" W 708.83 feet to a spike in the center of Old Marietta Road passing #5 rebar set at 75.00 feet and 678.83 feet, with said road; thence N 83° 54' 20" W 118.94 feet to a spike in said road over a culvert; thence starting a curve to the right Delta L 16° 05' 08", radius 869.59 feet (Chord bearing arc length 244.13 feet, chord 243.33 feet, tangent 122.87 feet to a spike in said road, with Township Road T175; thence N 04° 30' 00" E 655.20 feet to point of beginning. N77° 09' 23" W)

Being 6.76 acres of the lands of Sterling and Marie Singleton V 320, Page 205 records of the Athens County Recorder as surveyed by J. Edward Huffman Ohio RLS #6850 and as shown on plat JEH 92014 a part of this record.

PRIOR INSTRUMENT REFERENCE: Volume 320, Page 205.

Description checked for
Mathematical Accuracy
ATHENS COUNTY
ENGINEER'S OFFICE
BY: Susan Odell
DATE: 10-27-92

Troy 10

DESCRIPTION OF 6.76 ACRE LOT OF STERLING SINGLETON

A PARCEL OF LAND STATE OF OHIO , COUNTY OF ATHENS , TOWNSHIP OF TROY, SOUTH EAST QUARTER OF SECTION 16 , TOWN S , RANGE 11 .

BEGINNING AT AN IRON SPIKE IN THE CENTER OF TOWNSHIP ROAD T175 AND NORTH WEST CORNER OF SOUTHEAST QUARTER OF SECTION 16 CORNER TO LEONA M. HUBBARD V274, P665 WITH LINE OF HUBBARD , THENCE

S 85 36 35 E 500.10 FEET TO AN X FOUND IN A STREAM ON THE ROCK BED PASSING #5 REBAR SET AT 20.00 FEET AND 340.00 FEET REFERENCED BY REBARS FOUND N 87 16 22 W 12.93 FEET AND S 82 49 29 E 10.18 FEET , THENCE

S 15 55 43 W 708.83 FEET TO A SPIKE IN THE CENTER OF OLD MARIETTA ROAD PASSING #5 REBAR SET AT 75.00 FEET AND 678.83 FEET , WITH SAID ROAD, THENCE

N 83 54 20 W 118.94 FEET TO A SPIKE IN SAID ROAD OVER A CULVERT, THENCE

STARTING A CURVE TO THE RIGHT DELTA L 16 05/08, RADIUS 869.59 FEET, ARC LENGTH 244.13 FEET, CHORD 243.33 FEET, TANGENT 122.87 FEET TO A SPIKE IN SAID ROAD, WITH TOWNSHIP ROAD T175 , THENCE

BEARING-N77°09'23"W

N 04 30 00 E 655.20 FEET TO POINT OF BEGINNING

BEING 6.76 ACRES OF THE LANDS OF STERLING & MARIE SINGLETON V 320, P 205 RECORDS OF THE ATHENS COUNTY RECORDER AS SURVEYED BY J.EDWARD HUFFMAN OHIO RLS #6850 AND AS SHOWN ON PLAT JEH 92014 A PART OF THIS RECORD.

Description checked for
Mathematical Accuracy
ATHENS COUNTY
ENGINEER'S OFFICE
BY: *[Signature]*
DATE: 10-27-92

Troy 16
2

WITH T-175

0 100 200 300 400

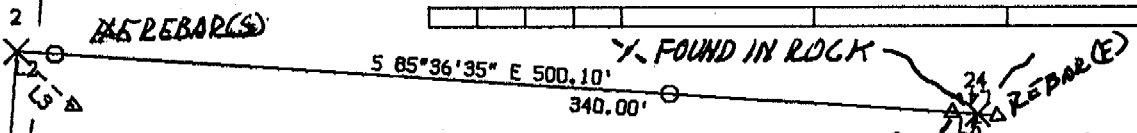

CURVE	DELTA ANGLE	RADIUS	ARC LENGTH	CHORD	TANGENT
C1	16°05'08"	869.58	244.13	243.33	122.87

N 77°09'23 W

LINE	DIRECTION	DISTANCE
L1	N 83°54'20" W	118.94
L2	S 85°33'49" E	20.00
L3	S 44°36'57" E	41.03
L4	N 87°16'22" W	12.93
L5	S 82°49'29" E	10.18
L6	N 46°27'37" E	41.07
L7	N 20°19'07" E	57.59

TOWNSHIP ROAD T 175 PAVED

N 04°30'00" E 655.20'

S 15°55'43" W 708.89'

SURVEY FOR STERLING & MARIE SINGLETON
 STATE OF OHIO, COUNTY OF ATHENS, TOWNSHIP OF TROY
 SECTION 16, TOWN 5, RANGE 11
 SURVEY BY J. EDWARD HUFFMAN OHIO PLS#6850
 PH 304-485-4707
 6.76 ACRES OF 27.4 ACRE TRACT
 VOL 320, P 205

POWER POLE

C1 B6 N 77°09'23 W
CORD 243.33'

OLD RT 50

OLD MARIETTA RD

EXISTING
CONCRETE

PLAT JEH-920914

CORD DATA ADDED 10-24-92

J. Edward Huffman 10/26/92

3