



CANTER

SURVEYING & MAPPING

Rt. 2, Box 139A
Glouster, OH 45732
(614) 767-2359

Situate in the NE 1/4 of Section 18, T5, R11, Troy Township, Athens County, Ohio and being a part of the N. Faye Ball et al parcels as described in Official Records Vol. 40, Pg. 899.

POINT-OF-BEGINNING being a point in County Road 59 (reference: iron pin found S05 30'00"W 329.26 feet and an iron pin set N76 51'50"E 18.36 feet), said Point-of-Beginning being N05 30'00"E 805.31 feet from an iron pin at the center of said Section 18;

Thence continuing along County Road 59 N05 30'00"E 217.20 feet to a point (reference: iron pin set N88 22'29"E 4.74 feet);

Thence leaving County Road 59 N88 22'29"E 172.44 feet to an iron pin set;

Thence S50 03'32"E 50.70 feet to an iron pin set in an existing stone drive;

Thence S12 51'53"E 130.87 feet to an iron pin set (reference: iron pin set at 87.60 feet);

Thence S76 51'49"W 268.22 feet to the Point-of-Beginning.

Containing 1.00 acres as surveyed 03-17-1993 by Robert C. Canter, P.S. 7226.

Plat of survey is attached herewith and made a part thereof.

Also including an easement for the rights of ingress and egress along an existing stone drive, said stone drive as delineated on plat of said survey.

Iron pins set are 5/8" x 30" rebar with plastic cap stamped "Canter P.S. 7226".

Basis of Bearings: West line of the NE 1/4 of Section 18 being N05 30'00"E as determined by survey of F.A. Dixon dated 03-30-1972. Bearings are used to determine angular relationships only.

Subject to all legal easements and right of ways.

Description checked for
Mathematical Accuracy
ATHENS COUNTY
ENGINEER'S OFFICE
BY: *S. Blausen*
DATE: 3-29-93

Troy #18

PLAT of SURVEY

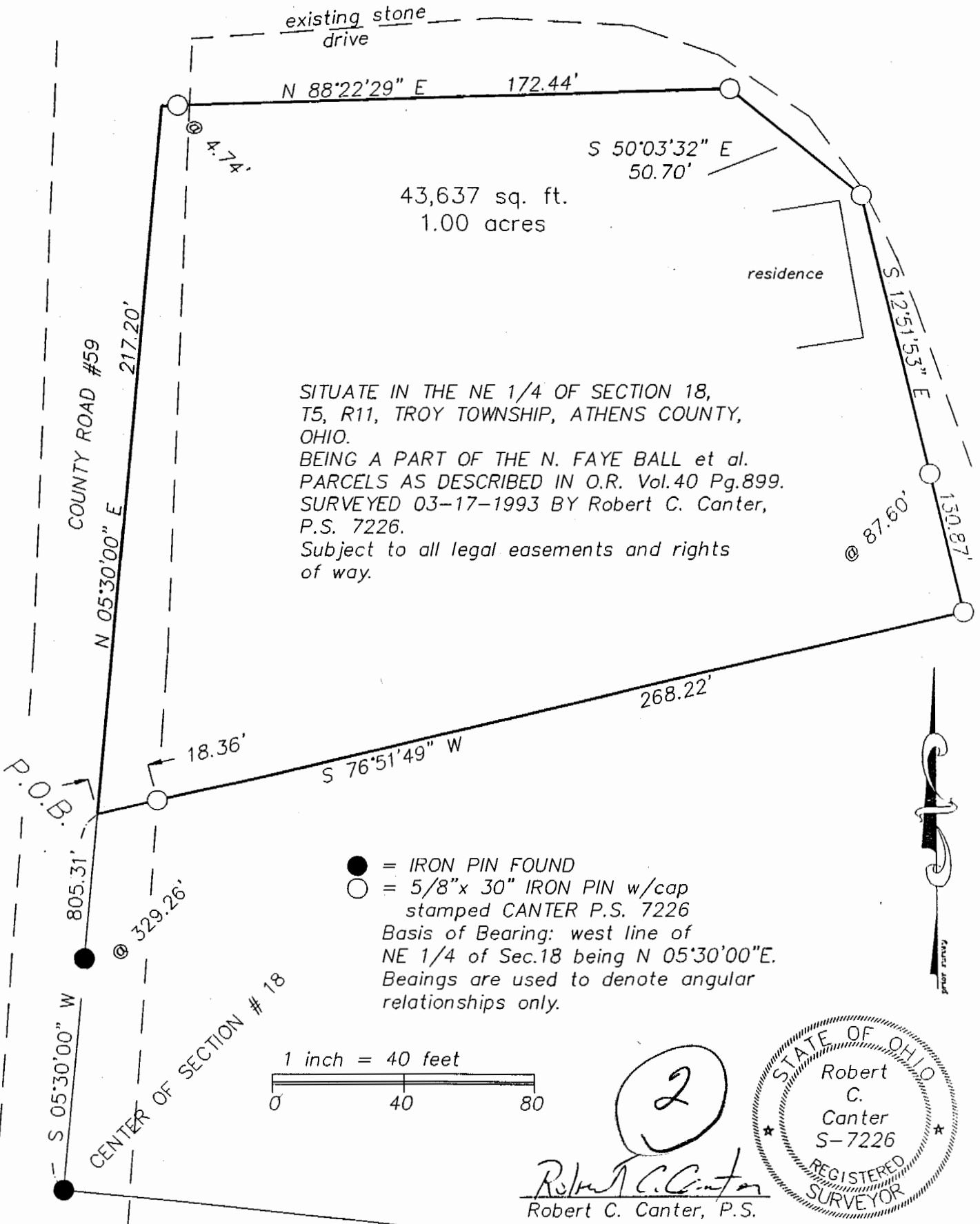

43,637 sq. ft.
1.00 acres

residence

SITUATE IN THE NE 1/4 OF SECTION 18,
T5, R11, TROY TOWNSHIP, ATHENS COUNTY,
OHIO.
BEING A PART OF THE N. FAYE BALL et al.
PARCELS AS DESCRIBED IN O.R. Vol.40 Pg.899.
SURVEYED 03-17-1993 BY Robert C. Canter,
P.S. 7226.
Subject to all legal easements and rights
of way.

- = IRON PIN FOUND
 - = 5/8"x 30" IRON PIN w/cap stamped CANTER P.S. 7226
- Basis of Bearing: west line of NE 1/4 of Sec.18 being N 05°30'00"E.
Bearings are used to denote angular relationships only.

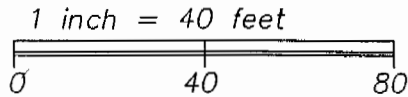

2

Robert C. Canter
Robert C. Canter, P.S.

