

Julius M. Murphy to
Robert D. Murphy and
Leno V. Murphy.

4th E. Atlas file
Sec 5 TROY
LAVELLE

Being in section 5 township 5, Range
11, Troy Township, Athens County,
State of Ohio.

Starting at a point at the Southeast
corner of the Northwest quarter of section
5. Thence north 840 feet to the
center of Township Road 178 the
real point of beginning.

Thence along the centerline of
said township road 178 in an
~~east~~^{west} direction 1,000 feet to
a point. (800?)

Thence north 1400 feet to
a point in the north property
line of Granters property deed
reference 257 page 535,

Thence east along said line
620 feet to the North east
corner of Granters property.

Thence south 1235 feet
to the center of Township Road
number 178 and the point of
beginning containing 22.64 Ac.
more or less.

No Good
Deed nor Price nor does
it close. 3-22-74

Troy #5

15

WILLIAM A. LAVELLE
JOSEPH B. YANITY, JR.
L. ALAN GOLDSBERRY
CHARLES DAVID FREY
RONALD E. DEVEAU
RONALD J. WEISENBERGER
THOMAS S. HODSON

LAVELLE AND YANITY

ATTORNEYS AT LAW
THE SECURITY BUILDING
POST OFFICE BOX 661
ATHENS, OHIO 45701

TELEPHONE 592-6684
AREA CODE 614

March 21, 1974

Mr. Ernest Peters
County Engineers Office
555 E. State Street
Athens, Ohio 45701

Dear Mr. Peters:

Herewith enclosed is a copy of the plat and description which has been changed by the surveyor in the Poston-Reinhart deed for your files.

Also enclosed is a description in the Murphy real estate transaction for your approval and return to my office in the enclosed self-addressed stamped envelope.

Sincerely,

William A. Lavelle *m*

WAL:mjb

Encls.

16

Phone 740-753-1264
Fax 740-753-1264

Description of a 1.822 Acre Tract

Situated in Section 5, T-5, R-11, Troy Township, Athens County, State of Ohio and being a part of a tract as described in Volume 139, Page 361 of the Official Records of Athens County and being more particularly described as follows:

BEGINNING at a stone found on grantors most westerly south line and also the south line of section 5, said stone bears South 87°29'49"East, 73.05 feet from a stone found at the southwest corner of the southeast 1/4 of Section 5,

THENCE along grantors west line North 1°35'27"East, 149.34 feet to an iron pin set on the south right of way line of US RT 50,

THENCE along said line the following two courses;
North 78°06'10"East, 31.86 feet to a point, (a concrete monument found bears North 7°19'21"East, 0.76 feet from corner),
North 63°46'55"East, 254.07 feet to an iron pin set,

THENCE leaving said line along a new line South 34°11'34"East, 332.75 feet to an iron pin set on grantors south line, (passing an iron pin set at 167.75 feet),

THENCE along grantors south line North 89°05'29"West, 450.31 feet to the point of beginning and containing 1.822 acres.

This tract must remain continuous and contiguous with the tract immediately to the south.

Bearings are to an assumed meridian and are for angular determination only

Subject to all Easements and Rights of Way of record



Description checked for
Mathematical Accuracy
ATHENS COUNTY
ENGINEER'S OFFICE
BY: Kathy Carter
DATE: 4-25-08

Troy # 5
47



US RT 50

R/W

Dunfee
139-3610R

Conc. Monument found
bears N 7 19'21" E, 0.76'
from corner

1.822 Acres

R/W

Ellis
359-557

S 87°29'49"E
73.05'

N 1°35'27"E
149.34'

N 89°05'29"W
450.31'

Section 5
Section 4

S 34°11'34"E
332.75'

Line	Bearing	Distance
1	N 78°06'10"E	31.86'

S.W. corner of
the S.E. 1/4
of Sec. 5

Moore
378-45

NOTE: This is a
transfer between
adjoining owners

- = Iron Pin Set
- = Stone Found
- ⊕ = Conc. R/W Mon. Found

Scale 1"=100'



Description checked for
Professional Accuracy
ATHENS COUNTY
ENGINEER'S OFFICE
BY: Kerry Anthony
DATE: 4-25-02

PLAT OF SURVEY OF A 1.822 Ac. TRACT

SURVEYED FOR SCOTT MOORE

SUBDIVISION —

TOWNSHIP TROY SECTION 5 TOWN 5 RANGE 1

CORPORATION — COUNTY ATHENS STATE OHIO

SCALE 1"= 100 DATE APRIL 2002
Kenneth E. Highland
80 Fayette St.
Nelsonville, Ohio 45764
740-753-1264

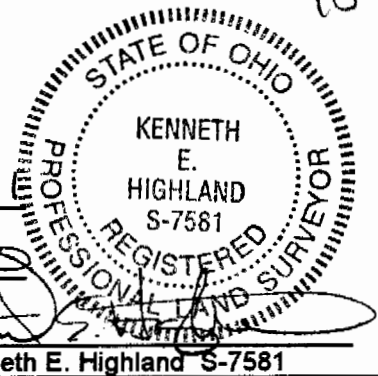

48

Kenneth E. Highland S-7581