

Phone 740-753-1264  
Fax 740-753-1264

**Description of a 5.545 Acre Tract**

Situated in Section 12, T-11, R-15, Waterloo Township, Athens County, State of Ohio and being a part of an 11.031 acre tract as described in Volume 191, Page 905 of the Official Records of Athens County and being more particularly described as follows:

BEGINNING at a stone found at the northwest corner of the southwest quarter of Section 12,

THENCE along grantors north line North 85°03'00"East, 992.70 feet to a railroad spike found in the center of SR-691,

THENCE along the center of said road the following two courses,  
South 17°55'00"West, 369.70 feet to a point,  
South 19°49'00"West, 97.14 feet to a point,

THENCE leaving said road and along a new line North 75°06'11"West, 435.85 feet to an iron pin set,

THENCE North 59°45'54"West, 487.45 feet to the point of beginning and containing 5.545 acres.

Bearings are to an assumed meridian and are for angular determination only

Subject to all Easements and Rights of Way of record

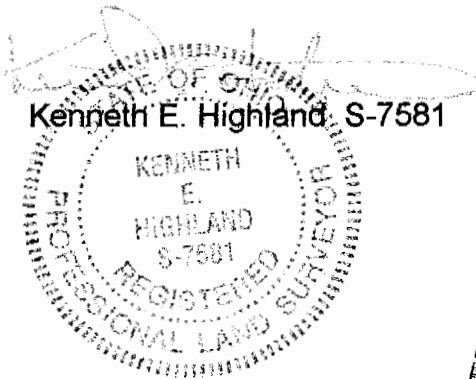

Description checked for  
Mathematical Accuracy  
ATHENS COUNTY  
ENGINEER'S OFFICE  
BY: S. Brauser  
DATE: 7-9-01

WAT #12



N.W. corner of the  
S.W. 1/4 of Section 12

Mash  
77-380 OR

N 85°03'00"E  
992.70'

5.545 Acres

N 59°45'54"W  
487.45'

Taylor  
191-905 OR

N 75°06'11"W  
435.85'

+ 36.49'  
S 19°49'00"W  
97.14'

S 17°55'00"W  
369.70'

SR-691

- = Iron Pin Set
- = Stone Found
- ▲ = Railroad Spike Found

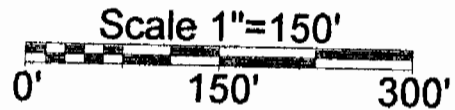

Description checked for  
Mathematical Accuracy  
ATHENS COUNTY  
ENGINEER'S OFFICE  
BY: S. Blaus  
DATE: 7-9-01

PLAT OF SURVEY OF A 5.545 AC. TRACT

SURVEYED FOR ANDY TAYLOR

SUBDIVISION —

TOWNSHIP WATERLOO SECTION 12 TOWN 11 RANGE 15

CORPORATION — COUNTY ATHENS STATE OHIO

SCALE 1"= 150' DATE JULY 2001

Kenneth E. Highland  
80 Fayette St.  
Nelsonville, Ohio 45764  
740-753-1264

Kenneth E. Highland S-7581

