

Phone 740-753-1264  
Fax 740-753-1264

**Description of an 11.035 Acre Tract**

Situated in Section 25, T-11, R-15, Waterloo Township, Athens County, State of Ohio and being a part of a tract as described in Volume 353, Page 903 of the Deed Records of Athens County and being more particularly described as follows:

BEGINNING at an iron pin set that bears South 1°15'37"West, 279.89 feet from the center of Section 25,  
THENCE South 1°15'37"West, 813.80 feet to an iron pin set,  
THENCE South 54°35'08"West, 121.88 feet to an iron pin found,  
THENCE North 41°42'29"West, 108.46 feet to a point,  
THENCE North 52°14'04"West, 153.08 feet to a point,  
THENCE South 73°19'11"West, 94.69 feet to a point,  
THENCE South 79°32'21"West, 135.20 feet to an iron pin found,  
THENCE North 70°49'49"West, 199.48 feet to a point,  
THENCE North 80°44'24"West, 125.89 feet to an iron pin found,  
THENCE North 80°44'25"West, 139.57 feet to a point in the center of SR-356,  
THENCE along the center of said road the following two courses,  
North 18°09'55"East, 121.12 feet to a point,  
North 19°07'30"East, 121.08 feet to a point,  
THENCE leaving said road North 69°32'23"East, 395.67 feet to an iron pin set, passing an iron pin set at 22.81 feet,  
THENCE North 44°19'05"East, 109.21 feet to an iron pin set,  
THENCE North 62°02'12"East, 136.17 feet to an iron pin set,  
THENCE North 76°14'43"East, 182.88 feet to an iron pin set,  
THENCE North 58°23'47"East, 190.37 feet to the point of beginning and containing 11.035 acres.

Bearings are to an assumed meridian and are for angular determination only

Subject to all Easements and Rights of Way of Record

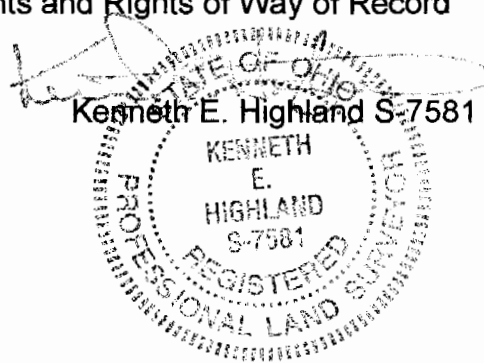

Description Checked for  
Mathematical Accuracy  
Athens County  
ENGINEER'S OFFICE  
BY: S. Blause  
DATE: 2-20-04

