

**Survey for
Joshua and Teresa Harris
0.460 Acres more or less**

Description Approved
Jill A. Thompson
Athens County Auditor

Situated in the State of Ohio, County of Athens, Township of Waterloo, Section 12, Township 11, Range 15 of the Ohio Company Purchase and being a part of the original 19.9036 acre tract (Parcel N01-00100683-03) as transferred to Michael P. Michael and Melissa M. Michael and recorded in the Official Record Book 302, Page 369 and being a part of the original 7.91 acre tract (Parcel N01-00100689-00) as conveyed to Joshua C. Harris and Teresa L. Phillips and recorded in Official Record Book 310, Page 1014 and being a part of the original 1.001 acre tract (Parcel N01-00100688-00) as conveyed to Joshua C. Harris and Teresa L. Phillips and recorded in Official Record Book 310, Page 1014 and being bounded and described as follows:

Beginning at a reference point taken to be at the northwest corner of Section 12, Waterloo Township;

thence, South 45 degrees 9 minutes 22 seconds East a distance of 2277.06 feet to a 5/8" iron pin set, taken to be in the westerly line of a 9.71 acre tract as conveyed to Joshua C. Harris and Teresa L. Phillips and recorded in Official Record Book 310, Page 1014 and being the principle Point of Beginning of this survey;

thence with a division line through said 19.9036 acre tract that this survey is a part for the next 2 calls:

1. North 30 degrees 4 minutes 10 seconds West a distance of 52.01 feet to an iron pin set; thence
2. North 5 degrees 42 minutes 13 seconds East a distance of 71.64 feet to an iron pin set, taken to be in the westerly line of said 9.71 acre tract;

thence with the westerly line of said 9.71 acre tract, North 9 degrees 15 minutes 0 seconds West a distance of 128.13 feet to an iron pin set;

thence with a division line through said 9.71 acre tract that this survey is a part for the next 2 calls:

1. North 85 degrees 0 minutes 7 seconds East a distance of 49.06 feet to an iron pin set; thence
2. South 9 degrees 16 minutes 4 seconds East a distance of 153.85 feet to an iron pin set in the easterly line of said 1.001 acre tract that this survey is a part, passing through the northerly line of said 1.001 acre tract that this survey is a part at a distance of 65.28 feet;

thence with a division line through said 9.71 acre tract that this survey is a part, South 36 degrees 4 minutes 41 seconds East a distance of 137.01 feet to a point in the centerline of State Route 691 (60 feet wide), taken to be the northerly line of a 1.070 acre tract as conveyed to Jessie L. and Shari N. Mash and recorded in Deed Volume 361, Page 251, passing an iron pin set at a distance of 118.07 feet;

thence with the centerline of said State Route 691, taken to be the northerly line of said 1.070 acre tract, South 57 degrees 25 minutes 52 seconds West a distance of 91.65 feet to a point;

thence leaving the centerline of said State Route 691 and with a division line through said 9.71 acre tract that this survey is a part, North 30 degrees 4 minutes 10 seconds West a distance of 74.94 feet to the Point of Beginning, passing an iron pin set at a distance of 23.47 feet and containing 0.460 acres more or less, being 0.025 acres more or less in (Parcel N01-00100683-03), being 0.021 acres more or less in (Parcel N01-00100688-00) and being 0.414 acres more or less in (Parcel N01-00100689-00) and subject to all legal rights-of way, restrictions, reservations, zoning regulations of record and easements of record.

Description Checked for
Mathematical Accuracy
Athens County
ENGINEER'S OFFICE
BY: S. Blaylock
DATE: 8-25-08

**Survey for
Joshua and Teresa Harris
0.460 Acres more or less**

All iron pins set are 5/8" steel rebar, 30 inches in length with an orange cap marked "Kinnison PS 8231".

All Deed Volumes and Official Record Books are referenced to the Athens County Recorder's Office unless otherwise noted.

Bearings are based upon the North 9 degree 15 minutes 0 seconds West line of a 19.9036 acre survey by L.F. Swayer of Official Record Book 302, Page 369 as conveyed to Michael P. Michael and Melissa M. Michael. All other bearings are from angles and distances as measured in the field. Bearings are based upon an assumed meridian and are used to denote angles only.

A survey of this property was completed in August 19, 2006 under the supervision of Michael A. Kinnison, Engineer and Surveyor, 406 East First Street, Wellston, Ohio. Registered Surveyor Number 8231.



A handwritten signature in black ink, appearing to read "M. Kinnison", written over a horizontal line.

Michael A. Kinnison, P.L.S. No. 8231

8/29/06

Date

***** End of Description *****

Kinnison Engineering Services
Michael A. Kinnison, P.E., P.S.
 406 East First Street
 Wellston, Ohio 45692
 Telephone: 740-384-6312

Note 1: Tract 1 to be transferred from Michael P. Michael and Melissa M. Michael to Joshua and Teresa Harris prior to any transfer of this tract.

LEGEND

○	5/8" Iron Pin Found, No Cap or Tag
○	5/8" Iron Pin Found, 30" in Length, Cap Stamped, "Kinnison P.S. 8231"
○	1/2" Iron Pin Found, No Cap or Tag
•	Point

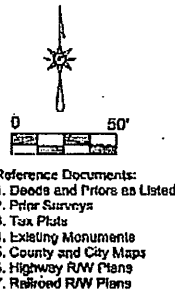

Joshua C. Harris and
 Teresa L. Phillips
 O.R. 0310/1014
 remainder of original
 9.71 Acres
 Parcel N01-00100688-00

Acreage Summary

Tract #	Parcel #	Volume/Page	Acreage
2	N01-00100688-00	0310/1014	0.414
3	N01-00100688-00	0310/1014	0.021
1	N01-00100683-03	0302/0369	0.025
Total			0.460 +/-

Michael P. Michael and
 Melissa M. Michael
 O.R. 0302/0369
 remainder of original
 19.9036 Acres
 Parcel N01-00100683-03

Northwest Corner of Section 12,
 Waterloo Township, Athens County

Joshua C. Harris and
 Teresa L. Phillips
 O.R. 0310/1014
 remainder of original
 1.001 Acres
 Parcel N01-00100688-00

9/2/06
 ok. to land in per
 Athens Co. Deed
 Done
 G. L. Kinnison

Michael P. Michael and
 Melissa M. Michael
 O.R. 0302/0369
 remainder of original
 19.9038 Acres
 Parcel N01-00100683-03

"Approved by the Athens
 County Regional Planning
 Commission; No plat
 Required"
 Planning Director

7-8-06
 Centerline of
 State Route 691
 (60 feet wide)

FILE NAME	PROJECT NO.	DATE	BY
0000000000	0000000000	08/29/2006	MAK
0000000000	0000000000	08/29/2006	MAK
0000000000	0000000000	08/29/2006	MAK

Description Checked for
 Mathematical Accuracy
 Athens County
 ENGINEER'S OFFICE
 BY: *[Signature]*
 DATE: 8-30-06

I hereby certify this to be a plat of a survey
 made under my direction in August, 2006.

Michael A. Kinnison, P.L.S. No. 8231

Date 8/29/06

Survey For:	Joshua and Teresa Harris
	0.460 Acres +/-
	Situated in the Northwest Quarter of Section 12, O.C.P., T-11, R-15, Waterloo Twp., Athens County, Ohio August 19, 2006

Bearings are based upon the N 9 Degrees 15 Minutes 0 Seconds W line of a 19.9038 Acre survey by L.F. Sawyer of Official Record Book 302, Page 369 as conveyed to Michael P. Michael and Melissa M. Michael. All other bearings are from angles and distances as measured in the field. Bearings are based upon an assumed meridian and are used to denote angles only.