

HAROLD D. ("DALE") WHALEY
REGISTERED SURVEYOR NO. 4986
ALBANY, OHIO
Lots, Farms, Subdivisions and Construction Staking
BIRGIE SIX

OK
1-1-72
15-22-67
23.07

Situated in the Northwest and Southwest Quarters of the Southeast Quarter of Section 6, T. 11, R. 15, Waterloo Township, Athens County, Ohio and being more particularly described as follows:

Commencing at the Southeast corner of the Southwest Quarter of the Southeast Quarter of Section 6, Thence along the West line of the Southwest Quarter of the Southeast Quarter of Section 6, N. 3° 15' E., 1,248.93 feet to an iron pin and the true point of beginning for the following described tract:

Thence S. 89° 34' 40" W., 210.4 feet to an iron pin;

Thence N. 2° 57' 20" W., 250.00 feet to an iron pin;

Thence N. 13° 24' 40" E., 117.55 feet to an iron pin;

Thence N. 47° 00' 40" E., 204.37 feet to a spike *Center line* *the center line of CR NO. 9*

Thence S. 71° 11' 20" E., 77.75 feet to a spike;

Thence S. 3° 15' W., 477.49 feet to an iron pin and the point of beginning, containing 2.320 acres, and being part of a 221.13 acre tract described in Vol. 199, Page 259 of the Athens County Deed Records.

Surveyed June 5, 1972 by HAROLD D. WHALEY

Harold D. Whaley
Reg. Surveyor No. 4986

M - 2500 - 1 yr
Wks 670 Act

5.30 wed

*used
W.M.H.*

PARTIAL Release - 1st NAT'L ST. NALS. 2hr

Barbara J. Lyons

S.P. - 3000 *NO BILLS*

M. - 221.13 AC TRACT

*LARRY D. LYONS -
251 Highland Ave
Athens Ohio*

*BIRGIE SIX
VIOLA SIX
Rt 12, Athens Ohio*

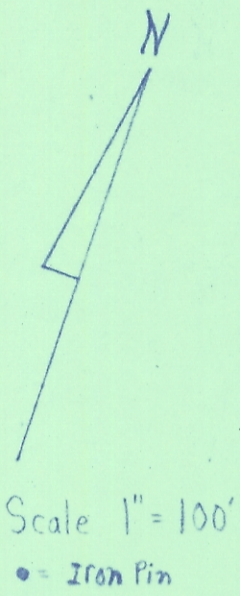

Doreas AND Okey Murphy
221-392

John and Anne Krivesti
209-357

Survey of a 2.320 acre tract in the Northwest AND Southwest
quarters of the Southeast quarter of section 6, t.11,
R.15, Waterloo township, Athens County, Ohio
for Birgie Six

Surveyed June 5, 1972
By Harold D. Whaley

Harold D. Whaley
Reg No 4986

200