

Phone 740-753-1264  
Fax 740-753-1264

**Description of a 8.198 Acre Tract**

Situated in the City of Nelsonville and being in Section 12, T-12, R-15, York Township, Athens County, State of Ohio and being a part of a tract as described in Volume 324, Page 905 of the Deed Records of Athens County and being more particularly described as follows:

BEGINNING at a PK Nail set in the center of a bridge over Monday Creek on CR-5 that bears South 90°00'00"East, 957.08 feet (calc. from deed), South 0°00'00"West, 1584.57 feet (calc. from deed), and South 79°19'27"West, 524.30 feet (calc. from deed) from the Northwest corner of Section 12,

THENCE along the center of CR-5 South 79°27'52"West, 473.65 feet to a point,

THENCE leaving said road North 0°46'17"East, 1101.67 feet to a point in the center of a creek, (passing an iron pin set at 16.45 feet,

THENCE along the center of said creek the following five courses:  
South 48°12'59"East, 290.33 feet to a point,  
South 36°46'54"East, 282.19 feet to a point,  
South 3°01'09"East, 103.57 feet to a point,  
South 0°12'04"West, 199.33 feet to a point,  
South 11°42'01"East, 298.96 feet to the point of beginning and containing 8.198 acres.

Bearings are to an assumed meridian and are for angular determination only

Subject to all Easements and Rights of Way of record

Kenneth E. Highland, S-7581



Description checked for  
Mathematical Accuracy  
ATHENS COUNTY  
ENGINEER'S OFFICE

By: R. Antle, Jr.  
DATE: 9/14/10

*Vol # 12*

**000044**

**HIGHLAND SURVEYING**  
Registered Professional Land Surveyor

N.W. corner of Section 12

S 90°00'00"E  
957.08" (Deed)

USA  
179-319

Scale 1"=200'

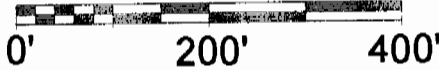

○ = Iron Pin Set

▲ = PK Nail Set

S 0°00'00"W  
1584.57" (Deed)

Sullivan  
324-905

N 0°46'17"E  
1101.67"

Sullivan  
324-905

Center of Creek

Sullivan  
324-905

**8.198  
Acres**

S 79°19'27"W  
524.30" (Deed)

0+ 16.45' S 79°27'52"W  
473.65"

CR-5

Description checked for  
Mathematical Accuracy  
ATHENS COUNTY  
ENGINEER'S OFFICE

*K. Canterbury*  
9/14/05

PLAT OF SURVEY OF A 8.198 Ac. TRACT

SURVEYED FOR MARK FIORELLO

SUBDIVISION -

TOWNSHIP YORK SECTION 12 TOWN 12 RANGE 15

CORPORATION Nelsonville COUNTY ATHENS STATE OHIO

SCALE 1"= 200' DATE Sept. 2000

Kenneth E. Highland  
80 Fayette St.  
Nelsonville, Ohio 45764  
740-753-1264

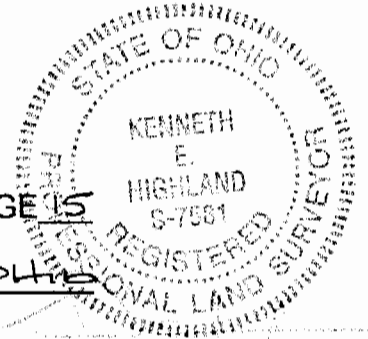

Kenneth E. Highland S-7581

**000045**