

JESSE SHANE
MASH, et al
117-572

CLIFFORD A. & ROBIN L.
WARREN
63-837
31.55AC.

S.E. COR.
SEC. 16

CLIFFORD A. & ROBIN L.
WARREN
63-837
31.55AC.

OHIO
MINING CO.
179-344

TOWNSHIP ROAD T-566

SURVEY OF A 5.01 ACRE TRACT
SEC. 16, T. 12, R. 15, YORK TWP.
ATHENS COUNTY, OHIO
SURVEYED SEPTEMBER 1996

JOHN M. BRANNER P.S. 6805
12500 N. PEACH RIDGE ROAD
ATHENS, OHIO 592-5778

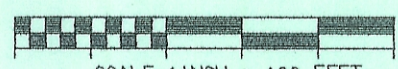
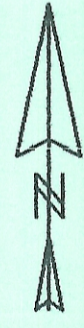
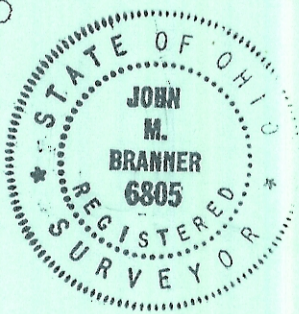

SCALE 1 INCH = 100 FEET

- IRON PIN FOUND
- IRON PIN SET

BEARINGS SHOWN HEREON
ARE BASED ON A SURVEY OF AN
6.07 ACRE TRACT AND ARE USED TO DENOTE
ANGLES ONLY

Description checked for
Mathematical Accuracy
ATHENS COUNTY
ENGINEER'S OFFICE
BY: *Donna McLean*
DATE: *11-6-96*