

1	2	3	4	5	6	7	8	9	10
11	12	13	14	15	16	17	18	19	20
21	22	23	24	25	26	27	28	29	30
31	32	33	34	35	36	37	38	39	40
41	42	43	44	45	46	47	48	49	50
51	52	53	54	55	56	57	58	59	60
61	62	63	64	65	66	67	68	69	70
71	72	73	74	75	76	77	78	79	80
81	82	83	84	85	86	87	88	89	90
91	92	93	94	95	96	97	98	99	100

3510
3511
3512
3513
3514
3515
3516
3517
3518
3519
3520

CITY OF ATHENS, O.

ATHENS COUNTY, OHIO.
ATHENS TOWNSHIP
T9N-R14W

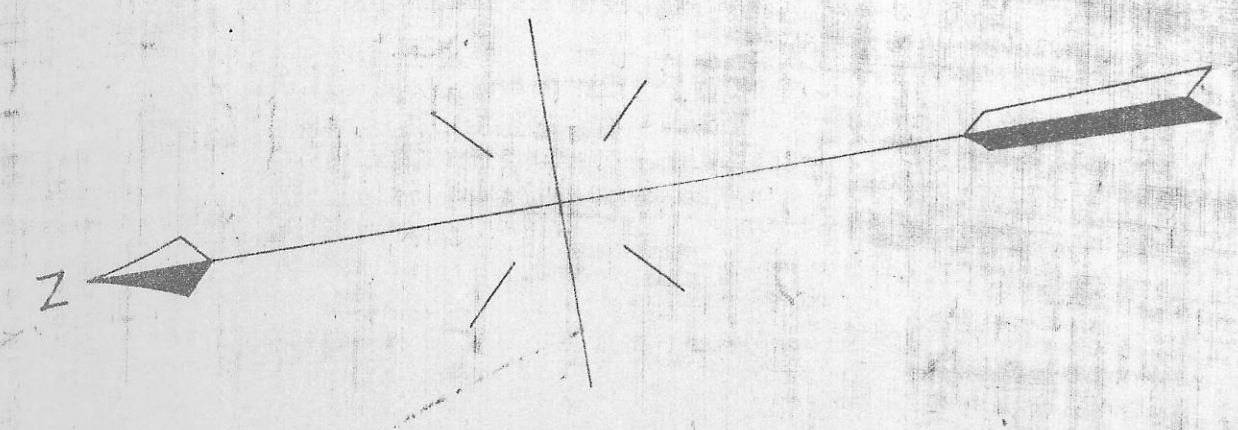

AUTHORITY	DATE INSTALLED OR RETIRED	DESCRIPTION
C 19 135 A.F.E. 2779	Retired June 20, 1922	A parcel of land containing 30,414 sq. ft. was conveyed to the City of Athens, Ohio, by deed dated March 28, 1921, located on the opposite side of the street from the parcel of land containing 28,715 sq. ft. And a parcel of land containing 28,715 sq. ft. was conveyed to the City of Athens, Ohio, by deed dated August 10, 1922, located on the opposite side of the street from the parcel of land containing 28,715 sq. ft. and 28,715 sq. ft.
C 2702 A.F.E. 5066	Installed Dec. 26, 1923	Construction of 4x24 frame car platform, with private interests, located on the addition to 105 1/2 x 50 ft. on the loading driveway located 45' on the west side of the Athens Cemetery. Also on the east side of the Athens Cemetery. Also on the east side of the Athens Cemetery. Also on the east side of the Athens Cemetery.
C 2807 A.F.E. 5054	Completed Sept. 8, 1925	Construction of 4x24 frame car platform, with private interests, located on the addition to 105 1/2 x 50 ft. on the loading driveway located 45' on the west side of the Athens Cemetery. Also on the east side of the Athens Cemetery. Also on the east side of the Athens Cemetery.
None Prepared	Completed July 1926	3-F Repair Shop, formerly located 60' to the west of the station, now located 145' to the west of the station 83 23' x 25'.
A.F.E. 1991 C-29105	Installed Oct. 18, 1923	Miscellaneous track and building changes at Athens, Ohio.
C 2915 A.F.E. 101	Completed Jan. 27, 1927	For description see Map 530.
C 3142 A.F.E. 1535	Installed Aug. 10, 1926	Columbus Oil Co's. track, station 83 23' x 64 1/2'.

CONTINUED ON REVERSE



NO.	REVISION	REFERENCE	DATE	BY
1	Initial	Station Construction	1922	J. H. ...
2	Removed	See Map 530	1922	J. H. ...

For Land Schedule see Sheet No. 310

STATION MAP
THE BALTIMORE AND OHIO RAILROAD COMPANY
OPERATED BY
THE BALTIMORE AND OHIO RAILROAD COMPANY
PHONENARK DIVISION
MAIN LINE
STATION 8289+60 TO STATION 8542+40
SCALE: 1 IN. = 100 FT.
JUNE 30, 1918
OFFICE OF VALUATION ENGINEER
BALTIMORE, MD.

Note: All overhead wires shown on the right hand side and all structures cut were measured from center-line of track.

I-CH-14.51 (S-31a)