

NO.	DATE	BY	REVISION
1	10-2-1918	J. E. Ewing	Original
2	10-2-1918	J. E. Ewing	As shown
3	10-2-1918	J. E. Ewing	As shown
4	10-2-1918	J. E. Ewing	As shown
5	10-2-1918	J. E. Ewing	As shown
6	10-2-1918	J. E. Ewing	As shown
7	10-2-1918	J. E. Ewing	As shown
8	10-2-1918	J. E. Ewing	As shown
9	10-2-1918	J. E. Ewing	As shown
10	10-2-1918	J. E. Ewing	As shown
11	10-2-1918	J. E. Ewing	As shown
12	10-2-1918	J. E. Ewing	As shown
13	10-2-1918	J. E. Ewing	As shown
14	10-2-1918	J. E. Ewing	As shown
15	10-2-1918	J. E. Ewing	As shown
16	10-2-1918	J. E. Ewing	As shown
17	10-2-1918	J. E. Ewing	As shown
18	10-2-1918	J. E. Ewing	As shown
19	10-2-1918	J. E. Ewing	As shown
20	10-2-1918	J. E. Ewing	As shown

BEAUMONT

M.M. Greene & Co.

HOCKING INC

RIVER

Buckeye Coal & Railway Co.

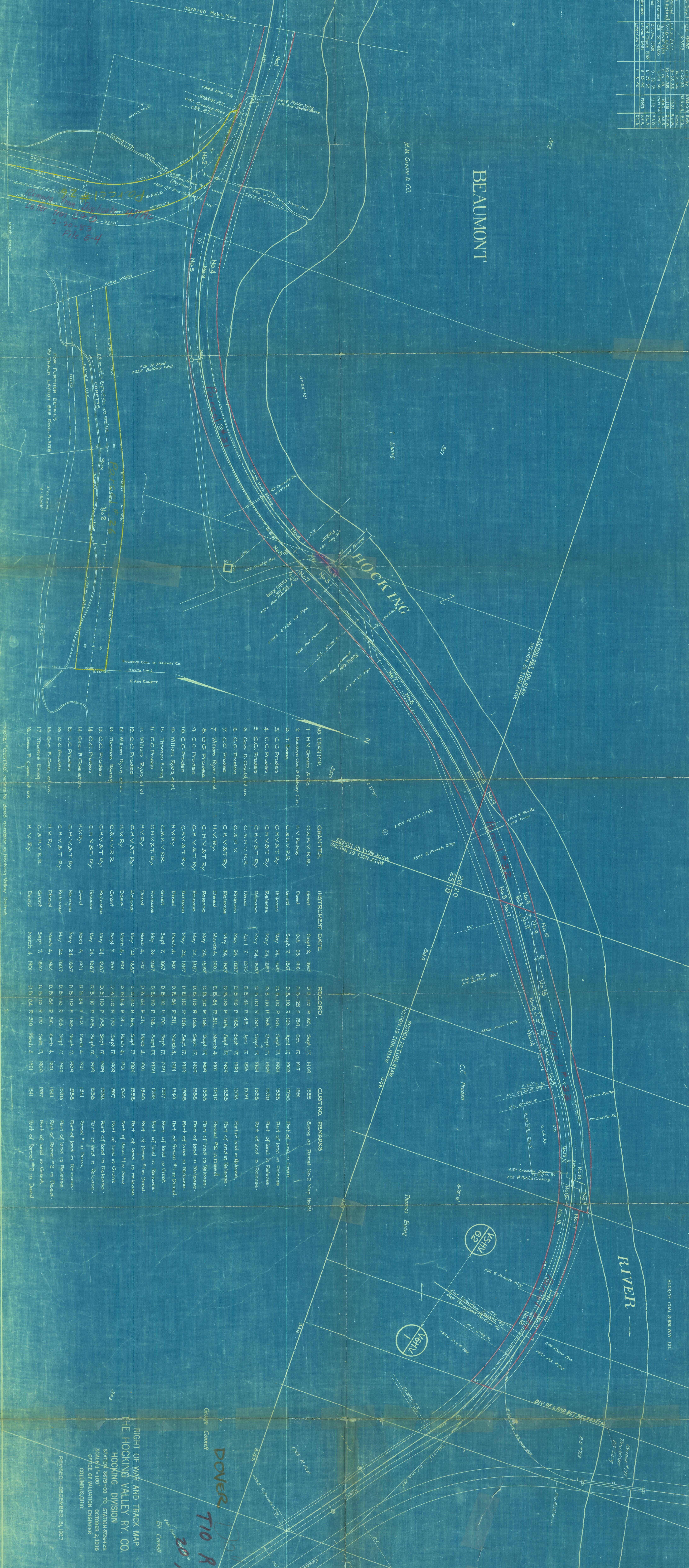

NO. GRANTEE	GRANTEE	INSTRUMENT DATE	RECORD	CUST. NO.	REMARKS
1	M.M. Greene & Co.	Sept. 2, 1867	D. B. 110 P. 105, Sept. 17, 1909	1535	Same as Parcel No. 2, Map No. 1
2	Buckeye Coal & Railway Co.	Oct. 23, 1916	D. B. 125 P. 159, Oct. 17, 1917	1531	Part of land in Grant
3	T. Ewing	Sept. 7, 1867	D. B. 110 P. 156, April 17, 1909	1536	Part of land in Release
4	C.C. Prudden	May 24, 1867	D. B. 110 P. 165, Sept. 17, 1909	1538	Part of land in Release
5	C.C. Prudden	May 24, 1867	D. B. 110 P. 168, Sept. 17, 1909	1538	Part of land in Release
6	C.C. Prudden	May 24, 1867	D. B. 110 P. 168, Sept. 17, 1909	1538	Part of land in Release
7	William Ryan, et al.	March 4, 1901	D. B. 84 P. 511, March 4, 1901	1540	Part of land in Release
8	C.C. Prudden	May 24, 1867	D. B. 110 P. 168, Sept. 17, 1909	1538	Part of land in Release
9	C.C. Prudden	May 24, 1867	D. B. 110 P. 168, Sept. 17, 1909	1538	Part of land in Release
10	William Ryan, et al.	March 4, 1901	D. B. 84 P. 511, March 4, 1901	1540	Part of land in Release
11	Thomas Ewing	Sept. 7, 1867	D. B. 110 P. 170, Sept. 17, 1909	1537	Part of land in Grant
12	C.C. Prudden	May 24, 1867	D. B. 110 P. 168, Sept. 17, 1909	1538	Part of land in Release
13	William Ryan, et al.	March 4, 1901	D. B. 84 P. 511, March 4, 1901	1540	Part of land in Release
14	C.C. Prudden	May 24, 1867	D. B. 110 P. 168, Sept. 17, 1909	1538	Part of land in Release
15	C.C. Prudden	May 24, 1867	D. B. 110 P. 168, Sept. 17, 1909	1538	Part of land in Release
16	C.C. Prudden	May 24, 1867	D. B. 110 P. 168, Sept. 17, 1909	1538	Part of land in Release
17	Thomas Ewing	Sept. 7, 1867	D. B. 110 P. 170, Sept. 17, 1909	1537	Part of land in Grant
18	C.C. Prudden	March 4, 1901	D. B. 84 P. 510, March 4, 1901	1541	Part of parcel #2 in Deed

RIGHT OF WAY AND TRACK MAP
 THE HOCKING VALLEY RY. CO.
 HOCKING DIVISION
 STATION 389+00 TO STATION 376+25
 SCALE 1" = 100'
 OFFICE OF VALUATION ENGINEER
 COLUMBUS, OHIO

REvised - DECEMBER 31, 1927

DOVER T10 R11XW
 20.19

DOVER 19 20 25 30 VS-HV 04

