

AUTHORITY	DATE INSTALLED OR RETIRED	DESCRIPTION
C 19235 A.F.E. 2911	Installed Oct. 15, 1921.	Construction of track 544E L-703 ft to serve Caloric Coal Co. at Carbondale, P.S. of east end of station 218+65.
C 21174 A.F.E. 4431	Retired June 1, 1922	Removal of Xover 546A(1), L=162' including one No. 7 and one No. 8 turnout was between main track and T-546A(1) with P.S. in main track of station 216+47.6. Entirely owned by Railroad Co., served Carbondale Mine No. 2.
C 21279 A.F.E. 4494	Retired July 2, 1923	Removal of tracks 546B(1) and 546B(2), 1685' and 763' in length including 2 No. 7 and 2 No. 8 turnouts, each P.S. of T-546B(2) was to T-546B(1) opposite station 215+04.1, east P.S. of T-546B(1) was at station 207+05.7. Tracks served Carbondale Mine No. 3, and were owned by Railroad Co.
C 20356 A.F.E. 4247	Installed Oct. 16, 1923.	Bridge No. 426A, east B.W. of station 213+81.5, a Rail Top Bridge was replaced with a timber trestle. See also Sheet No. 1 of 2.
C 31288 A.F.E. 19637	Completed Nov. 6, 1926	Renewal of Bridge No. 427A, station 256+55.5.
C 32015 A.F.E. 14591	Completed Dec. 26, 1928	Relocate Grade Crossing State Road No. 56, station 213+83.0.

ATHENS CO. OHIO  
WATERLOO TWP  
T 11 R. 15

ATHENS CO. OHIO  
YORK TWP  
T. 12 R. 15

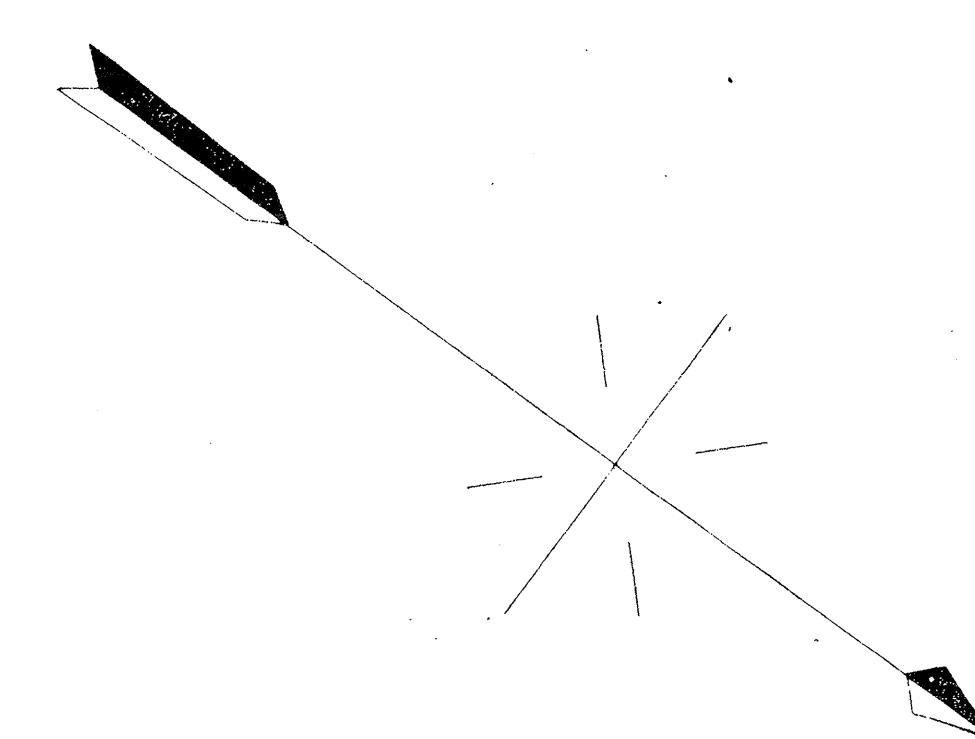
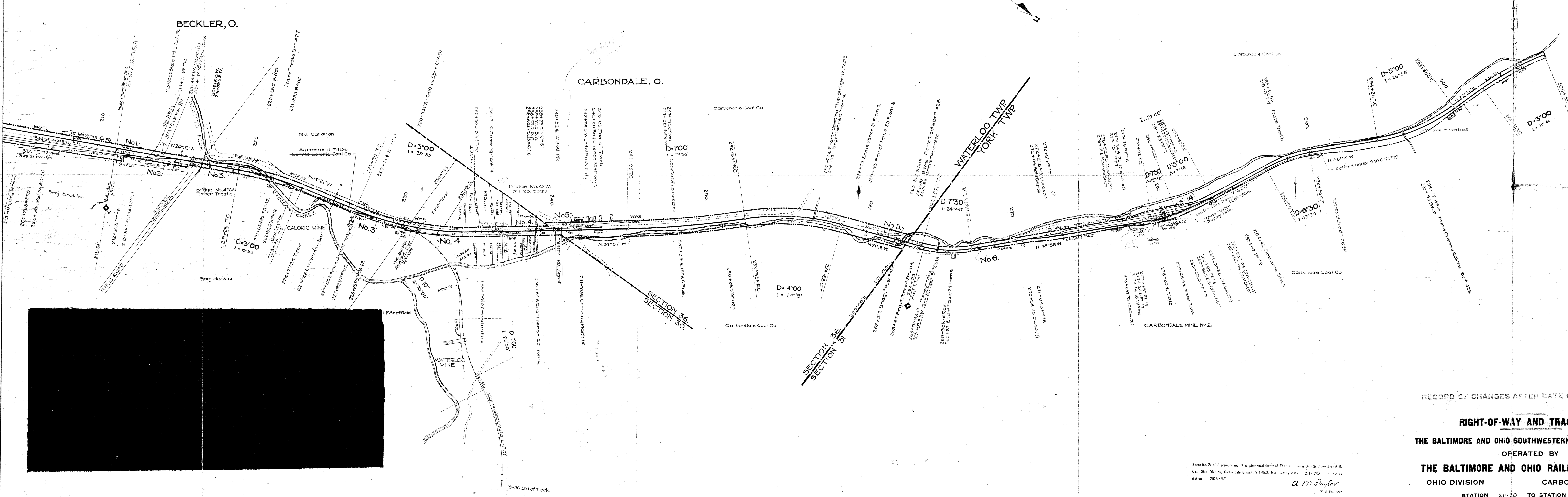

REVISED
17
18
19
20
21
22
23
24
25

RECORD OF CHANGES AFTER DATE OF VALUATION

RIGHT-OF-WAY AND TRACK MAP

THE BALTIMORE AND OHIO SOUTHWESTERN RAILROAD COMPANY

OPERATED BY

THE BALTIMORE AND OHIO RAILROAD COMPANY

OHIO DIVISION

CARBONDALE BRANCH

STATION 211+20 TO STATION 306+32

SCALE: 1 IN. = 200 FT. JUNE 30, 1918

OFFICE OF VALUATION ENGINEER  
BALTIMORE, MD.

Sheet No. 3 of 3 primary and 0 supplemental sheets of The Baltimore & Ohio S. W. R. Co., Ohio Division, Carbondale Branch, V. 145.2, from survey station 211+20 to survey station 306+32.  
*A. M. J. Miller*  
Past Engineer

Note: All chaining was done on the right hand rail and all distances out were measured