

THIS PLAN IS PRESUMED TO BE CORRECT, BUT IS NOT WARRANTED UNLESS CHECKED AND APPROVED FOR PROPERTY LINES

ATHENS CO OHIO
WATERLOO TWP
T. II R. 15

AUTHORITY	DATE INSTALLED OR RETIRED	DESCRIPTION
C 18767 AFE 2157	Installed April 26, 1921.	Construction of track 5A1 L-440 ft to serve Wm Shingler of Mineral, Ohio. P.O. of east end of station 56+88.5.
C 20336 AFE 4247	Installed Oct 16, 1923.	Reconstruction of Timber Trestle Bridge No. 414, at sta. 22+57.9 B.W., 415 at sta. 29+22.1 B.W., 416 at sta. 57+28.2 B.W., 417 at sta. 80+55.6 B.W., 418 at sta. 84+68.4 B.W., 419 at sta. 92+14.8 B.W., and center span of each bridge replaced with new steel I-beam. See also sheets 2 and 3 this section.

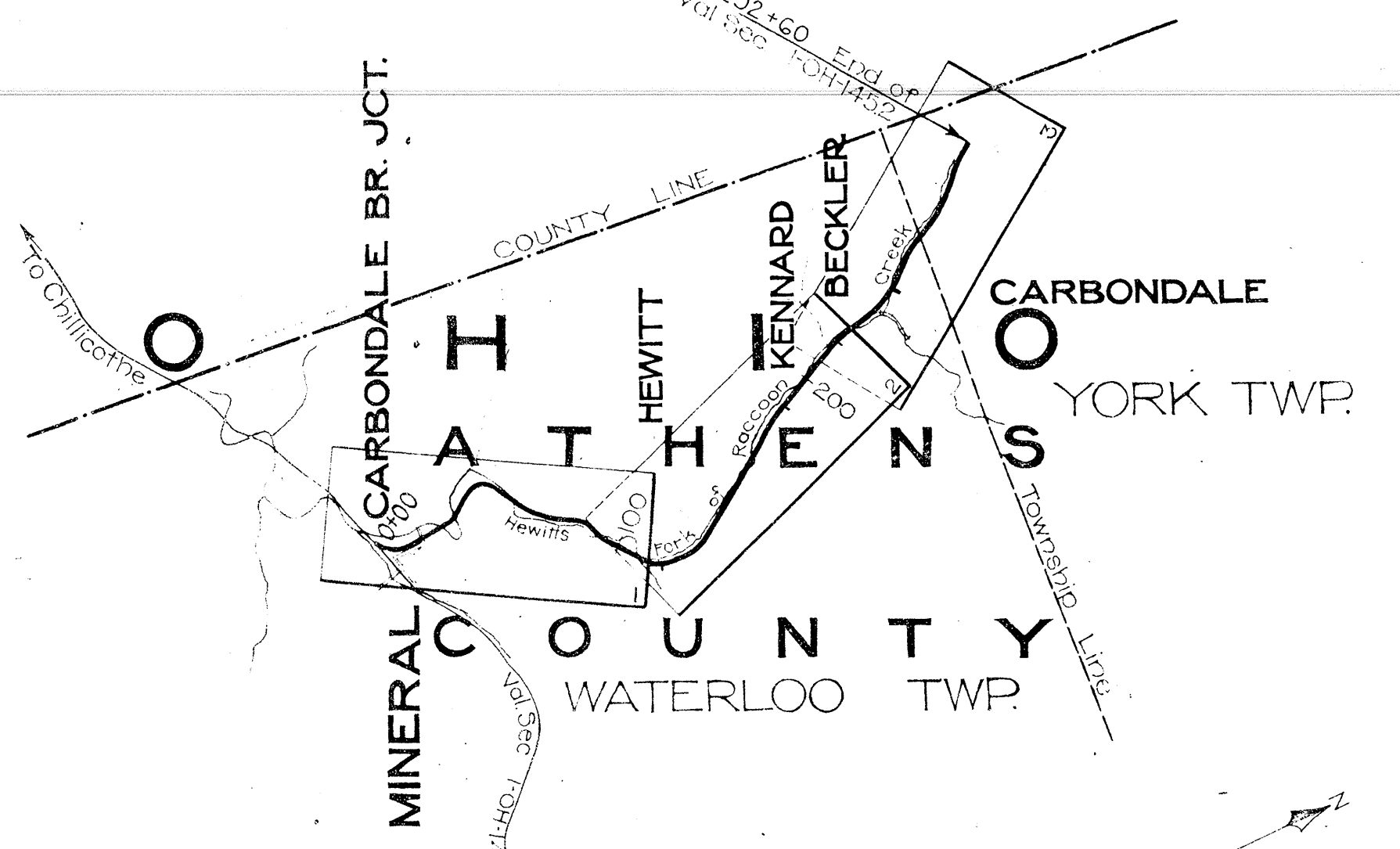

INDEX
Scale 1 in. = 5208 ft.

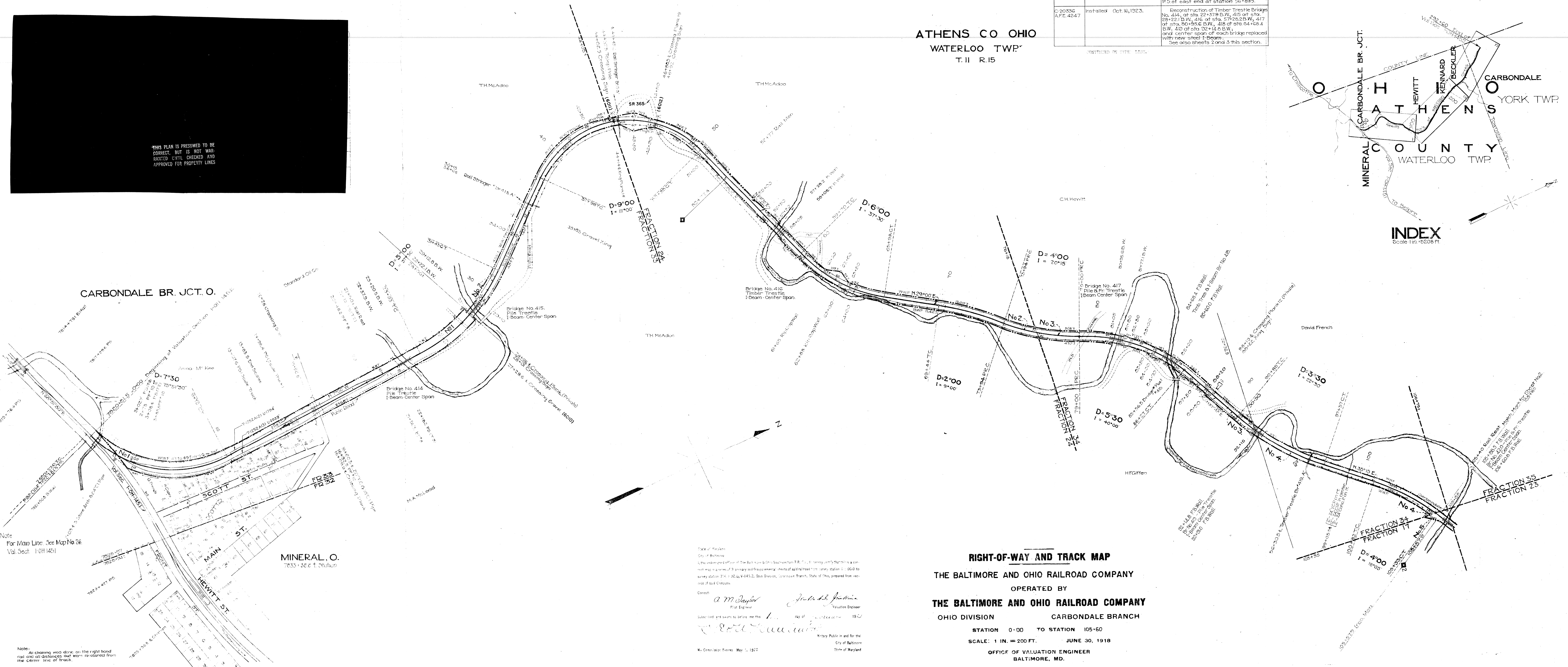

Note
For Main Line. See Map No 26
Vol. Sect. 1 OH 1451

Note
All chaining was done on the right hand rail and all distances that were measured from the center line of track.

State of Maryland
City of Baltimore
I, the undersigned Engineer of the Baltimore & Ohio System R.R., do hereby certify that this is a correct map in accordance with the provisions of the Act of the General Assembly of the State of Maryland, passed on the 14th day of March, 1888, and amended by the Act of the General Assembly of the State of Maryland, passed on the 14th day of March, 1892, and the Act of the General Assembly of the State of Maryland, passed on the 14th day of March, 1902, and the Act of the General Assembly of the State of Maryland, passed on the 14th day of March, 1912, and the Act of the General Assembly of the State of Maryland, passed on the 14th day of March, 1918, and the Act of the General Assembly of the State of Maryland, passed on the 14th day of March, 1922, and the Act of the General Assembly of the State of Maryland, passed on the 14th day of March, 1926, and the Act of the General Assembly of the State of Maryland, passed on the 14th day of March, 1930, and the Act of the General Assembly of the State of Maryland, passed on the 14th day of March, 1934, and the Act of the General Assembly of the State of Maryland, passed on the 14th day of March, 1938, and the Act of the General Assembly of the State of Maryland, passed on the 14th day of March, 1942, and the Act of the General Assembly of the State of Maryland, passed on the 14th day of March, 1946, and the Act of the General Assembly of the State of Maryland, passed on the 14th day of March, 1950, and the Act of the General Assembly of the State of Maryland, passed on the 14th day of March, 1954, and the Act of the General Assembly of the State of Maryland, passed on the 14th day of March, 1958, and the Act of the General Assembly of the State of Maryland, passed on the 14th day of March, 1962, and the Act of the General Assembly of the State of Maryland, passed on the 14th day of March, 1966, and the Act of the General Assembly of the State of Maryland, passed on the 14th day of March, 1970, and the Act of the General Assembly of the State of Maryland, passed on the 14th day of March, 1974, and the Act of the General Assembly of the State of Maryland, passed on the 14th day of March, 1978, and the Act of the General Assembly of the State of Maryland, passed on the 14th day of March, 1982, and the Act of the General Assembly of the State of Maryland, passed on the 14th day of March, 1986, and the Act of the General Assembly of the State of Maryland, passed on the 14th day of March, 1990, and the Act of the General Assembly of the State of Maryland, passed on the 14th day of March, 1994, and the Act of the General Assembly of the State of Maryland, passed on the 14th day of March, 1998, and the Act of the General Assembly of the State of Maryland, passed on the 14th day of March, 2002, and the Act of the General Assembly of the State of Maryland, passed on the 14th day of March, 2006, and the Act of the General Assembly of the State of Maryland, passed on the 14th day of March, 2010, and the Act of the General Assembly of the State of Maryland, passed on the 14th day of March, 2014, and the Act of the General Assembly of the State of Maryland, passed on the 14th day of March, 2018, and the Act of the General Assembly of the State of Maryland, passed on the 14th day of March, 2022.

RIGHT-OF-WAY AND TRACK MAP
THE BALTIMORE AND OHIO RAILROAD COMPANY
OPERATED BY
THE BALTIMORE AND OHIO RAILROAD COMPANY
OHIO DIVISION CARBONDALE BRANCH
STATION 0+00 TO STATION 105+60
SCALE: 1 IN. = 200 FT. JUNE 30, 1918
OFFICE OF VALUATION ENGINEER
BALTIMORE, MD.

REVISED TO
July 16 1923
Sept 14 1924
Sept 28 1925
Dec 29 1927
June 1 1945
June 1 1945
Oct 1 1953
Feb 16 1952
Oct 20 1955
Jan 7 1955

VI45.2
1
ME 6-2-1-18