

# TRIMBLE TWP. - SEC. 11. - TOWN, 11 - RANGE, 14.

SCALE 20 RODS = 1 IN.

SEC 18 SEC 12 SEC 6  
SEC 17 SEC 5

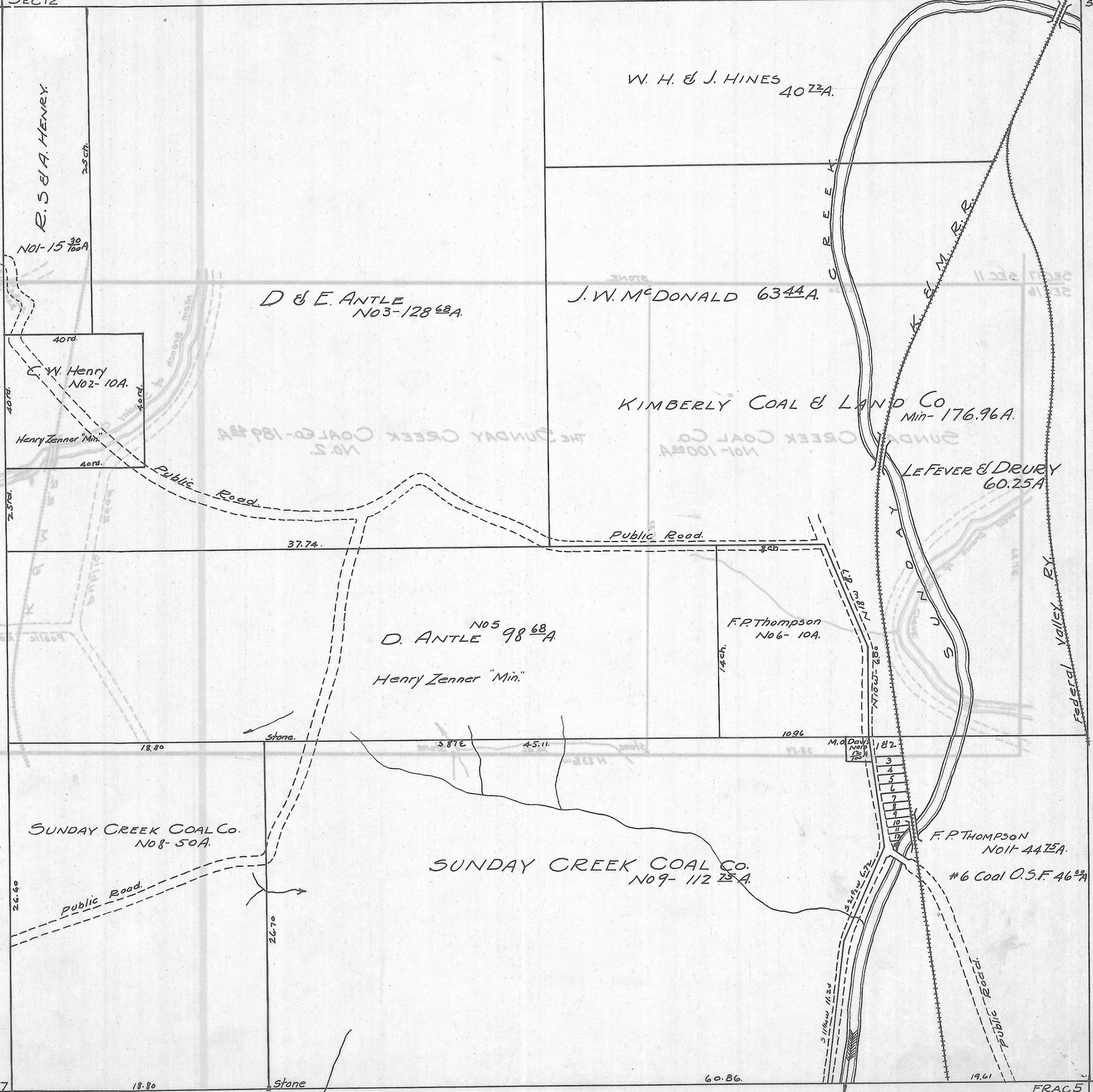

R.S. & A. HENRY  
NO1-15<sup>30</sup>/<sub>100</sub>A

W. H. & J. HINES  
40<sup>72</sup>A.

D & E. ANTLE  
NO3-128<sup>68</sup>A.

J.W. McDONALD 63<sup>44</sup>A.

KIMBERLY COAL & LAND CO  
Min-176.96A.

LEFEVER & DRURY  
60.25A

NO5  
D. ANTLE 98<sup>68</sup>A  
Henry Zenner "Min."

F.P. Thompson  
No6-10A.

SUNDAY CREEK COAL CO.  
NO8-50A.

SUNDAY CREEK COAL CO.  
NO9-112<sup>75</sup>A.

F.P. THOMPSON  
NO11-44<sup>75</sup>A.

#6 Coal O.S.F. 46<sup>92</sup>A

SEC 17 SEC 16 FRAC.5 18.80 Stone 60.86 19.61 SEC.5 SEC.4