

TRIMBLE TWP. - SEC. 31 - TOWN, 11 - RANGE, 14

SCALE 20 RODS = 1 IN.

C.L. Poston, et al.
No. 1-80⁰⁰ A

Sunday Creek Co.
No. 2-40⁰⁰ A

Buckingham & Wright.
No. 4-280⁰⁰ A.

New York Coal Co.
No. 5-267⁰⁰ A.

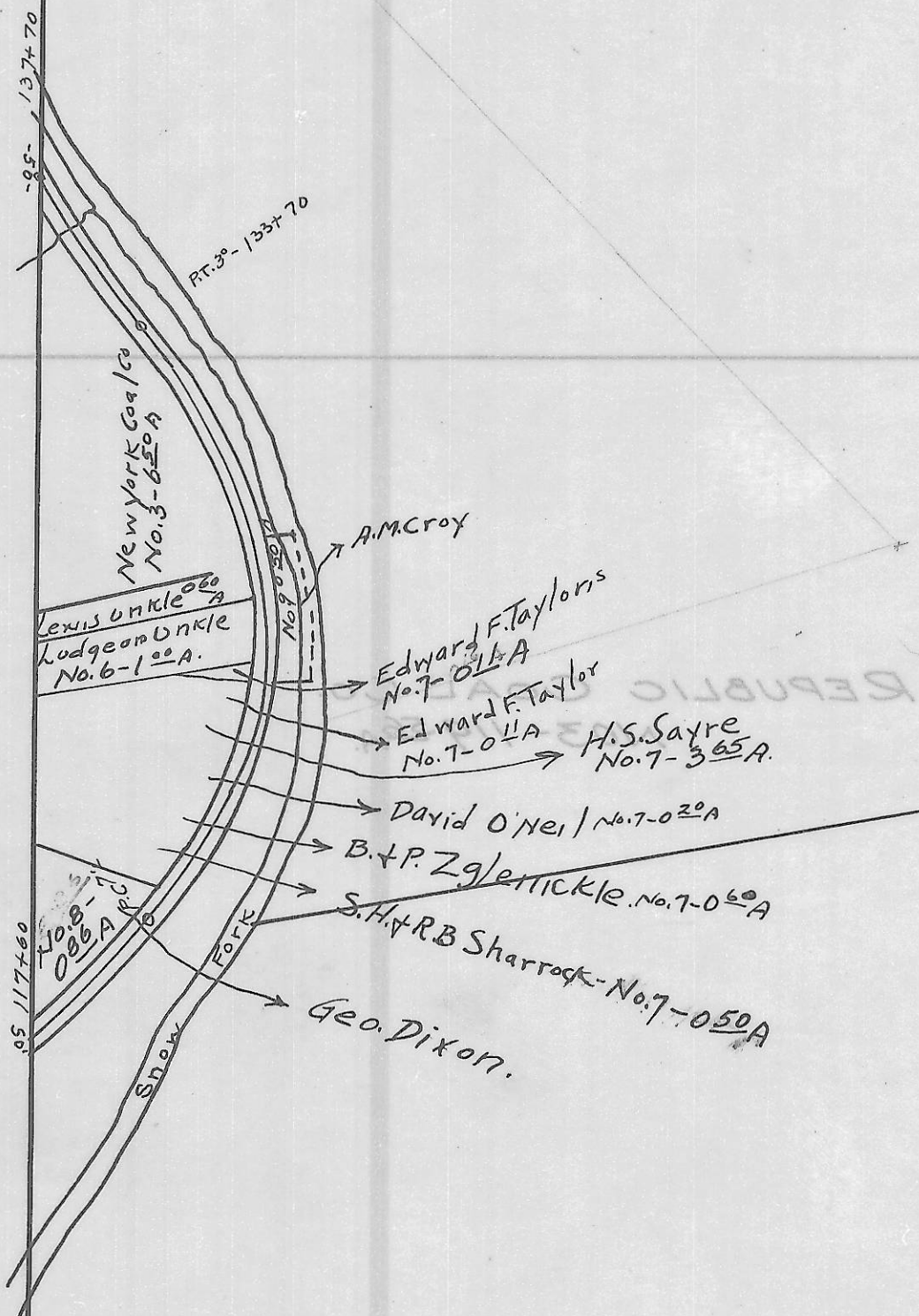

1244A-501

ELLA BURK ET AL

101-3225A

SUNDAY CREEK COAL CO

REPUBLIC COAL CO

104-321A

20.00

20.00

25.70

9.25

40.00

1000

1374.70

PT. 3°-1334.70

New York Coal Co
No. 3-650 A

Lewis Dinkle
Lodgeon Dinkle
No. 6-100 A

A.M. Crox

Edward F. Taylor
No. 7-010 A

Edward F. Taylor
No. 7-011 A

H.S. Sayre
No. 7-365 A

David O'Neil
No. 7-020 A

B. & P. Zglettick
No. 7-060 A

S.H. & R.B. Sharrock
No. 7-050 A

Geo. Dixon.

1174.60

No. 8-080 A

Creek

S.D.W.