

BERN TWP — SEC. 33 — TOWN, 7 — RANGE, 12.

20 Rods = 1 in.

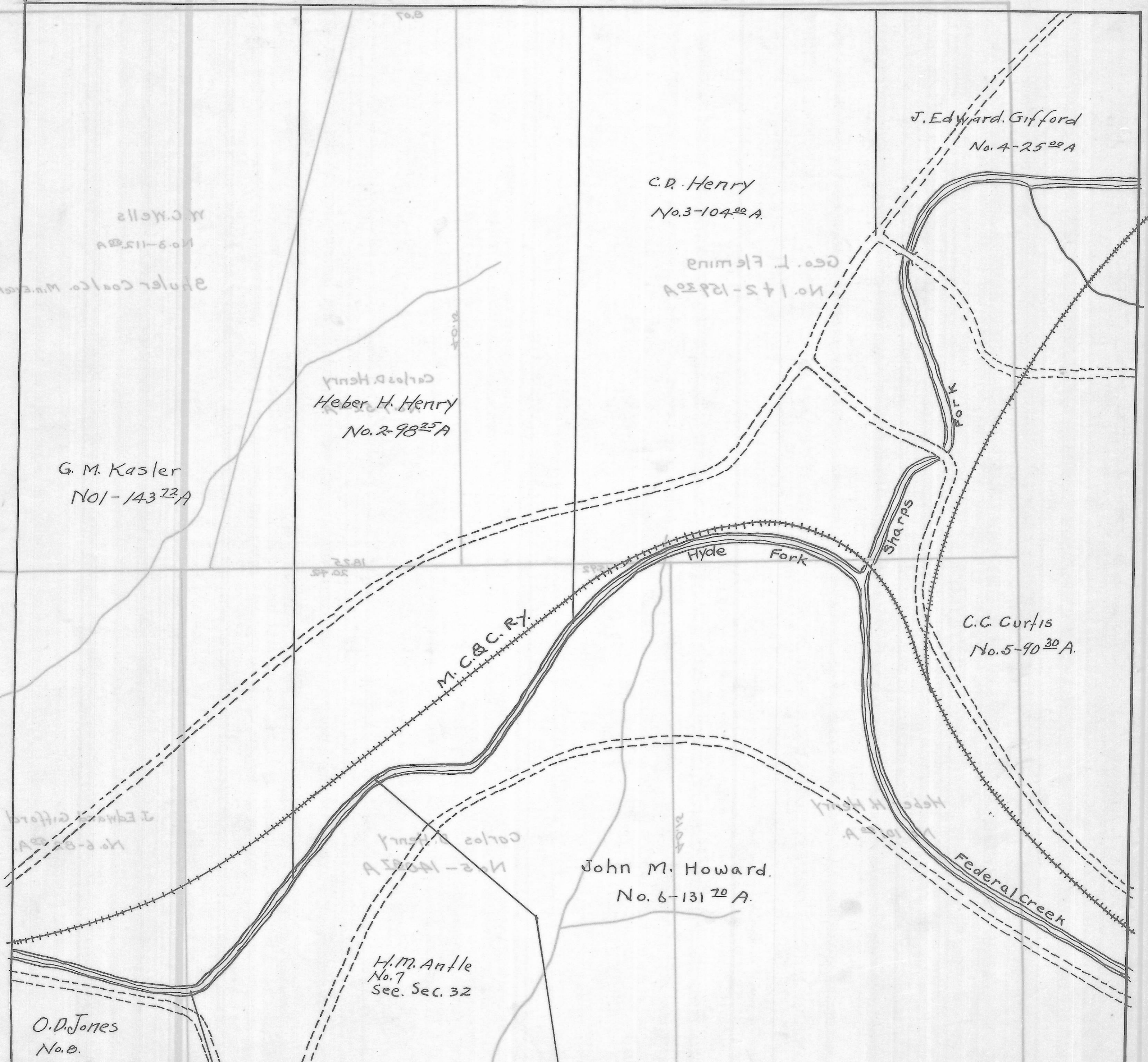

G. M. Kasler
No. 1-143²³A

Heber H. Henry
No. 2-98²⁵A

C. D. Henry
No. 3-104²⁰A

J. Edward Gifford
No. 4-25²⁰A

C. C. Curtis
No. 5-90³⁰A

John M. Howard
No. 6-131²⁰A

H. M. Antle
No. 7
Sec. Sec. 32

O. D. Jones
No. 8.

M. C. B. C. RT.

Hyde Fork

Sharps

Federal Creek