

DOVER TWP. ~ SEC. 4 ~ TOWN, 10 - RANGE, 14.

20 Rod = 1 in

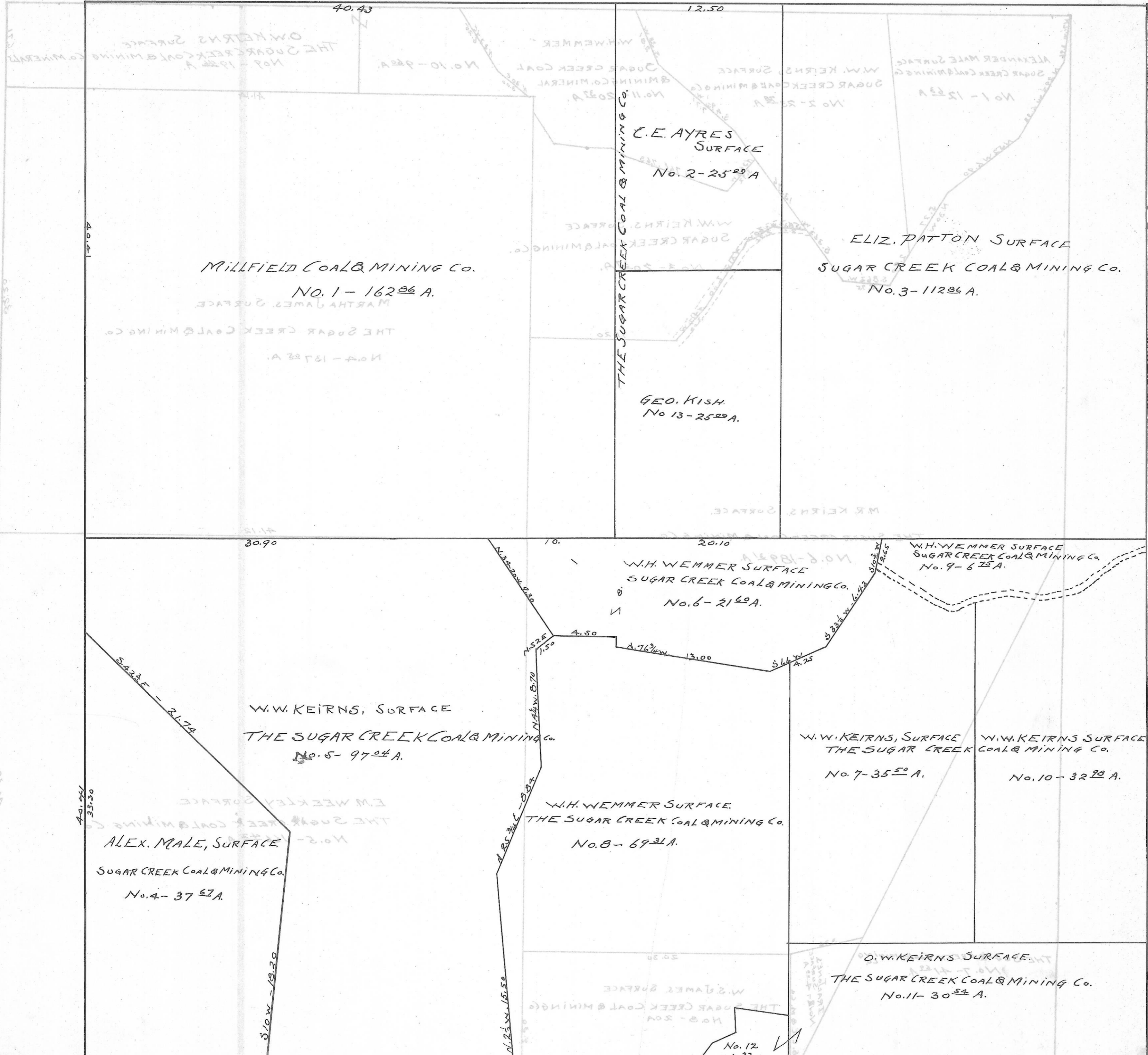

MILLFIELD COAL & MINING CO.  
NO. 1 - 16206 A.

C.E. AYRES SURFACE  
NO. 2 - 2500 A

ELIZ. PATTON SURFACE  
SUGAR CREEK COAL & MINING CO.  
NO. 3 - 11206 A.

GEO. KISH.  
NO. 13 - 2500 A.

W.H. WEMMER SURFACE  
SUGAR CREEK COAL & MINING CO.  
NO. 6 - 2160 A.

W.H. WEMMER SURFACE  
SUGAR CREEK COAL & MINING CO.  
NO. 9 - 675 A.

W.W. KEIRNS, SURFACE  
THE SUGAR CREEK COAL & MINING CO.  
NO. 5 - 9704 A.

W.W. KEIRNS, SURFACE THE SUGAR CREEK COAL & MINING CO.  
NO. 7 - 3550 A.

W.W. KEIRNS SURFACE  
THE SUGAR CREEK COAL & MINING CO.  
NO. 10 - 3290 A.

ALEX. MALE, SURFACE  
SUGAR CREEK COAL & MINING CO.  
NO. 4 - 3767 A.

W.H. WEMMER SURFACE  
THE SUGAR CREEK COAL & MINING CO.  
NO. 8 - 6931 A.

O.W. KEIRNS SURFACE  
THE SUGAR CREEK COAL & MINING CO.  
NO. 11 - 3054 A.

NO. 12  
23 A.