

YORK TWP. - SEC. 14 - TOWN, 12 - RANGE, 15.

Scale 20 Feet = 1 inch

No 2-54⁴⁷A
D R POSTON

FRAC. 1.
SUNDAY CREEK COAL Co.
"Sec. Sec. 15"

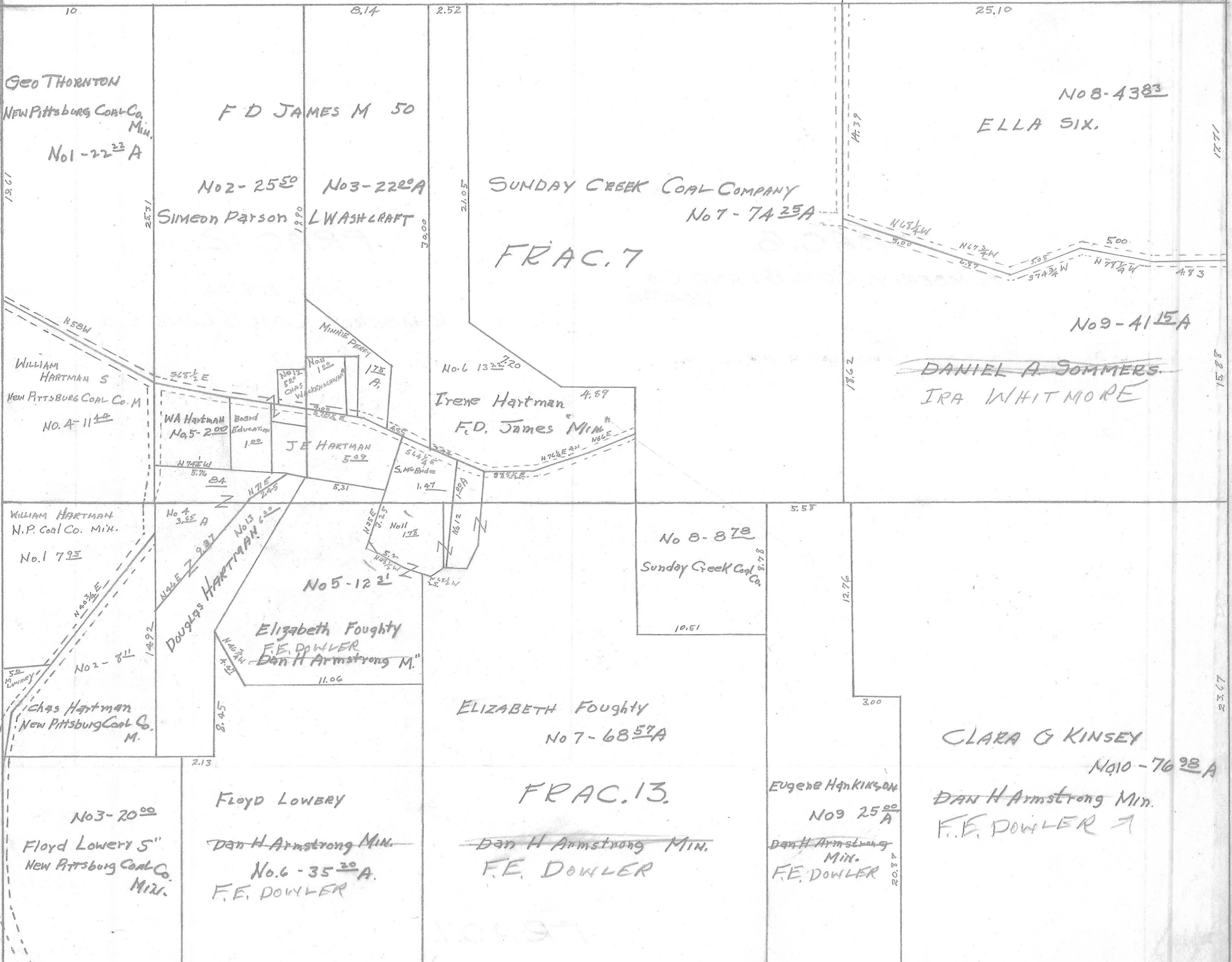

Geo THORNTON
New Pittsburg Coal Co. Min.
No 1-22²³A

F D JAMES M 50

No 8-438³
ELLA SIX.

No 2-25⁵⁰
SIMEON PARSON

No 3-22²⁰A
L WASH CRAFT

SUNDAY CREEK COAL COMPANY
No 7-74²⁵A
FRAC. 7

No 9-41¹⁵A
~~DANIEL A. SOMMERS~~
IRA WHITMORE

WILLIAM HARTMAN S
New Pittsburg Coal Co. M.
No. 4-11¹⁴

WA Hartman
No 5-2⁰⁰
Board Education

J E HARTMAN
5.09

Irene Hartman 4.89
F. D. James Min.
No 6-13²⁰

WILLIAM HARTMAN
N.P. Coal Co. Min.
No. 1 7²⁵

No 4-3⁴⁵A

No 5-12²¹
Elizabeth Foughty
F.E. DOWLER
Dan H. Armstrong M.
11.06

No 8-87⁸
Sunday Creek Coal Co.
10.51

Chas Hartman
New Pittsburg Coal Co. M.

Douglas HARTMAN
No 13

ELIZABETH Foughty
No 7-68⁵⁴A

CLARA G KINSEY
No 10-76³⁸A

No 3-20⁰⁰
Floyd Lowery S"
New Pittsburg Coal Co. Min.

FLOYD LOWERY
Dan H. Armstrong Min.
No 6-35³⁰A
F.E. DOWLER

FRAC. 13.
~~Dan H. Armstrong Min.~~
F.E. DOWLER

Eugene Hankinson
No 9 25⁰⁰A
Dan H. Armstrong
Min.
F.E. DOWLER

DAN H. ARMSTRONG Min.
F.E. DOWLER