

No 414 } Plat & Notes of a Subdivision  
of in-lots Nos 26 27 & 28 in the town  
of ALBANY

Subdivision No 1 Begins N 28° E 30 links  
from the S.W. corner of in-lot  
No 26 Thence N 28° E 91 Thence  
S 62° E 2.75 Thence S 28° W 91 Thence  
N 62° W 2.75 to the place of beginning  
Containing 250 A

Subdivision No 2 Begins at the N.W. corner  
of No 1 Thence S 62° E 2.75 Thence  
S 28° W 91 Thence S 62° E to the  
E line of Lot No 28 Thence  
N 45° E 1.93 Thence N 62° W 3.31  
Thence S 28° W 82 links to the place  
of beginning con<sup>5</sup> 40  
100 A

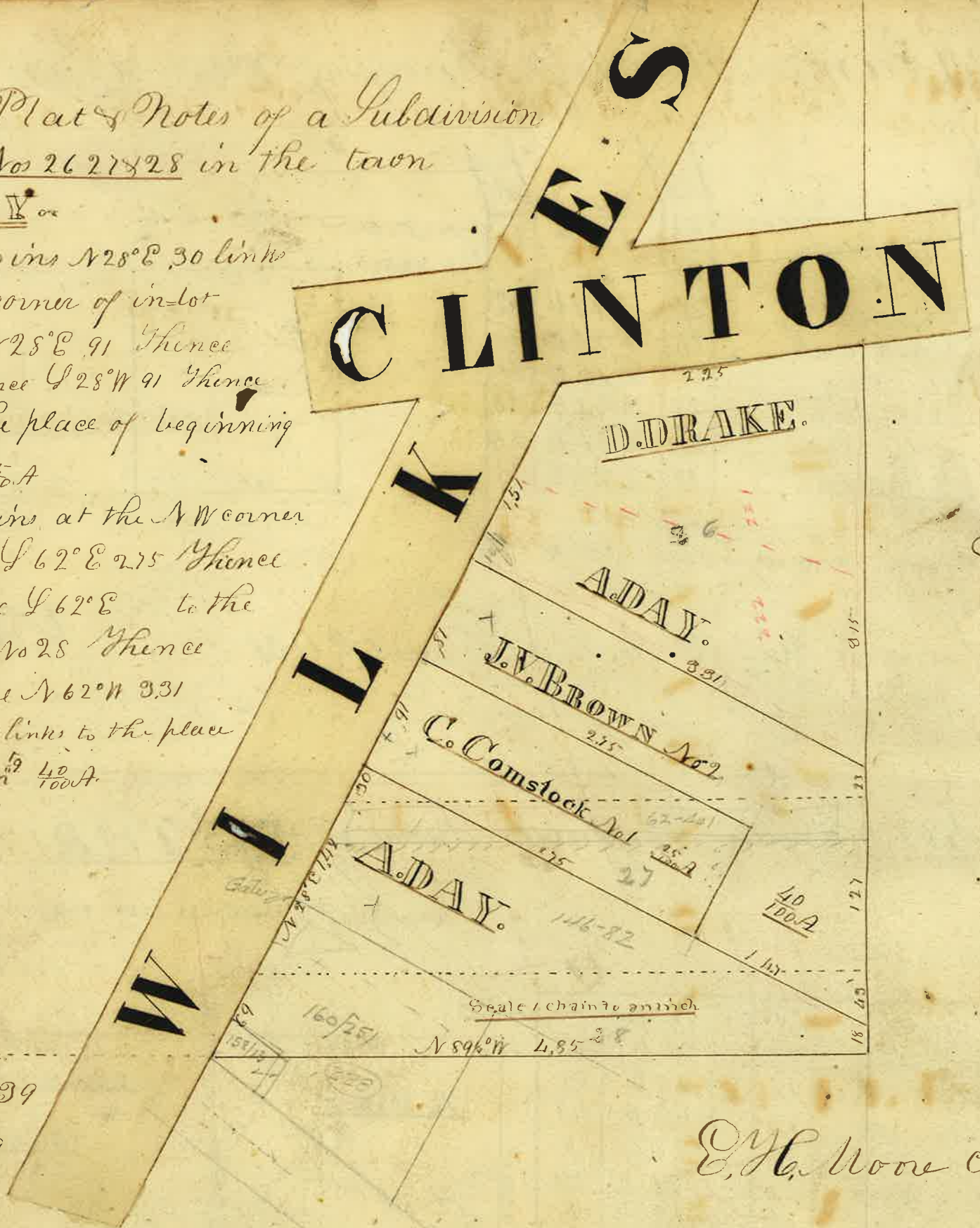

Surveyed May 21<sup>st</sup> 1839  
Recorded June 7<sup>th</sup> 1839

E. H. Moore C.S.

No 415 } Plat and Notes of a tract of land situated in Lot No 5 of 29 T 5 R 11  
"Ohio Co Purchase," to wit, Beginning at a Stake in the E. line of said said  
Section 13.50 S of the N.E. corner Thence W 30.00 Thence S 10.84 Thence E  
30 Thence N 10.84 to the place of beginning Containing 32<sup>52</sup>/<sub>100</sub> A

No 2 Begins at the N.W. corner of said Lot No 5 Thence S 38<sup>34</sup>/<sub>100</sub> E 9.90 Thence N 74  
9.00 Thence N 5.15 Thence W 15.10 to the place of beginning contain  
798  
100 A

Tree	Quantity	Bearing	Distance
Elm	9	N 22° E	15 1/2
Sugar	20	S 88° E	4 1/2
White oak	20	S 1/2 W	26
do do	24	N 23° W	44
Black oak	11	S 85 3/4° W	11 1/2
do do	9	N 28 1/2° W	23
Elm	6	N 6° W	17
do	7	N 1/2° W	21
Black oak	24	N 38 3/4° W	30
do do	18	S 62° E	43
B-Walnut	10	N 89 1/4° E	131
White oak	24	S 76° E	25
do do	12	N 52 3/4° W	15
Butternut	9	N 51 1/4° W	27
Buckeye	8	N 38° W	51



Surveyed May 24 1839

E. H. Moore C.S.