

DESCRIPTION OF A 60.976 ACRE TRACT

Situated in Farmlots 1 and 5 in Sections 1 and 7, T. 8, R. 14 Alexander Township, Athens County, Ohio, and being a part of Tract I and Tract II as described in Volume 353, page 749, Athens County deed records, Athens County, Ohio, and being more particularly described as follows:

Beginning at a railroad spike in Athens County Road 17 and the north line of Farmlot #1 of Section 7, Alexander Township; said railroad spike bearing West, 290.40 feet from the northeast corner of Farmlot #1; thence, East, 2121.45' along the north line of Farmlot #1, Section 7 and the north line of Farmlot #5, Section 1 to an iron pin; thence, S 11° 48' 30" E, 583.58' to an iron pin; thence, S 56° 44' W, 1120.98' to an iron pin; thence, N 83° 51' 30" W, 99.94' to an iron pin; thence, S 19° 52' W, 478.09' to an iron pin; thence, S 84° 20' W, 325.30' to a point on a bridge in Alexander Township Road 416-A (17-B), passing an iron pin at 100.00'; thence, along said road the following bearings and distances:

N 45° 51' W, 221.93' to a point;
N 64° 44' W, 486.31' to a point;
N 36° 21' 17" W, 234.87' to a point;

in the intersection of Alexander Township Road 416-A (17-B) and Athens County Road 17; thence along Athens County Road 17 N 7° 00' E, 560.40' to a point; thence, N 5° 00' W, 551.76' to a railroad spike, said railroad spike being the point of beginning and containing 8.097 acres in Farmlot 1, and 52.879 acres in Farmlot 5, for a total of 60.976 acres. Subject to all rights of way and easements of record.

Prepared by

William M. Watkins

William M. Watkins
Reg. Surveyor 5216

Description checked for
Mathematical Accuracy
ATHENS COUNTY
ENGINEER'S OFFICE

BY: *Cheryl Hedges*
DATE: *4/18/91*

Alx 17

AL

ROBERT A. CARBAUGH
234/140
57.76 AC

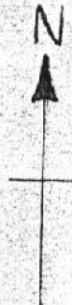

SCALE 1" = 200'
⊙ = IRON PIN

2121.45'

76 Ac

S 11° 48' 30" E
583.58'

79 Ac

S 56° 44' W
1120.98'

WILLIAM H. HARNETTY
353/749

N 83° 51' 30" W
99.94'

SURVEY OF A 60.976 AC. TRACT (8.097 AC
IN FARM LOT-1) AND 52.879 AC. IN
FARM LOT-5, TOWN-B, RANGE-14
ALEXANDER TWP ATHENS Co., OHIO
FOR HARNETTY + DIX

SURVEYED JANUARY, 1981

William M. Watkins

WILLIAM M. WATKINS
REG. SURVEYOR-5216

A)

ATHENS COUNTY
MEIGS COUNTY



2

SECTION-7

SECTION-1

108.25 Ac.

CHARLES D. CHASE ET
355/301
(23.0 AC)

FARM LOT-2
FARM LOT-4

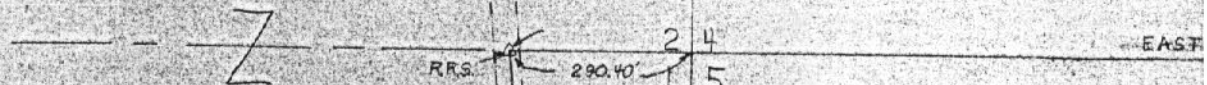

CHARLES D. CHASE, ET AL
355/301
(65.4 AC)

FARM LOT-1
FARM LOT-5



(8.097 AC)

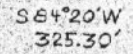
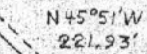
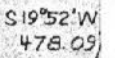
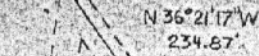

T-17-B (416)

15

3

XX
 ACREAGE, CLOSURE, AND ERROR OF PLAT
 XX

Line #						
1	North	90±	00'	00"	East	2,121.45 feet.
2	South	11±	48'	30"	East	583.58 feet.
3	South	56±	44'	00"	West	1,120.98 feet.
4	North	83±	51'	30"	West	99.94 feet.
5	South	19±	52'	00"	West	478.09 feet.
6	South	84±	20'	00"	West	325.30 feet.
7	North	45±	51'	00"	West	221.93 feet.
8	North	64±	44'	00"	West	486.31 feet.
9	North	36±	21'	17"	West	234.87 feet.
10	North	07±	00'	00"	East	560.40 feet.
11	North	05±	00'	00"	West	551.76 feet.

The easting error is -0.00 feet.
 The northing error is 0.00 feet.
 The gap in closure is 0.00 feet.

The precision of the field survey is
 0.00 feet error per 10,000 feet traverse.

The area computes to be 60.98 acres.