

Rt. 2, Box 139A
Glouster, OH 45732
[614] 767-2359

Situate in Lease Lot 6, Section 11, Alexander Twp., Athens County, Ohio. Being a part of the Richard M. and Marguerite Brown parcels as described in Deed Records Vol. 317 Pg. 185.

POINT-OF-BEGINNING being an iron pin set on the north line of said Lease Lot 6, said iron pin being S89 45'54"E 390.00 feet from an iron pipe found at the northwest corner of said Lease Lot 6;

Thence S89 45'54"E 246.59 feet to a stone found;

Thence S27 36'00"E 435.43 feet along an intermittent fenceline (said fenceline is a property line as agreed upon by testimony of Richard M. and Marguerite Brown on 04-26-1993 and Merry Lynn Cibula on 04-27-1993) to County Road 21 (reference: iron pin set at 408.71 feet);

Thence along said County Road 21 the following two courses: along a curve to the left having a radius of 409.87 feet, a length of 129.43 feet, and a chord bearing S37 40'57"W 128.89 feet; S29 48'03"W 271.28 feet to a point;

Thence leaving said road N51 23'18"W 303.18 feet to an iron pin set (reference: iron pins set at 20.06 feet and 100.00 feet);

Thence N00 14'06"E 535.12 feet to the Point-of-Beginning (reference: iron pins set at 200.00 feet and 415.11 feet);

Containing 5.16 acres as surveyed 04-27-1993 by Robert C. Canter, P.S. 7226.

Iron pins set are 5/8" x 30" rebar with plastic cap stamped "Canter P.S. 7226".

Plat of survey is attached herewith and made a part thereof.

Basis of Bearings: West line of Lease Lot 6 being N00 22'34"W (reference: survey of 5.57 acre parcel as surveyed 01-17-1986 by G. K. Wright, P.S. 6535). Bearings are used to determine angular relationships only.

Subject to all legal easements and right of ways.

Description checked for
Mathematical Accuracy
ATHENS COUNTY
ENGINEER'S OFFICE
BY: S. Blausen
DATE: 5-6-93

Alexander # 11

PLAT of SURVEY

Merry Lynn Cibula
O.R. Vol.96 Pg.26

NOTE: property line as agreed upon by testimony of Richard M. and Marguerite Brown on 4-26-1993 and by testimony of Merry Lynn Cibula on 04-27-1993.

NORTHWEST CORNER
of LEASE LOT 6

R.E. Dawson
O.R. Vol.34 Pg.811

S.A. Pratt
D.R. Vol.365 Pg.793

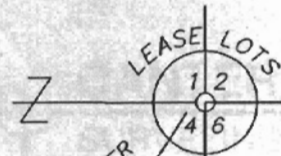

S 89°45'54" E
390.00'

S 89°45'54" E
246.59'

225,188 sq. ft.
5.16 acres

@ 415.11'

N 00°14'06" E

535.12'

@ 200.00'

S 27°36'00" E
435.43'

@ 408.71'

@ 1131.29'

N 00°22'34" W
1547.87'

559,327 sq. ft.
12.84 acres

N 51°23'18" W
303.18'

@ 100.00'

@ 20.06'

S 29°48'03" W
271.28'

S 29°48'03" W
132.39'

SITUATE IN LEASE LOT 6, SECTION 11,
ALEXANDER TWP., ATHENS CO., OHIO.
BEING A PART OF THE RICHARD M. and
MARGUERITE BROWN PARCELS AS
DESCRIBED IN D.R. VOL.317 PG.185.

Surveyed 04-27-1993 by Robert C.
Canter, P.S.7226.

CURVE	RADIUS	LENGTH	CHORD	BEARING
1	409.87'	129.43'	128.89'	S 37°40'57" W
2	1193.37'	239.27'	238.87'	N 36°42'19" E
3	151.89'	83.90'	82.84'	S 27°31'01" W

GRAPHIC SCALE

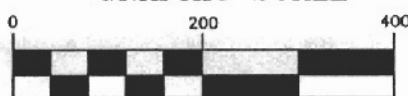

(IN FEET)

1 inch = 200 ft.

S 00°22'34" W
121.56'

S 00°14'52" E
89.54'

- = R/R SPIKE SET
- = IRON PIN/PIPE FOUND
- = 5/8" x 30" IRON PIN /w cap stamped CANTER P.S. 7226

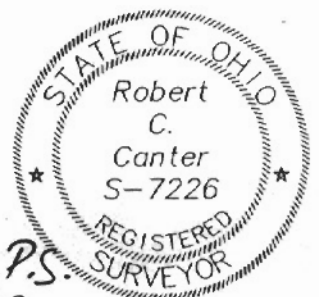

Robert C. Canter, P.S.
Robert C. Canter, P.S.