

Richard Jeffers
3.19 ac.
294-1664 O.R.

Gene P. French
366-283 O.R.
56.77 ac.

Description Checked for
Mathematical Accuracy
Athens County
ENGINEER'S OFFICE
BY: S. Blausg
DATE: 12-19-17

2.131 Acres

Marie A. French
477-1670 O.R.
Tract 1

Marie A. French
477-1670 O.R.
Tract 2

Gene P. French
366-283 O.R.
0.19 ac.

458189.75-N
2073789.24-E

POB BEARS
S 49° 55' 22" W
3058.53' (calc from deeds)
FROM N.E. COR OF L.L.#4

Fisher Road

Survey of Existing Tracts of Record
being Tracts 1 & 2 as recorded in
477-1670 O.R. and being
Situating in F.L.#4, Sec. 17, T.8, R.14,
Alexander Twp, Athens Co., O.

Surveyed December 2012

John M. Branner P.S. 6805
62 East First Street
The Plains, Ohio 45780

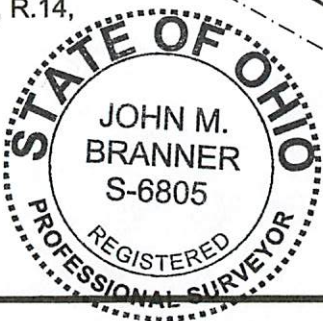

S 66° 29' 24" E

N 26° 08' 58" E
288.11'

B010010051100
B010010051000

fence

fence

+25.00'

N 60° 16' 43" W

308.22'

+300.17'

321.28'

S 25° 07' 36" W

● = iron pin set
○ = iron pin fd.
Bearings: Grid North N.A.D. 83
Ref. Docs. Deeds- Tax Plat

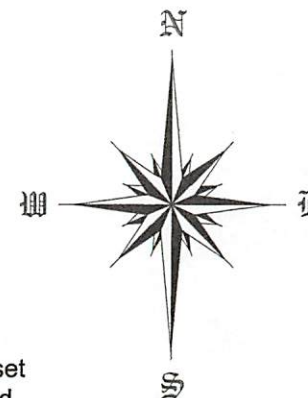

Scale 1 inch = 60 feet

Description Approved

Jill A. Thompson 12-21-12
Athens County Auditor

Description of a 2.131 Acre Tract (Combining Existing Tracts of Record)

Situated in Farm-Lot#4, Section 17, T.8, R.14, Alexander Township, Athens County, Ohio and being all of Tract One and Tract Two, as described in Volume 477, Page 1670 Official Records of Athens County, Ohio and being more particularly described as follows:

Beginning at a point in Fisher Road and being the South-east corner of a 3.19 acre tract(294-2664 O.R.) and bearing South 49 degrees 55 minutes 22 seconds West, 3058.53 feet (calculated from deed) from the North-east corner of L.L. #4,

Thence, leaving said road and along the East-line of Jeffers (294-2664 O.R.) ,

North 26 degrees 08 minutes 58 seconds East, 288.11 feet to an iron pin set;

Thence, along the South-line of the Gene P. French 56.77 acre tract (366-283 O.R.) ,

South 66 degrees 29 minutes 24 seconds East, 302.21 feet to an iron pin set;

Thence, along the West-line of the 0.19 acre Gene P. French (366-283 O.R.) ,

South 25 degrees 07 minutes 36 seconds West, 321.28 feet to a point in Fisher Road, passing an iron pin set at 300.17 feet;

Thence, along Fisher Road,

North 60 degrees 16 minutes 43 seconds West , 308.22 feet to the point of beginning and containing **2.131 acres**.

Subject to all easements and rights of way of record

Bearings based on Grid North N.A.D. 83

The above description is based on a field survey complete December 2012 by

John M. Branner P.S. 6805



Description Checked for
Mathematical Accuracy
Athens County
ENGINEER'S OFFICE
BY: S. Blause
DATE 12-19-12

