

Description Checked for
Mathematical Accuracy
Athens County
ENGINEER'S OFFICE
BY: Perennial Walker
DATE: 11/13/14

Description of 0.265 Acres

Description of a parcel of land situate the Ohio Company Purchase Town 8, Range 14, Farm Lot 3, (Section 34), Alexander Township, Athens County, Ohio Being the lands deeded to John E. Dearth, Official Record Book 527, pages 290-293, Parcel B010280203600, and being more fully described as follows:

Commencing at an iron pin found in Hebbardsville, Ohio at the southeast corner of record Lot 18 of the recorded "Plat Town of Hebardville of 1838" Athens County Recorder Book 9, page 543.

Thence N87°47'47"W 146.52 feet to the southwest corner of said lot to a point in the center of County Road 80, Enlow Rd.;

Thence S02°46'46"E 33.13 feet to an iron pin set at the point of beginning of the parcel herein described;

1.) Thence S00°40'00"W 165.00 feet along a common boundary to Hudnell 379-261 and Dearth 527-290 to an iron pin found, and referencing from said iron pin found a notched stone found at S36°15'00"E 0.69 feet;

2.) Thence N87°04'27"W 81.00 feet along a common boundary to Ohio University 310-493 and Dearth 527-290 to and iron pin found, and referencing from said iron pin found a notched stone found at N01°54'37"E 0.51 feet;

3.) Thence N05°55'30"E 147.77 feet along a common boundary to Kovaleski 60-968 and Dearth 527-290 to an iron pin set;

4.) Thence N78°23'48"E 68.97 feet along the south right-of way of Old Route 50 and now being Enlow Road, County Road 80 to the point of beginning containing a total of 0.265 acres.

Plat of Survey is attached herewith and made a part thereof.

Subject to all easements, rights-of-way, covenants and agreements of record.

Iron pins set are 30 inches length number 5 rebar capped "NEWMAN PS-8043"

Basis of bearings the east boundary of Main Street as denoted on survey plat.

The above boundary description was based on an actual field survey and completed by Charles T. Newman Professional Surveyor Registered PS-8043 on November 13, 2018.

Charles T. Newman
Professional Surveyor
66 Elmwood Place
Athens, Ohio 45701

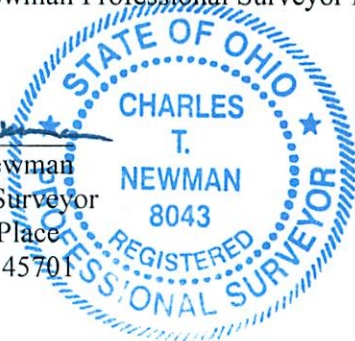

Legal Description Pre-Approval
APPROVED
All transfers are subject to
Athens County Conveyance Standards

NOV 14 2018

Jill Thompson
Athens County Auditor

Description Checked for
Mathematical Accuracy
Athens County

ENGINEER'S OFFICE

BY: Charles T. Newman
DATE: 11/13/16

66 Elmwood Place
Athens, Ohio 45701

740-594-1884
FAX 740-594-9413

C. TIM NEWMAN

Professional Surveyor



Plat of Survey of 0.265 Acres
Situate Ohio Company Purchase Town 8, Range 14,
Farm Lot 3, (Section 34) Alexander Township,
Athens County, Ohio.
Being the lands deeded to John E. Dearth
Official Record Book 527, pages 290-293
Parcel B010280203600



Basis of Bearings:
Denoted west line of MAIN ST.

Centerline Enlow Rd. C-80

Kovaleski
60-968

0.265 ACRES

Hudnell
379-261

Lot referred to as
both #30 and #38
Not Platted on
Hebardville Plat of 1838
Deed Book 9, pg. 543

Ohio University 310-493

Lucas 60.06'

GRAPHIC SCALE



(IN FEET)

1 inch = 60 ft.

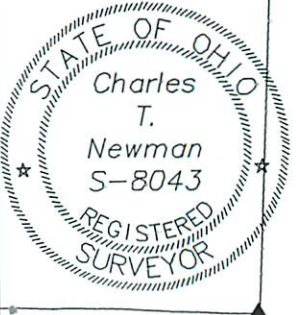

Charles T. Newman
Charles T. Newman
November 13, 2018

- ▲ = Railroad Spike Found
- ▲ = Iron Pin Found 3/4" Pipe
- ⊙ = Iron Pin Found #5 Rebar
- = Iron Pin Set 8043
- = Notched Stone Found

Farm Lot 3

Western Alley 16.5'

Main 60.06'

Hebbardsville Rd. C-19

N 00°40'00" E 165.00'

Survey 1993

Southeastern

240

N 02°06'19" E

100.00'

N 87°45'06" W
53.96'

N 88°20'29" W
134.43'

N 05°55'30" E

147.77'

N 87°04'27" W
81.00'

S 02°46'46" E
33.13'

N 78°23'48" E
68.97'

S 00°40'00" W
165.00'

N 87°47'47" W
146.52'

EMHT Survey 1983

18

22

22

Lafayette 30.03' Short St.

19

20

21

27

26