

HIGHLAND SURVEYING LTD.

80 Fayette St.  
Nelsonville, Ohio 45764

Phone 740-753-1264  
Fax 740-753-1264

**Description of a 1.199 Acre Tract**

Situated in Farm Lot 1, Section 12, T-8, R-14, Alexander Township, Athens County, State of Ohio and being a part of a the second tract as described in Volume 363, Page 1 of the Official Records of Athens County and being more particularly described as follows:

Commencing at a Railroad Spike found in the center of CR-21 at the Northwestern corner of a 3.5 acre tract and also being on the East line of Farm Lot 1 and the West line of Farm Lot 7 per previously recorded deed, thence North 39°18'00"West, 28.57 feet to Railroad Spike found and being the POINT OF BEGINNING,

THENCE along grantors south line South 76°51'59"West, 195.03 feet to an iron pin set, (passing an iron pin found at 25.35 feet),

THENCE continuing along said line South 80°50'28"West, 179.85 feet to an iron pin set,

THENCE along a new line North 3°20'20"East, 199.67 feet to an iron pin set,

THENCE South 87°28'24"East, 268.19 feet to a point in the center of CR-21, (passing an iron pin set at 231.29 feet),

THENCE along the center of said road South 37°30'23"East, 144.42 feet to the point of beginning and containing 1.199 acres.

Bearings are to an assumed meridian and are for angular determination only

Subject to all Easements and Rights of Way of Record

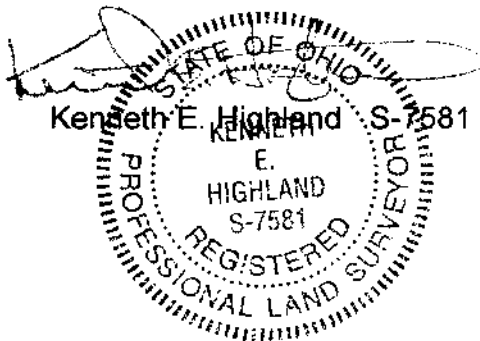

Description Checked for  
Mathematical Accuracy  
Athens County  
ENGINEER'S OFFICE  
BY: S. Blaus  
DATE: 8-10-04

Phone 740-753-1264  
Fax 740-753-1264

**Description of a 6.058 Acre Tract**

Situated in Farm Lot 1, Section 12, T-8, R-14, Alexander Township, Athens County, State of Ohio and being a part of a the second tract and all of the first tract as described in Volume 363, Page 1 of the Official Records of Athens County and being more particularly described as follows:

Commencing at a Railroad Spike found in the center of CR-21 at the Northwestern corner of a 3.5 acre tract and also being on the East line of Farm Lot 1 and the West line of Farm Lot 7 per previously recorded deed, thence North 39°18'00"West, 28.57 feet to Railroad Spike found, thence South 76°51'59"West, 195.03 feet to an iron pin set, thence South 80°50'28"West, 179.85 feet to an iron pin set at the POINT OF BEGINNING, THENCE South 80°50'28"West, 61.57 feet to an iron pin set, THENCE North 87°33'07"West, 215.21 feet to an iron pin found disturbed and reset, THENCE North 76°37'05"West, 68.69 feet to an iron pin set, THENCE North 61°36'40"West, 76.45 feet to an iron pin set, THENCE North 57°10'35"West, 185.02 feet to an iron pin set, THENCE North 0°38'09"West, 249.69 feet to a point at the northwest corner of grantors tract, THENCE along said north line South 89°49'40"East, 522.33 feet to an iron pin set at the southwest corner of .25 acre tract, THENCE North 4°00'00"West, 33.66 feet to an iron pin set, THENCE along the north line of said tract North 88°18'45"East, 239.58 feet to a point in the center of CR-21, (passing a fence post at 197.09 feet and being 0.71 feet left), THENCE along the center of said road the following four courses: South 11°58'55"West, 42.24 feet to a point, South 2°46'22"East, 58.44 feet to a point, South 28°52'28"East, 126.62 feet to a point, South 37°47'48"East, 53.89 feet to a point, THENCE leaving said road North 87°28'24"West, 268.19 feet to an iron pin set, (passing an iron pin set at 36.90 feet), THENCE South 3°20'20"West, 199.67 feet to the point of beginning and containing 6.058 acres.

Bearings are to an assumed meridian and are for angular determination only  
Subject to all Easements and Rights of Way of Record



Description Checked for  
Mathematical Accuracy  
Athens County  
ENGINEER'S OFFICE  
BY: B. Blaus  
DATE: 8-10-04

ALX 12

HIGHLAND SURVEYING Ltd.  
Registered Professional Land Surveyor

Richie  
330-305 OR

Brickles  
363-527

6.058 Ac.

1.199 Ac.

F.L. 1  
F.L. 7

CR-21

Description Checked for  
Mathematical Accuracy  
Athens County  
ENGINEER'S OFFICE

BY: S. Blauiss  
DATE: 8-10-04

Line	Bearing	Distance
1	N 39°18'00"W	28.57'
2	N 4°00'00"W	33.66'
3	S 11°58'55"W	42.24'
4	S 37°47'48"E	53.89'

- = Iron Pin Set      □ = Wood Post Found
- = Iron Pin Found    ▲ = Railroad Spike Found

Gerty  
343-305

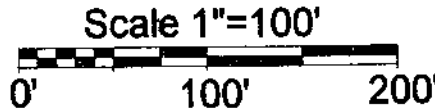

Point of Commencement  
is a RR Spike at the North-  
westerly corner of a 3.5 ac.  
tract and also being on the  
East line of F.L. 1 and the West  
line of F.L. 7 and in the center  
of CR-21. (per previous deed)



PLAT OF SURVEY OF TWO TRACTS

SUBDIVISION FL-1

TOWNSHIP ALEXANDER SECTION 12 TOWN 8 RANGE 14

CORPORATION — COUNTY ATHENS STATE OHIO

SCALE 1"= 100' DATE AUG, 2004

Kenneth E. Highland  
80 Fayette St.  
Nelsonville, Ohio 45761  
740-753-1284

Kenneth E. Highland S-7581

ALX #12