

PROFESSIONAL LAND SURVEYORS

- URBAN LOTS & FARM SURVEYS
- CONSTRUCTION STAKEOUT
- OIL WELL PERMITTING
- LAND PLANNING
- SUBDIVISIONS
- AERIAL
- GPS

SEYMOUR & ASSOCIATES





Voice: 614.385.4349 - Fax: 614.385.5954
 830 W.Hunter St., P.O.Box 624, Logan, OH, 43138-0624

Re: Survey of Section 17 and Section 23, Ames Township, Athens County, Ohio, State of Ohio

Grantor: Lois Gerig

Grantee: Elizabeth Langstaff

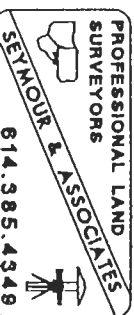
Legal Description: See Attached Exhibit "A"



000142

AMS #17

EXHIBIT "A"

Being all of the tract of land that is now or formerly in the name of Lois Gerig, as recorded in Official Record 212 at page 78, Athens County Recorder's Office, said tract being situated in the west half of Section 17 and the east half of Section 23, T6N, R13W, Ames Township, Athens County, State of Ohio and being more particularly described as follows:

Beginning at a 5/8" X 30" iron pin with a plastic identification cap set on a corner to the tract of land, as recorded in Official Record 212 at page 78, on the section line between Sections 17 and 23, from which the northwest corner of Section 23, as calculated from a survey that is recorded in Volume 234 at page 9, bears, North 05 degrees 31 minutes 52 seconds East a distance of 1,943.28 feet, and North 84 degrees 28 minutes 08 seconds West a distance of 5,589.90 feet;

Thence along the grantor's property line, and the east line of Section 23, South 05 degrees 31 minutes 52 seconds West a distance of 285.03 feet to a point from which a 5/8" X 30" iron pin with a plastic identification cap set for reference bears, North 25 degrees 33 minutes 47 seconds West a distance of 2.04 feet;

Thence continuing along the grantor's line, South 25 degrees 33 minutes 47 seconds East a distance of 1,426.92 feet to a 5/8" X 30" iron pin with a plastic identification cap set;

Thence continuing along the grantor's line, South 62 degrees 32 minutes 58 seconds East a distance of 691.20 feet to a 5/8" X 30" iron pin with a plastic identification cap set;

Thence continuing along the grantor's line, South 26 degrees 34 minutes 50 seconds West a distance of 618.42 feet to a 5/8" X 30" iron pin with a plastic identification cap set;

Thence continuing along the grantor's line, South 05 degrees 37 minutes 28 seconds West passing through a 5/8" X 30" iron pin with a plastic identification cap set at 586.65 feet, going a total distance of 602.26 feet to a point in the center of Township Road 340;

Thence along the center of Township Road 340, the following twelve courses:

1. South 88 degrees 38 minutes 10 seconds West a distance of 139.60 feet a "P.K." Nail set;
2. South 82 degrees 07 minutes 11 seconds West a distance of 543.20 feet a "P.K." Nail set;
3. South 86 degrees 32 minutes 36 seconds West a distance of 445.42 feet to a point;
4. North 84 degrees 18 minutes 46 seconds West a distance of 48.13 feet to a point in the west line of Section 17;
5. North 67 degrees 23 minutes 27 seconds West a distance of 149.52 feet to a point;
6. North 69 degrees 50 minutes 35 seconds West a distance of 126.91 feet to a point;
7. North 75 degrees 29 minutes 25 seconds West a distance of 123.84 feet to a point;
8. North 80 degrees 14 minutes 24 seconds West a distance of 201.49 feet to a point;
9. North 73 degrees 14 minutes 49 seconds West a distance of 700.78 feet to a point;
10. North 69 degrees 06 minutes West a distance of 95.98 feet to a "P.K." Nail set;
11. North 70 degrees 14 minutes 35 seconds West a distance of 119.37 feet to a "P.K." Nail set, and;
12. North 71 degrees 43 minutes 45 seconds West a distance of 309.84 feet to an 8 penny spike found in the intersection of Township Road 340 and County Road 36;

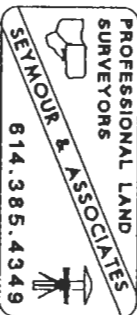

000143

EXHIBIT "A"

Thence along the center of County Road 36, the following fifteen courses:

1. North 06 degrees 37 minutes 50 seconds East a distance of 461.99 feet to a "P.K." Nail set;
2. North 04 degrees 32 minutes 55 seconds East a distance of 178.63 feet to a point;
3. North 00 degrees 36 minutes 44 seconds West a distance of 106.57 feet to a point;
4. North 14 degrees 58 minutes 35 seconds West a distance of 115.45 feet to a point;
5. North 39 degrees 10 minutes 12 seconds West a distance of 108.54 feet to a point;
6. North 57 degrees 21 minutes 45 seconds West a distance of 114.26 feet to a point;
7. North 68 degrees 53 minutes 42 seconds West a distance of 64.39 feet to a point;
8. North 78 degrees 33 minutes 54 seconds West a distance of 79.76 feet to a "P.K." Nail set;
9. North 84 degrees 50 minutes 38 seconds West a distance of 121.15 feet to a "P.K." Nail set;
10. North 81 degrees 30 minutes 46 seconds West a distance of 80.22 feet to a point;
11. North 67 degrees 09 minutes 30 seconds West a distance of 94.11 feet to a point;
12. North 49 degrees 44 minutes 45 seconds West a distance of 96.15 feet to a point;
13. North 37 degrees 32 minutes 57 seconds West a distance of 47.50 feet to a "P.K." Nail set;
14. North 31 degrees 31 minutes 07 seconds West a distance of 97.02 feet to a "P.K." Nail set, and;
15. North 38 degrees 39 minutes 25 seconds West a distance of 82.00 feet to a point being the grantor's southwest corner;

Thence leaving the center of County Road 36, and along the grantor's west line, North 29 degrees 44 minutes 48 seconds East passing through an iron pin with a plastic identification cap stamped "P.S. 6765" found at 22.77 feet, going a total distance of 128.84 feet to an iron pin with a plastic identification cap stamped "P.S. 6765" found;

Thence North 29 degrees 13 minutes 30 seconds East a distance of 332.92 feet to a corner post;

Thence North 54 degrees 00 minutes 26 seconds East a distance of 591.63 feet to a corner post;

Thence North 00 degrees 51 minutes 44 seconds West a distance of 691.20 feet to a 5/8" X 30" iron pin with a plastic identification cap set on the grantor's northwest corner;

Thence along the grantor's northerly line, North 80 degrees 52 minutes 19 seconds East a distance of 653.40 feet to a 5/8" X 30" iron pin with a plastic identification cap set;

Thence South 17 degrees 08 minutes 06 seconds East a distance of 1,182.76 feet to a 5/8" X 30" iron pin with a plastic identification cap set;

Thence North 33 degrees 48 minutes 54 seconds East a distance of 1,049.40 feet to a 5/8" X 30" iron pin with a plastic identification cap set;

Thence South 86 degrees 44 minutes 06 seconds East a distance of 533.15 feet to the point of beginning containing 134.859 acres in Section 23, and 52.387 acres in Section 17, making a total of 187.246 acres, more or less, and subject to the right-of-way of Township Road 340 and County Road 36 and all easements of record.

All 5/8" X 30" iron pins with plastic identification caps set are stamped "Seymour & Associates".

The bearings used in the above described tract were derived from a survey that is recorded in Volume 162 at page 261 and are for the determination of angles only.

The above described tract was surveyed by George F. Seymour, Ohio Professional Survey No. 6044, in January of 2000.

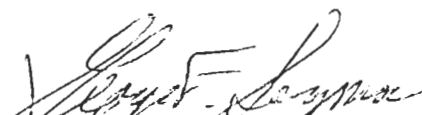

George F. Seymour, P.S. 6044

Description checked for
Mathematical Accuracy
ATHENS COUNTY
ENGINEER'S OFFICE
BY: S. Blausen
DATE: 1-31-2000

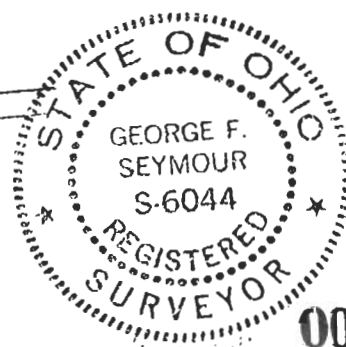

000144

