

DETAIL "A"

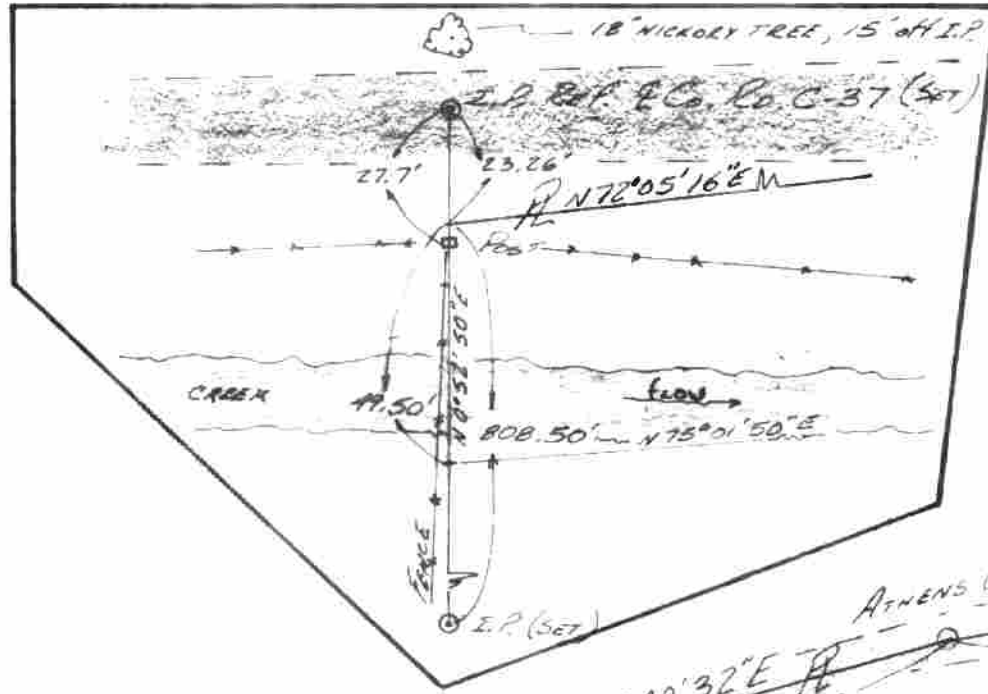

3/16 M. Ball  
32A-117

WARREN M. HASLER, ET AL.  
250-666 & 296-204

D = 3°  
 Δ = 4° 35' 12" CA: 383° 20' 23"E, 152.85'  
 T = 76.49'  
 R = 1909.86'

MARK S. SHUBERT, ET AL.  
309-867

DAVID B & PATRICIA  
GRAHM  
296-433

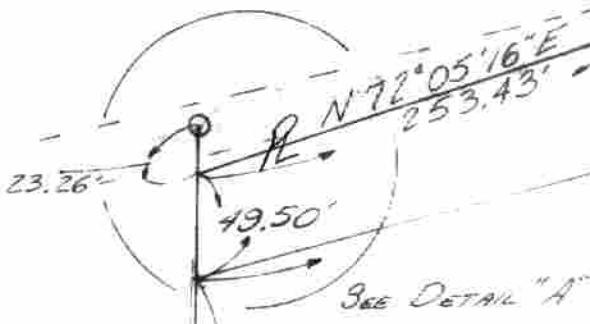

Homer & Esther Linscott  
& Nancy Linscott  
136-7, 8, 9  
N 0° 52' 50" E 759.00'  
Survey (11.500 Ac. N. Deed)

PAUL M. WILSON  
307-236  
&  
288-304

AREA = 5.7731 AC.

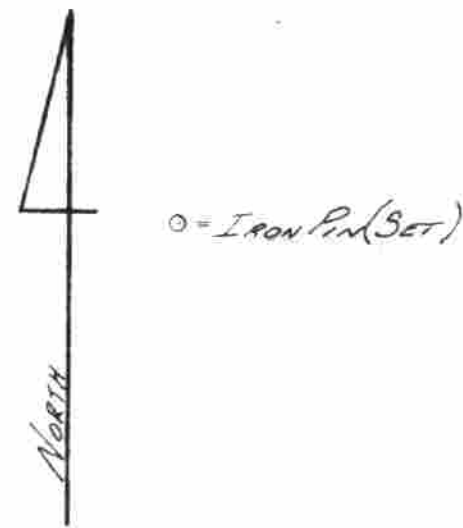

TERRY K. & MARY HELEN  
HARVEY  
275-362

W 643.50' (DEED)  
Dow & Hazel Linscott  
177-251, 252 & 213-95

Sec 24  
Sec 23

N 594.00' (DEED)  
Old Stone (Found)  
2161.5' (DEED)

SE. CORNER SEC 23

**PLAT OF SURVEY**

A 5.7731 ACRE TRACT: SITUATED IN  
 SECTION 24, TOWN 6, RANGE 13,  
 AMES TOWNSHIP, ATHENS COUNTY, OHIO

SCALE: 1" = 100'  
 DATE: SEPT. 7, 1974  
 DRAWN: G.E.H.  
 CHECKED: G.E.H.  
 JOB No. 0874-01  
 BY: G.E.H.  
 GERALD E. HANN, P.S.  
 81 ELMWOOD PLACE  
 ATHENS, OHIO 45701  
 REG. SURVEYOR'S No.  
 9-5062

Description checked for  
 Mathematical Accuracy  
 ATHENS COUNTY  
 ENGINEER'S OFFICE  
 BY: *[Signature]*  
 DATE: 9-16-74

