

Ord. Math
312-857

ROY

Ath 24

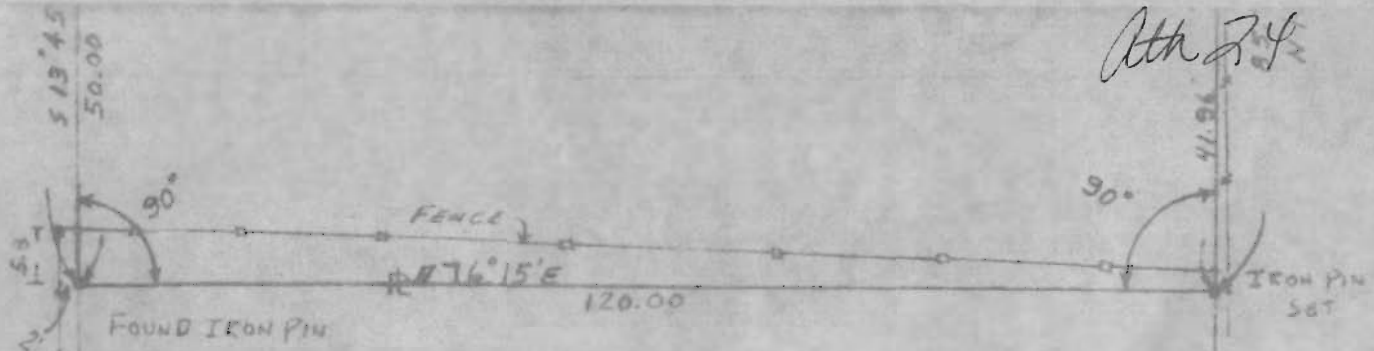

William R &
Vera F.
VAN SICKLE
285-474

Description checked for
Mathematical Accuracy
ATHENS COUNTY
ENGINEER'S OFFICE

BY: *[Signature]*

DATE: 12-15-74

*Subject to approval
of Athens County (Gov.)
Planning Commission*

**SURVEY OF A 0.12667 ACRE TRACT IN LOT NO. 137 IN
ALBERT MATHENY'S ADDITION TO THE VILLAGE
OF VERITY (NOW THE PLAINS, OHIO
for EVELYN Y. ERWIN**

SURVEYED DEC. 3, 1974 by HAROLD D. WHALEY

Harold D. Whaley

REG. SURVEYOR NO. 4986

159

Evelyn K.
Erwin

145

50'

NORTH
ST. 40'

50'

140
Ora Mash
312-857

ROY AVE. (30')

FOUND PIPE

$S 78^{\circ} 25' 50" E$
192.75

92.50

137

0.1878 AC.

SCALE 1" = 20'

WOOD POST

142.50
 $S 17^{\circ} 45' W$

93.50

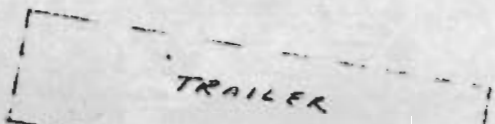

$S 80^{\circ} 05' W$
120.27

86.10

43.77

IRON PIN

5,517.60 S.F. = 0.12667 AC.

160

85.73'
 $N 13^{\circ} 45' W$

N

WILLIAM O. ROWLAND
ATTORNEY AT LAW
SECURITY BUILDING
ATHENS, OHIO 45701
PHONE 592-1473

December 17, 1974

Athens County Engineer Depot
555 E. State Street
Athens, Ohio
45701

Dear Sir:

Enclosed please find a new survey in regard to the Evelyn Erwin property located in The Plains, Ohio for your approval. A copy of the plat is enclosed.

Very truly yours,

William O. Rowland
W. M. Davis
William O. Rowland

/md
Encls.

161

HAROLD D. ("DALE") WHALEY

REGISTERED SURVEYOR NO. 4986

ALBANY, OHIO 45710

Lots, Farms, Subdivisions and Construction Staking

0.12667 Acre Tract
Evelyn V. Arwin

Situated in Lease Lot No. 114, Sec. 24, T. 9, R. 14, Athens Twp., Athens County, Ohio, and being part of Lot No. 137 in Albert Matheny's Addition to Verity (now The Plains, Ohio) and being more particularly described as follows:

Beginning at an iron pin on the west line of Lot No. 137, S. 13° 45' E., 142.50 feet from the Northwest corner of Lot No. 137;

Thence at right angles to the west line of Lot No. 137 and the East line of Roy Avenue, N. 76° 15' E.; 120.00 feet to an iron pin on the East line of Lot No. 137;

Thence along the East line of Lot No. 137, N. 13° 45' W., 141.96 feet to an iron pin;

Thence S. 80° 05' W., 120.27 feet to an iron pin on the west line of Lot No. 137 and the East line of Roy Avenue;

Thence along the west line of Lot No. 137 and the East line of Roy Avenue, S. 13° 45' E., 50.00 feet to the point of beginning, containing 0.12667 acre, and being part of Lot No. 137 in Albert Matheny's Addition to Verity, Ohio.

Surveyed Dec. 3, 1974 by HAROLD D. WHALEY

Harold D. Whaley
Reg. Surveyor No. 4986

Description checked for
Mathematical Accuracy

ATHENS COUNTY

ENGINEER'S OFFICE

BY: *[Signature]*

DATE: 12-19-74

*SUBJECT TO APPROVAL BY
ATHENS COUNTY PLANNING COMMISSION
[Signature]*

HAROLD D. ("DALE") WHALEY

REGISTERED SURVEYOR NO. 4986

ALBANY, OHIO 45710

Lots, Farms, Subdivisions and Construction Staking

0.12667 Acre Tract
Evelyn V. Erwin

Situated in Lease Lot No. 114, Sec. 24, T. 9, R. 11, Athens Twp., Athens County, Ohio, and being part of Lot No. 137 in Albert Matheny's Addition to Verity (now The Plains, Ohio) and being more particularly described as follows:

Beginning at an iron pin on the west line of Lot No. 137, S. 13° 45' E., 142.50 feet from the Northwest corner of Lot No. 137;

Thence at right angles to the west line of Lot No. 137 and the East line of Roy Avenue, N. 76° 15' E., 120.00 feet to an iron pin on the east line of Lot No. 137;

Thence along the East line of Lot No. 137, N. 13° 45' W., 41.96 feet to an iron pin;

Thence S. 80° 05' W., 120.27 feet to an iron pin on the west line of Lot No. 137 and the East line of Roy Avenue;

Thence along the West line of Lot No. 137 and the East line of Roy Avenue, S. 13° 45' E., 50.00 feet to the point of beginning, containing 0.12667 acre, and being part of Lot No. 137 in Albert Matheny's Addition to Verity, Ohio.

Surveyed Dec. 3, 1974 by HAROLD D. WHALEY

Harold D. Whaley
Reg. Surveyor No. 4986

Description checked for
Mathematical Accuracy

ATHENS COUNTY

ENGINEER'S OFFICE

BY: *[Signature]*

DATE: 12-19-74

*SUBJECT TO APPROVAL BY
ATHENS COUNTY PLANNING COMMISSION*
[Signature]

162

Sec 24 R11

OFFICE OF
COUNTY ENGINEER
ATHENS COUNTY
GERALD E. HANN, COUNTY ENGINEER
ATHENS, OHIO

File

December 22, 1974

Mr. Phillip Goldsberry
Athens Safety-Service Director
City of Athens
Athens, Ohio 45701

Re: Athens City Planning
Commission

Dear Mr. Goldsberry:

Please find enclosed a copy of a survey of a 0.12667 acre tract involving a lot split of lot number 137 of the Matheny Addition to Verity, The Plains, Ohio.

The description for the survey was submitted to this office for approval of transfer by Mr. William O. Rowland for Evelyn V. Erwin.

The mathematical accuracy of the description has been checked and approved by this office.

Whereas the proposed transfer involves land located within the three mile radius of jurisdiction of the Athens City Planning Commission, I am forwarding this plat to you for your approval.

You will please notify Mr. Rowland of whatever action The Planning Commission takes on this matter. Thank you.

Very truly yours,

Gerald E. Hann, P.E.P.S.
Athens County Engineer

GEH:cc

enc.

cc Mr. William Rowland

164