

EXHIBIT "A"

Being a part of the 1.03 acre First Tract of land that is now or formerly in the name of James and Genevieve Tom as recorded in Deed Book 341 at page 185, Athens County Recorder's Office, said tract being situated in Farm or Lease Lot 167 (Sections 33 & 27), T9N, R14W, Athens Township, Athens County, State of Ohio and being more particularly described as follows:

Beginning at an iron pipe found on the southeast corner of Tract 12 of "Elmer Toms Long-View Addition" as recorded in Plat Envelope 286A, the west line of Farm of Lease Lot 126, the east line of Farm or Lease Lot 167 and the grantors northwesterly corner;

Thence along the east line of Farm or Lease Lot 167, the west line of Farm or Lease Lot 126 and the grantor's east line, South 03 degrees 44 minutes 50 seconds West, passing through a 5/8" X 30" iron pin with a plastic identification cap set at 37.15 feet, going a total distance of 63.70 feet to a point being a corner to the grantor;

Thence leaving the east line of Farm or Lease Lot 167 and the west line of Farm or Lease Lot 126 and along a line to the grantor, South 73 degrees 04 minutes 50 seconds West a distance of 34.80 feet to a 5/8" X 30" iron pin with a plastic identification cap set on a corner to the grantor, said iron pin being referenced by an iron pipe with an elbow found (not taken as survey marker) which bears North 08 degrees 05 minutes 48 seconds East a distance of 3.39 feet;

Thence with a new line through the grantor's land, North 26 degrees 56 minutes 38 seconds East a distance of 82.67 feet to the place of beginning, containing 0.0238 acre or 1,036.1 square feet, more or less, and subject to all easements of record.

The above described ADJOINING PROPERTY OWNER TRANSFER 0.0238 acre parcel is to be held in Continuous and Contiguous ownership with adjoining property owned by the grantee herein.

All 5/8" X 30" iron pins with plastic identification caps set are stamped "Seymour & Associates".

The bearings used in the above described tract were based on the south line of Tract 12 in the "Elmer Tom's Long-View Addition" as recorded in Plat Envelope 286A as bearing South 86 degrees 04 minutes 10 seconds East and are for the determination of angles only.

The above described tract was surveyed by Seymour & Associates under the direct supervision of Gerald W. Bayha, Ohio Professional Surveyor No. 6139, October 20, 1997 and revised on March 8, 1999.



Gerald W. Bayha
Gerald W. Bayha, P.S. #6139



Description checked for
Mathematical Accuracy
ATHENS COUNTY
ENGINEERS OFFICE
BY: *B. J. [unclear]*
DATE: *3-9-99*

103

ATTN # 33

Being all of the tracts of land that is now or formerly in the name of Steven W. and Kim A. McKinley as recorded in Official Record 228 at page 368 and Official Record _____ at page _____, Athens County Recorder's Office, said tracts being situated in Farm or Lease Lots 167 and 126 (Sections 33 & 27), T9N, R14W, Athens Township, Athens County, State of Ohio and being more particularly described as follows:

Beginning at an iron pipe found on the southeast corner of Tract 12 of "Elmer Tom's Long-View Addition" as recorded in Plat Envelope 286A, the west line of Farm of Lease Lot 126, the east line of Farm or Lease Lot 167 and the grantor's northwesterly corner;

Thence leaving the east line of Farm or Lease Lot 167 and the west line of Farm or Lease Lot 126 and along the grantor's north line, South 85 degrees 56 minutes 57 seconds East, passing through an iron pipe found at 202.15 feet, going a total distance of 232.11 feet to a point being the grantor's most easterly corner and in the center of Township Road 241;

Thence along the center of said road and the grantor's southerly line the following three courses:

1. South 54 degrees 33 minutes 53 seconds West a distance of 134.13 feet to a point;
2. South 57 degrees 47 minutes 12 seconds West a distance of 54.29 feet to a point, and;
3. South 62 degrees 54 minutes 37 seconds West, crossing into Farm or Lease Lot 167 at 98.05 feet, going a total distance of 110.78 feet to a point being the grantor's most southerly corner;

Thence leaving the center of said road and along the grantor's westerly line the following two courses:

1. North 08 degrees 37 minutes 10 seconds West, passing through a 5/8" X 30" iron pin with a plastic identification cap set at 12.50 feet, said iron pin being referenced by an iron pin found which bears North 38 degrees 57 minutes 37 seconds West a distance of 2.48 feet, going a total distance of 101.00 feet to a 5/8" X 30" iron pin with a plastic identification cap set, said iron pin being referenced by an iron pipe with an elbow found (not taken as a survey marker) which bears, North 08 degrees 05 minutes 48 seconds East a distance of 3.39 feet, and;
2. North 26 degrees 56 minutes 38 seconds East a distance of 82.67 feet to the place of beginning, containing 0.5568 acre, more or less, and subject to the right-of-way of Township Road 241 and all easements of record.

All 5/8" X 30" iron pins with plastic identification caps set are stamped "Seymour & Associates".

The bearings used in the above described tract were based on the south line of Tract 12 in the "Elmer Tom's Long-View Addition" as recorded in Plat Envelope 286A as bearing South 86 degrees 04 minutes 10 seconds East and are for the determination of angles only.

The above described tract was surveyed by Seymour & Associates under the direct supervision of Gerald W. Bayha, Ohio Professional Surveyor No. 6139, October 20, 1997 and revised on March 8, 1999.

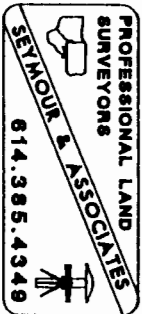

Gerald W. Bayha
 Gerald W. Bayha, P.S. #6139

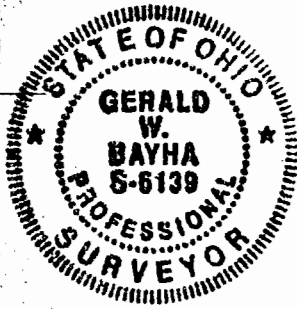

Description checked for
 Mathematical Accuracy
 ATHENS COUNTY
 ENGINEER'S OFFICE
 By: *S. Blanton*
 DATE: *3-9-99*

105

PROFESSIONAL LAND SURVEYORS

- URBAN LOTS & FARM SURVEYS
- CONSTRUCTION STAKEOUT
- OIL WELL PERMITTING
- LAND PLANNING
- SUBDIVISIONS
- AERIAL
- GPS

SEYMOUR & ASSOCIATES



Voice: 614.385.4349 - Fax: 614.385.5954
830 W. Hunter St., P.O. Box 624, Logan, OH, 43138-0624

PLAT OF SURVEY

Situate in Farm or Lease Lots 167 & 126 (Sections 33 & 27).
Town-9-North. Range-14-West.
Athens Township. Athens Co..
State of Ohio. U.S.A..
North America. Earth.

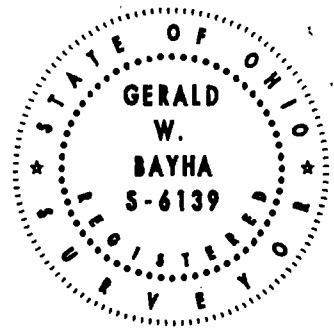

DATE: 10.20.97

BY:

FOR: Steven W. & Kim A. McKinley

REVISIONS: 03.08.99 : Adj. Prop. Owner Tr. Parcel Revised

PROJ. NO.: AT9705

26084K

