

Exhibit A
0.012 Acres

Description of a tract of land situate Grandview Highland Addition to the City of Athens, Ohio;
Being more fully described as follows:

Being part of Lot 2515 of said Grandview Highland Addition, and being deeded to Scott Paul and
Marjorie Ann Malcom Trustees, and being referenced in Official Record Book 382, page 0209.

Beginning at an iron pin found at the southeast corner of Lot 2515 of said Grandview Highland Addition;

- 1.) Thence N84°47'00"W 105.00 along the south line of Lot 2515, and being the north line of Lot 2514 to
an iron pin found;
- 2.) Thence N05°00'00"E 5.00 feet along the east right-a-way of Utah Place, and being along the west line
of Lot 2515 to an iron pin set;
- 3.) Thence S84°47'00"E 105.00 feet over the lands of Malcom 382/0209, and being over the lands of
Lot 2515 to an iron pin set;
- 4.) Thence S05°00'00"W 5.00 feet along the east line of Lot 2515 to the place of beginning containing a
total of 0.012 acres.

Said 0.012 acres is to remain continuous, and contiguous to Lot 2514 of Grandview Highland Addition.

Plat of survey is attached herewith and made a part thereof.

Being subject to all prior easements, rights-of-way, and covenants of record.

Iron Pins set are 30 inch length of number 5 rebar capped NEWMAN PS-8043.

Survey completed by Charles T. Newman, Registered Professional Surveyor 8043 on July 11, 2016.

Charles T. Newman
Charles T. Newman
Registered Professional Surveyor
66 Elmwood Place
Athens, Ohio 45701



Legal Description Pre-Approval
APPROVED
All transfers are subject to
Athens County Conveyance Standards

JUL 18 2016

Jill Thompson
Athens County Auditor

C. TIM NEWMAN

Professional Surveyor

66 Elmwood Place
Athens, Ohio 45701

740-594-1884
FAX 740-594-9413



Plat of Survey of 0.012 Acres
Situat Grandview Highland Addition to the City of Athens, Ohio.
Being a part of Lot 2515 as referenced in a deed to
Scott Paul Malcom and Marjorie Ann Malcom Trustees
Official Record 382, page 0209.
Continous and contiguous tract remaining with Lot 2514.

Charles T. Newman
Charles T. Newman
Surveyed July 11, 2016

0.012 Acres
525 sq. ft.

Description Checked for
Mathematical Accuracy
Athens County
ENGINEER'S OFFICE
BY: *Brenda White*
DATE: 7/14/16

Legal Description Pre-Approval
APPROVED
All transfers are subject to
Athens County Conveyance Standards

JUL 18 2016

Jill Thompson
Athens County Auditor

Referenced to a prior survey
Canter Surveying Job 5124

- ⊙ = Iron Pin Found
- = Iron Pin Set

GRAPHIC SCALE



(IN FEET)
1 inch = 40 ft.

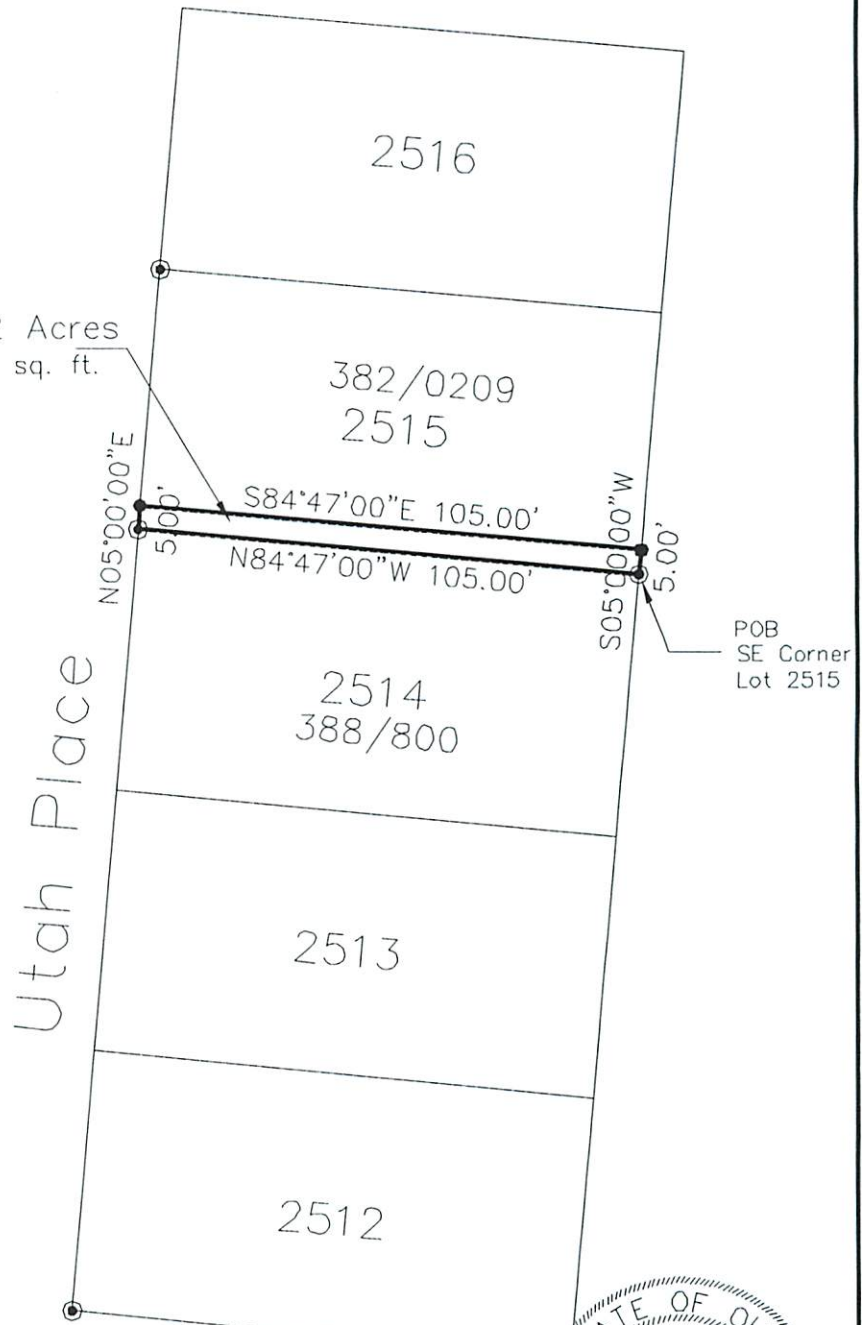



LOTSPLIT/LAND TRANSFER PERMIT

CITY OF ATHENS, OHIO
ATHENS CITY CODE TITLE 23

Permit #: LS16-000031

Issue Date: 07/28/2016

Permit Type: Minor | Issue Date: 07/28/2016

Description: Lotsplit

Approval Conditions/Notes: Your request for a Minor Subdivision Lotsplit is approved in accordance with the Application submitted and Code Title 21.

Location:

Lot: 2515

Township: Athens

Applicant:

Paul Malcom

Phone: 740-274-0353

Property Owner:

Paul Malcom

Phone: 740-274-0353

31 Utah Place
Athens, OH 45701

Surveyor Name: Charles T. Newman

Registration #: 8043

Date property owner originally purchased the property:	05/17/2005
Acreage of original purchase:	
Number and size of parcels subdivided since original purchase:	.012
Acreage of proposed parcel(s) with new plat of survey attached:	.012
Public road frontage of proposed parcel(s): 105'	Residual: 170'
Date of survey of plat of proposed parcel(s):	07/18/2016

Minimum Requirements:

Public Road Frontage: ✓

Engineer's Approval: ✓

Width to Depth Ratio: ✓

Health Department Approval:

Number of Splits Permitted:

Registered Surveyor: ✓

Total Fees: \$80.00

Service-Safety Director recommendation:

Approved

Refused

Paula Horan Moseley
Paula Horan-Moseley
Service-Safety Director

7/28/16
Date