

Eight North Court
An existing four-foot strip
0.009 Acres

Situate Ohio Company Purchase, Town 9, Range 14, Auditor's Section 10,
Athens Township, Athens County, City Lot 18, City of Athens, Ohio.

Being the entirety of an existing parcel deeded to: Eight North Court Street, an Ohio Partnership,
Official Record Book 371, pages 1045-1047 (second parcel) known as parcel A027100005100.

Commencing at the southwest corner of said City Lot 18, said corner being referenced to a brass
monument (2 foot offset) found S48°49'04"W at 2.82 feet;

Thence N03°58'29"E 77.69 feet along the west boundary of Lot 18, and being the easy boundary of
North Court Street to iron pin set at the point of beginning of the parcel herein described;

- 1.) Thence N03°58'29"E 4.00 feet, and continuing along said west boundary of Lot 18 to a point at the
corner of the Security Building;
- 2.) Thence S85°59'27"E 98.00 feet along a common boundary to Eight North Court 371-1045 (Second
Parcel), and the City of Athens 95-67, to an iron pin set at the original northeast corner of the First
Presbyterian Society of Athens, Ohio 150-81;
- 3.) Thence S03°58'29"W 4.00 feet along a common boundary to the City of Athens 95-67 to an iron pin
set;
- 4.) Thence N85°59'27"W 98.00 feet along a common boundary to the First Presbyterian Society of
Athens, Ohio to the point of beginning containing a total of 0.009 acres.

Plat of Survey attached herewith and made a part thereof.

Subject to all easements, rights-of-way, covenants, and agreements of record.

Subject to a reservation: First Presbyterian Society of Athens, Ohio to use said strip as an appurtenance,
and being more fully described in previous deeds.

Iron Pins Set being number 5 rebar, 6-inches in length set in drilled concrete.

Basis of bearings : NAD 83 Ohio South

Survey completed by Charles T. Newman, Licensed Professional Surveyor 8043 on March 16, 2026.



Charles T. Newman PS
66 Elmwood Place
Athens, Ohio 45701

Legal Description Pre-Approval
APPROVED

All transfers are subject to
Athens County Conveyance Standards

APR 01 2026

Jill Davidson
Athens County Auditor

Description Checked for
Mathematical Accuracy
Athens County
ENGINEER'S OFFICE
BY: 
DATE: 4/1/26

C. TIM NEWMAN

Professional Surveyor

66 Elmwood Place
Athens, Ohio 45701

740-594-1884
FAX 740-594-9413

Plat of Survey of a four feet wide existing parcel of real estate with an area of 0.009 Acres
Situate Ohio Company Prurchase, Town 9, Range 14, Athens City Lot 18,
Athens Township, Athens County, City of Athens, Ohio
Parcel A027100005100

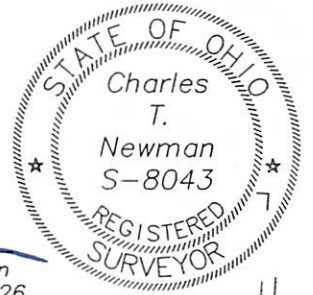

Charles T. Newman
Charles T. Newman
Surveyed March 2026

16 University Rentals 580-1883

16 15 EMHT Survey 1983

18
A027100005100
Eight North Court
371-1045 2nd parcel

Description Checked for
Mathematical Accuracy
Athens County
ENGINEER'S OFFICE
BY: *James Hill*
DATE: 4/1/26

City of Athens
373-797

EMHT Survey 1983

(392 sq. ft.)
0.009 Acres

City of Athens
95-67

EMHT Survey A0-748

4 feet wide strip as an appurtenance

Presbyterian Church
150 -81

SW Corner Lot 18
N484388.3
S2081345.6

Eight North Court
passageway right

Buckley Survey 2019

LINE TABLE		
LINE	BEARING	LENGTH
L1	N03°58'29"E	4.00'
L2	S85°59'27"E	98.00'
L3	S03°58'29"W	4.00'
L4	N85°59'27"W	98.00'

North Court Street

N 03°58'29" E
77.69'

N 85°59'27" W 337.08' Monument to Monument (2' offsets)

Monument to Corner
N 48°49'04" E 2.82'

East Washington Street

GRAPHIC SCALE



(IN FEET)
1 inch = 30 ft.

Prior Surveys and Deeds reviewed as noted on Plat,
City Block Corners Plat 1897, Envelope 162B, and
Auditor's Tax Plat 0-24.

- ⊙ Brass Monument Found
- ⊙ Brass Plug Found 1" OD
- Iron Pin Set in Concrete #5 Rebar
- △ Pipe Found 3/4" OD