

Jun. 03 1994 10:49AM P02

PHONE No. : 614 593 8220

From : CITY COUNCIL



*0.134 / 1769 sq ft.
0.437 / 5771 sq ft.*

CENTRAL AVENUE

N 01°18'22"E
104.23'

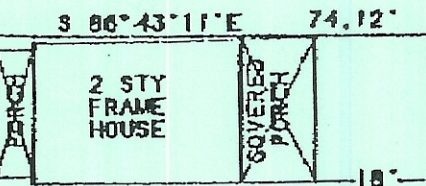

7540 SQ.FT.

*O.L. 134
O.L. 437*

S 02°18'21"W
101.81'

PROPOSED PROPERTY LINE

SECOND STREET

S 86°43'11"E
140.00'

14230 SQ.FT.

N 86°36'10"W
72.30'

YOUNG

N 86°25'27"W
138.62'

DOTSON

15' ALLEY

S 03°05'13"W
102.51'

FROST

112.5'

112.5'

2/47
2/48



SCALE 1 INCH = 30 FEET
● - IRON PIN FOUND

PROPOSED LOT SPLIT IN
OUT-LOT 134 AND OUT-LOT 437
IN THE CITY OF ATHENS, OHIO
SURVEYED NOV. 1993

John M. Branner
JOHN M. BRANNER P.S. 6805
12500 N. PEACH RIDGE ROAD
ATHENS OHIO 614-592-5778

*2,550 sq ft.
2,550 sq ft.*

mm

mm