

Description Checked for  
Mathematical Accuracy  
Athens County  
ENGINEER'S OFFICE  
BY: Robert Miller  
DATE: 1/31/19

Exhibit A  
2.894 Acres

Description of a tract of land situate Ohio Company Purchase, Town 9, Range 14, Farm Lot 137, (Section 28) Athens Township, Athens County, Ohio, and being more fully described as follows: Being the lands deeded to Travis G. Jeffers, Official Record Book 545, pages 617-619. Auditor Parcel A040020035900.

Commencing at the northwest corner of Farm Lot 194 and a northeast corner of Farm Lot 137; Thence N86°36'15"W 1500.86 feet to an iron pin found in the roadway of a private road and being the point of beginning of the parcel herein described;

- 1.) Thence S16°59'24"E 388.70 feet along a common boundary to Jeffers 545-617 and Ryan 316-359 to an iron pin set, at the intersection of a private road and Township Road 610;
- 2.) Thence N87°18'34"W 415.80 feet along a common boundary to Jeffers and Skinner 357-243 to an iron pin found;
- 3.) Thence N04°54'38"E 369.60 feet along a common boundary to Jeffers and Perry 537-122 to an iron pin set;
- 4.) Thence S86°36'15"E 270.60 feet along a common boundary to Jeffers and Mackie 296-2168 to the point of beginning containing a total of 2.894 acres.

A private road exists along the eastern boundary of the 2.894 acres.

An easement of 30.00 feet in width is further described in a deed to Patti Perry, Official Record Book 537, page 122.

Plat of survey is attached herewith and made a part thereof.

Being subject to all prior easements, rights-of-way, and covenants of record.

Basis of Bearings the denoted boundary of Farm Lot 137 and a True Meridian has not been determined.

Iron Pins set are 30-inch length of number 5 rebar capped NEWMAN PS-8043.

Survey completed by Charles T. Newman, Registered Professional Surveyor 8043 on January 31, 2019.

  
Charles T. Newman  
Registered Professional Surveyor  
66 Elmwood Place  
Athens, Ohio 45701

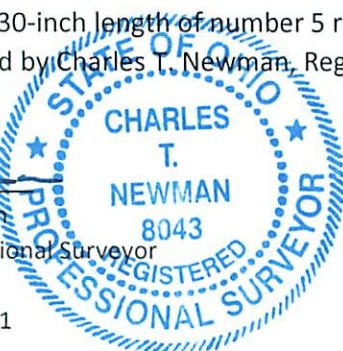

Description Approved  
Jill A. Thompson  
Athens County Auditor

C. TIM NEWMAN  
Professional Surveyor

66 Elmwood Place  
Athens, Ohio 45701

740-594-1884  
FAX 740-594-9413



Plat of Survey of 2.894 Acres  
Situating Ohio Company Purchase Town 9, Range 14,  
Lease Lot 137, (Section 28) Athens Township, Athens County, Ohio.  
Being lands deeded to Travis G. Jeffers  
Official Record Book 545, pages 617-619.  
Auditor Parcel A040020035900

Basis of Bearings  
Denoted North Line of Farm Lot 137  
A True Meridian as Not been Determined

- ▲ Iron Pin Found # 5 Rebar
- ▲ Fence Post
- Iron Pin Found capped PRICE
- Iron Pin Set capped NEWMAN
- Stone Found
- ⊙ ODOT Monument Found

Description Checked for  
Mathematical Accuracy  
Athens County  
ENGINEER'S OFFICE  
BY: *Brian Putnam*  
DATE: *1/31/19*

GRAPHIC SCALE



( IN FEET )  
1 inch = 300 ft.

