

ATH NELSONVILLE BIKEPATH

CITY OF NELSONVILLE
ATHENS COUNTY, OHIO

P.I.D. # 81809
FEDERAL PROJECT NO. E060908

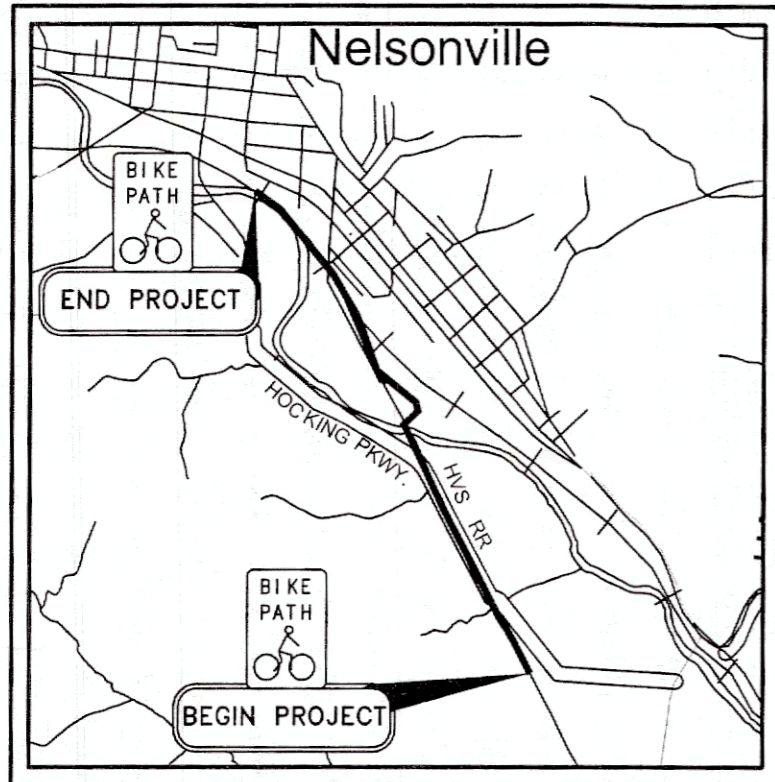

LOCATION MAP

1" = 1/4 MILE SCALE



INDEX OF SHEETS

TITLE SHEET	1
TYPICAL BIKEWAY SECTIONS	2-3
GENERAL NOTES	4
GENERAL SUMMARY	5
PLAN & PROFILE	6-20
PLAN - TURNOUT RELOCATION	21
CROSS SECTIONS	22-32
PLAN - EX. BRIDGE STRUCTURE	33
CROSS SECTION BRIDGE DETAIL	34
BIKEWAY RAILING DETAIL	35

PROJECT DESCRIPTION

Extend the Hockhocking Adena bikeway from the existing terminus on the SE side of Hocking College approximately 1.5 miles north.

2005 SPECIFICATIONS

The standard specifications of the State of Ohio, Department of Transportation, including changes and supplemental specifications listed in the proposal, shall govern this improvement.

CITY OFFICIALS

MARK HALL
ANITA MONDO
SUE POWELL
AILEEN LEHMAN
GARRY HUNTER

CITY MANAGER
PRESIDENT OF COUNCIL
TREASURER
AUDITOR
CITY SOLICITOR

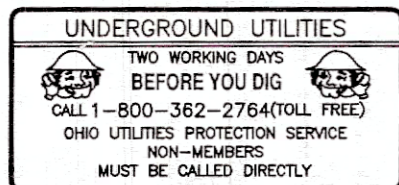

Signed _____

Date _____



RRX
P 18 & 19

PLANS PREPARED & SUBMITTED BY:

RJM ENGINEERING COMPANY
66 S. PLAINS RD.
THE PLAINS, OHIO 45780
PHONE: 740-797-0500

ODOT STANDARD DRAWINGS		SUPPLEMENTAL SPECIFICATIONS
F-1.1	7/16/04	SS-800 4/20/07
LA-1.1	7/28/00	SS-832 4/25/06
HW-2.2	4/21/06	

ORDINANCE _____ DATE _____

APPROVED _____ DATE _____
NELSONVILLE CITY MANGAER

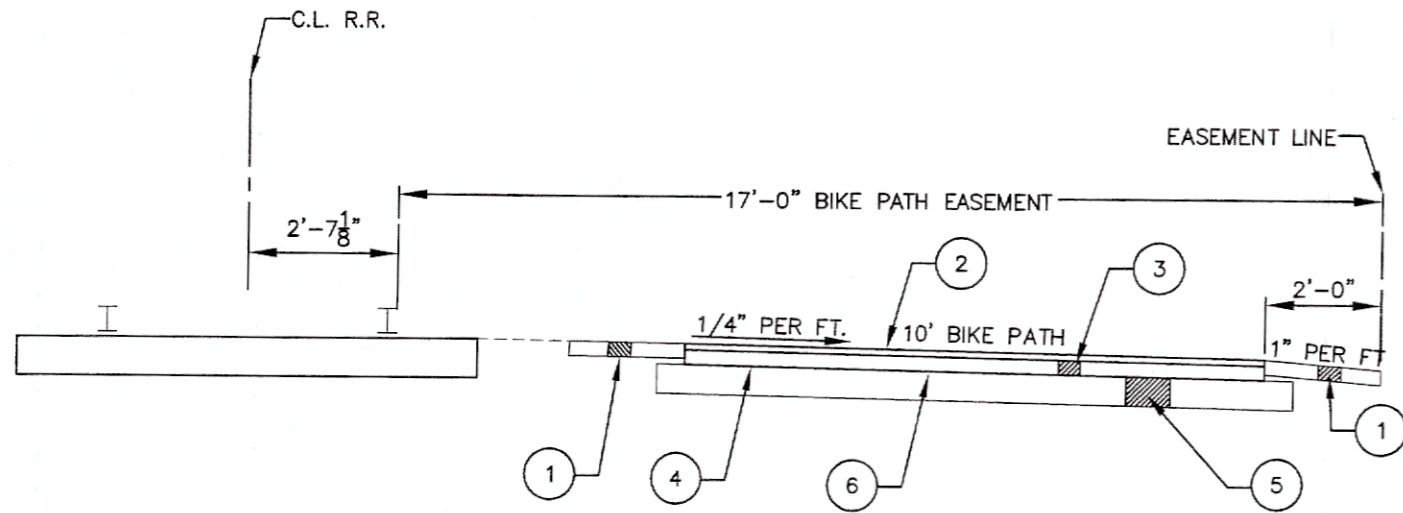

PROPOSED TYPICAL SECTION

STA. 0+00 TO STA. 37+38.95

- LEGEND**
1. ITEM 304 - 3" AGGREGATE BASE, BERMS
 2. ITEM 448 - 1.25" ASPHALT CONCRETE SURFACE COURSE, TYPE 1, PG64-28
 3. ITEM 301 - 3" ASPHALT CONCRETE BASE, PG64-22
 4. ITEM 408 - PRIME COAT (0.4 GAL/SY)
 5. ITEM 304 - 6" AGGREGATE BASE
 6. ITEM 204 - SUBGRADE COMPACTION

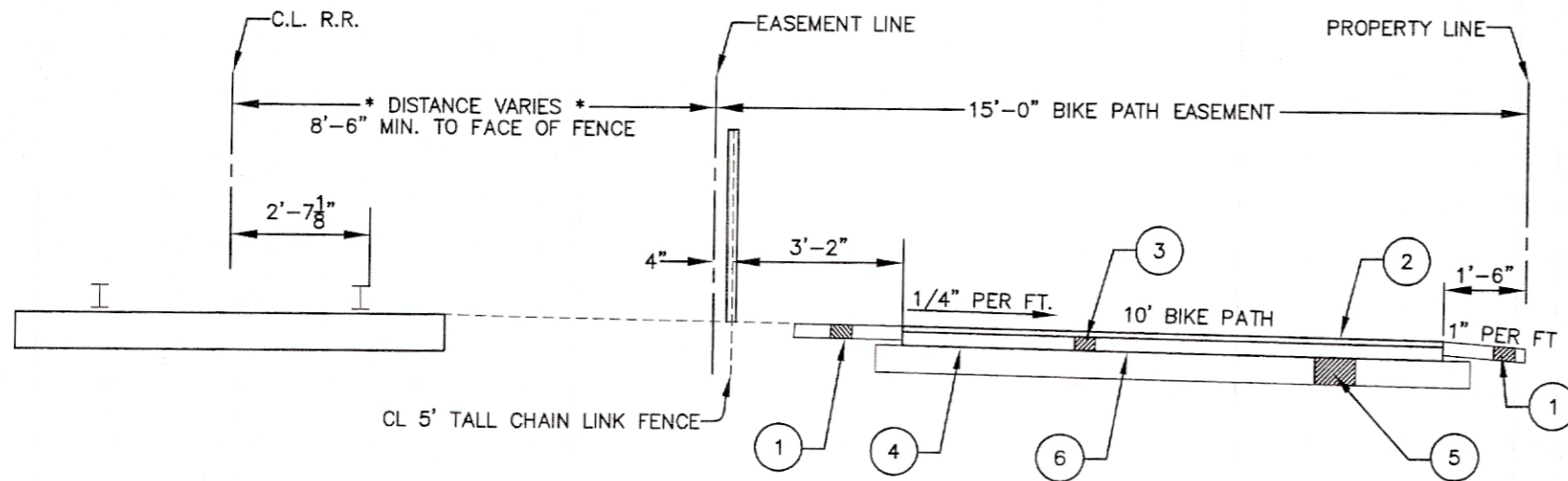

PROPOSED TYPICAL SECTION

STA. 42+91.77 TO STA. 59+49.27

ITEM	DESCRIPTION	BIKE PATH BASE BID	
		AREA (SY)	VOLUME
1	3" Aggregate Base, Berms (304)--PER CU.YD.	1185	395
2	1.25" Asphalt Concrete Surface Course, Type 1, PG64-28 (448)--PER CU.YD.	0	280
2A	1.75" Asphalt Concrete Interm. Course, Type 2, PG64-28 (448)--PER CU.YD.	-----	-----
3	3" Asphalt Concrete Base, PG64-22 (301)-- PER CU.YD.	0	672
4	Prime Coat (408)--Per GALLON	-----	0
5	8" Aggregate Base (304)--PER CU.YD.	0	1873
6	Subgrade Compaction (204)--PER SQ.YD.	8384	-----
7	Variable Thickness Berm (304)--PER CU.YD.	0	0

[PLOT] Z:\LAND PROJECTS 2007\NELSONVILLE BIKE PATH EXTENSION.DWG - JUN 21, 2007 - 10:44:53 - PLOT: 1=1

TYPICAL BIKEWAY SECTIONS

ATH NELSONVILLE BIKEPATH

DESIGNED BY: RHM ENGINEERING CO.
 66 S. PLAINS RD.
 THE PLAINS, OHIO 45780
 DATE: 06/15/07
 DRAWN: DWR/DEB
 CHECKED: [blank]
 CITY OF NELSONVILLE
 217 LAKE HAZE DRIVE
 NELSONVILLE, OHIO 45764

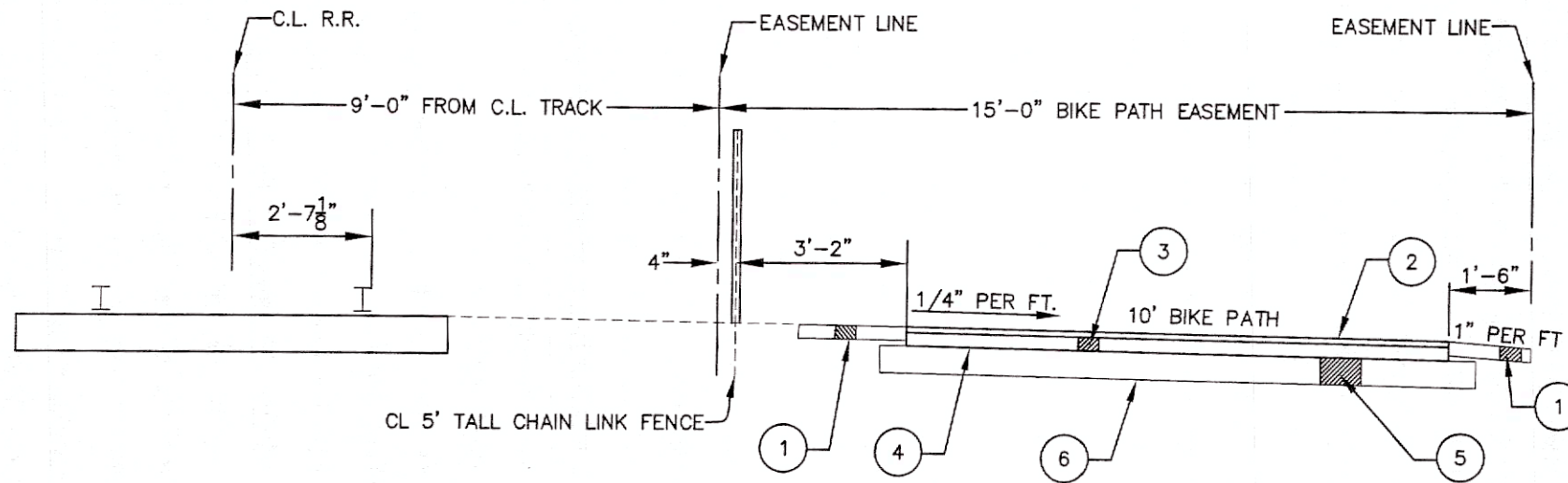

LEGEND

1. ITEM 304 - 3" AGGREGATE BASE, BERMS
2. ITEM 448 - 1.25" ASPHALT CONCRETE SURFACE COURSE, TYPE 1, PG64-28
3. ITEM 301 - 3" ASPHALT CONCRETE BASE, PG64-22
4. ITEM 408 - PRIME COAT (0.4 GAL/SY)
5. ITEM 304 - 6" AGGREGATE BASE
6. ITEM 204 - SUBGRADE COMPACTION

PROPOSED TYPICAL SECTION

STA. 60+52.50 TO STA. 63+98.39
 STA. 64+34.77 TO STA. 78+01.94

[R:\LAND PROJECTS 2007\NELSONVILLE BIKE PATH EXTENSION.DWG\61606GPOD.DWG - JUN 21, 2007 - 10:44:40 - PLOT: 1-1

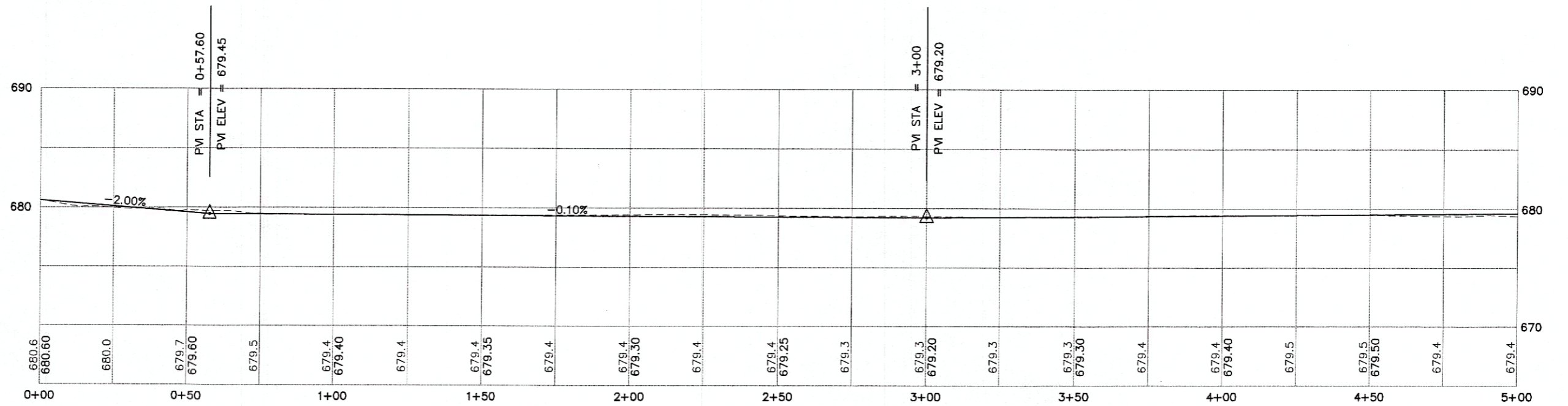
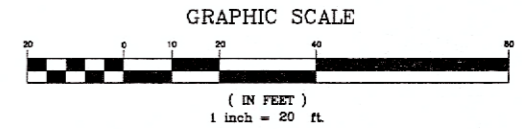
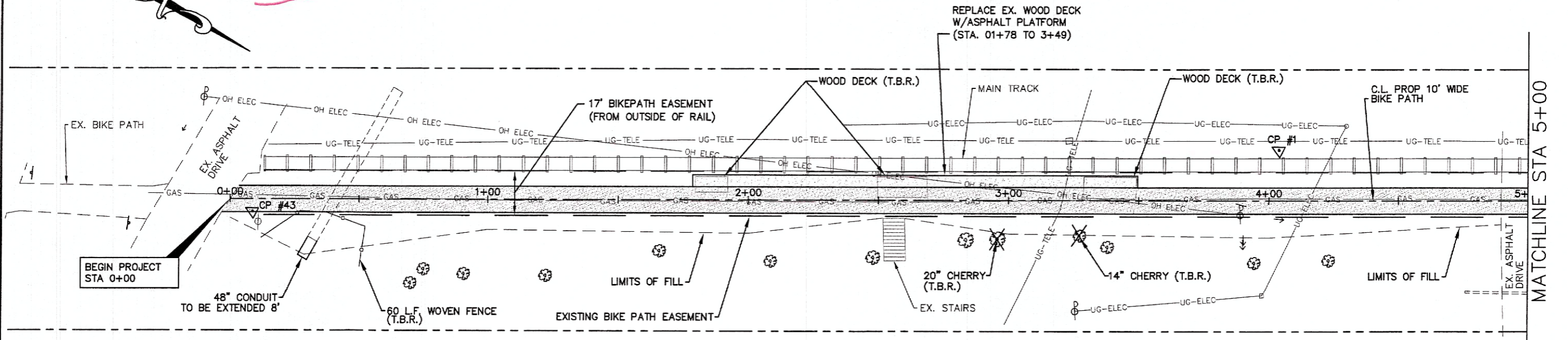
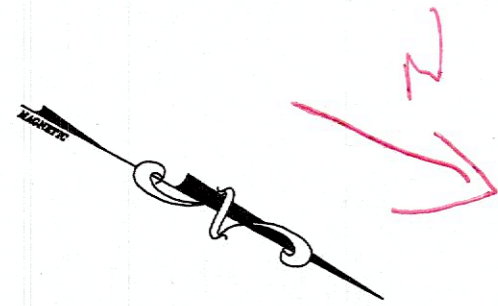

PLAN + PROFILE
STA. 0+00 to STA. 5+00

ATH NELSONVILLE BIKEPATH

6/35

DESIGNED BY: RALPH ENGINEERING CO.
DATE: 06/16/07
CHECKED BY: PLAM
DATE: 06/16/07
CITY OF NELSONVILLE
211 LAKE HURON
NORWALDEN, OH 43074

[R:\M] Z:\LAND PROJECTS 2007\NELSONVILLE BIKE PATH EXTENSION.DWG 81806P001.DWG - JUN 21, 2007 - 10:44:50 - PLOT: 1=1

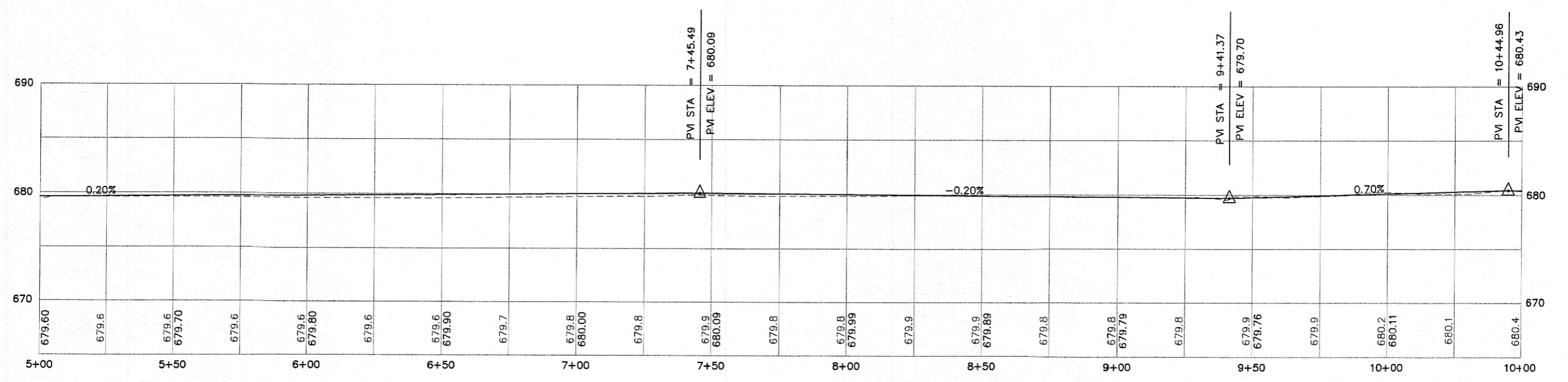
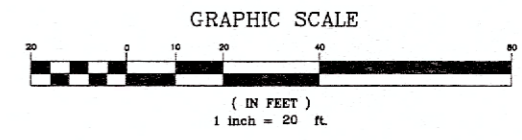
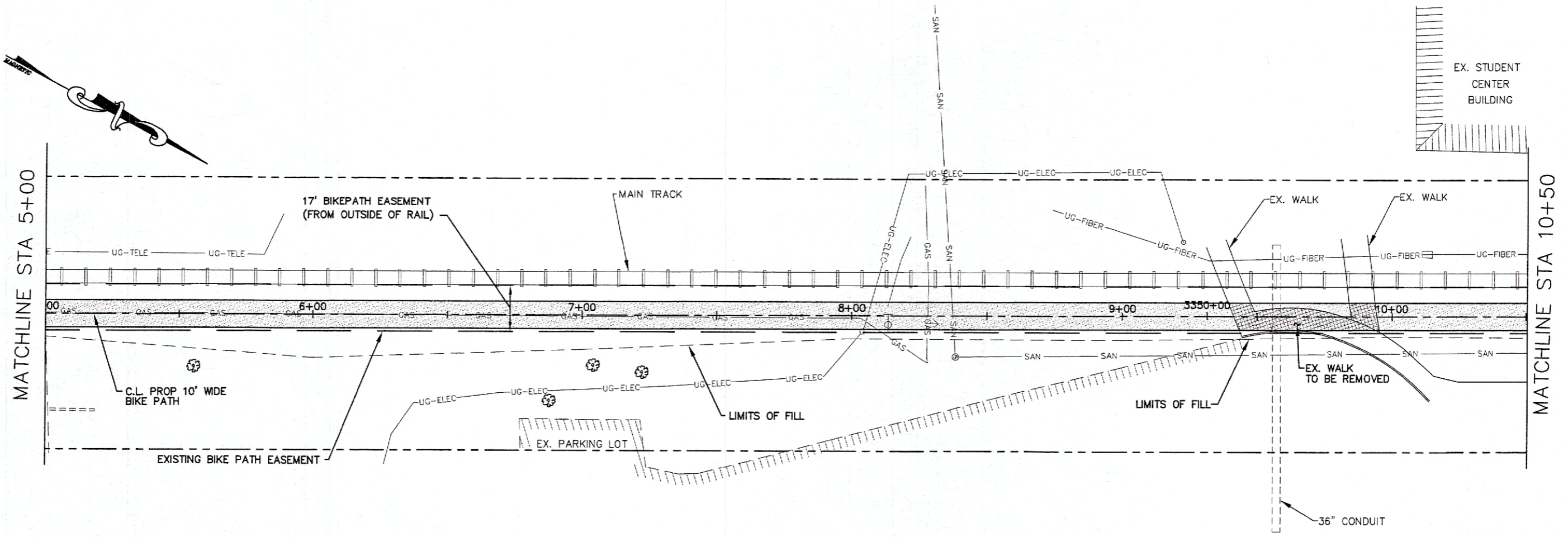

DESIGNED BY
 DESIGNED DATE
 CHECKED DATE
 APPROVED DATE

PROJECT NO.
 DATE
 CITY OF NELSONVILLE
 211 LINE WARE DRIVE
 NELSONVILLE, OHIO 45704

PLAN + PROFILE
 STA. 5+00 TO STA. 10+50

ATH NELSONVILLE BIKEPATH

[R:\M] 2 LAND PROJECTS 2007\NELSONVILLE BIKE PATH EXTENSION\DWG\1806P001.DWG - JUN 21, 2007 - 10:44:40 - PLOT: 1-1

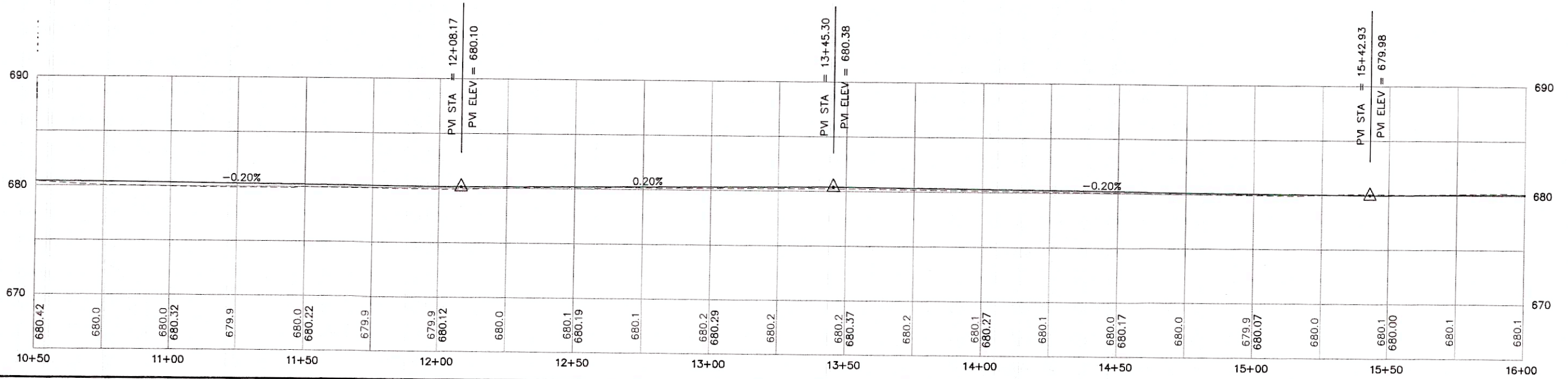
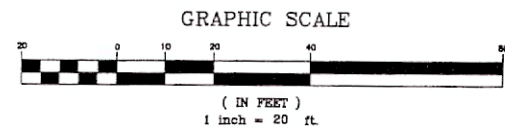
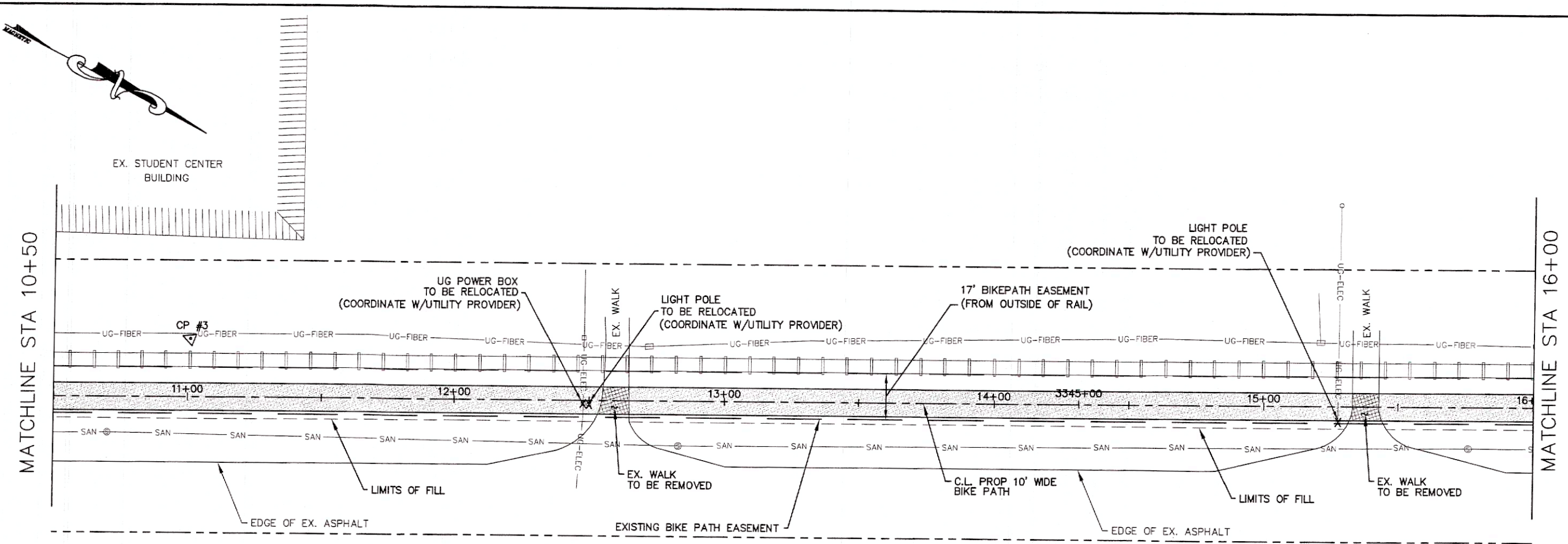

Designed by
RAJ ENGINEERING CO.
26 S. PLAINS RD.
THE PLAINS, OHIO 43080

PROJECT NO.
81800
DATE
06/16/07

DESIGNED BY
DEB/DWR
CHECKED BY

DRAWN BY
FLM
CHECKED BY

CHECKED BY
CITY OF NELSONVILLE
211 LAKE HURON DR
NELSONVILLE, OHIO 45764

PLAN + PROFILE
STA. 10+50 to STA. 16+00

ATH NELSONVILLE BIKEPATH

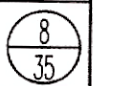

Z:\LAND PROJECTS 2007\NELSONVILLE BIKE PATH EXTENSION\DWG\81806P001.DWG - JUN 21, 2007 - 10:44:00 - PLOT: 1-1

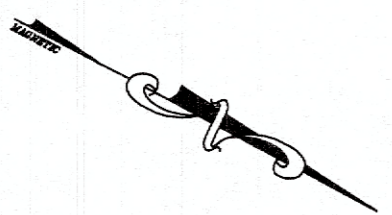

CP #42
CANTER HC596

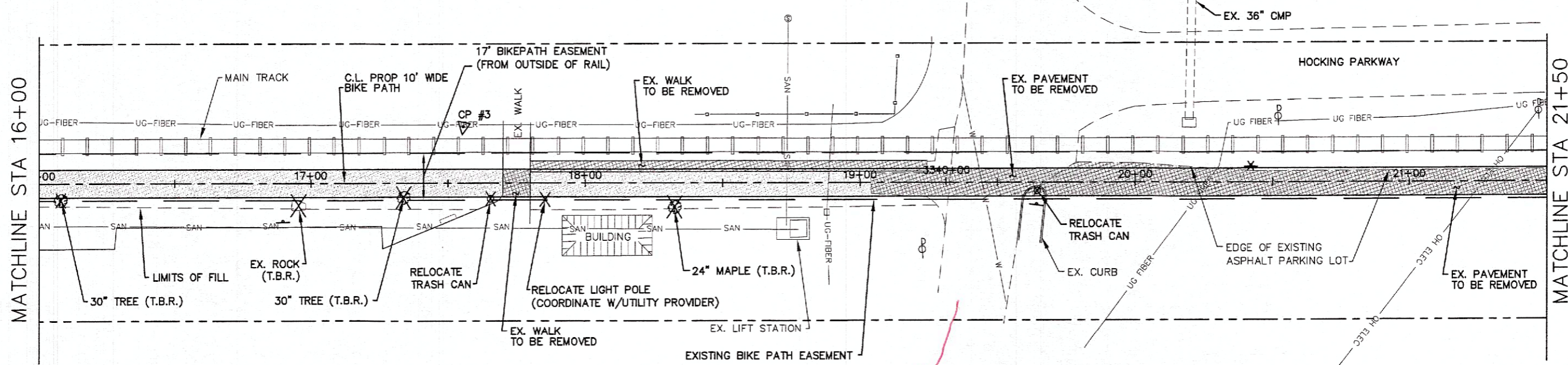

*Hocking
Plan*

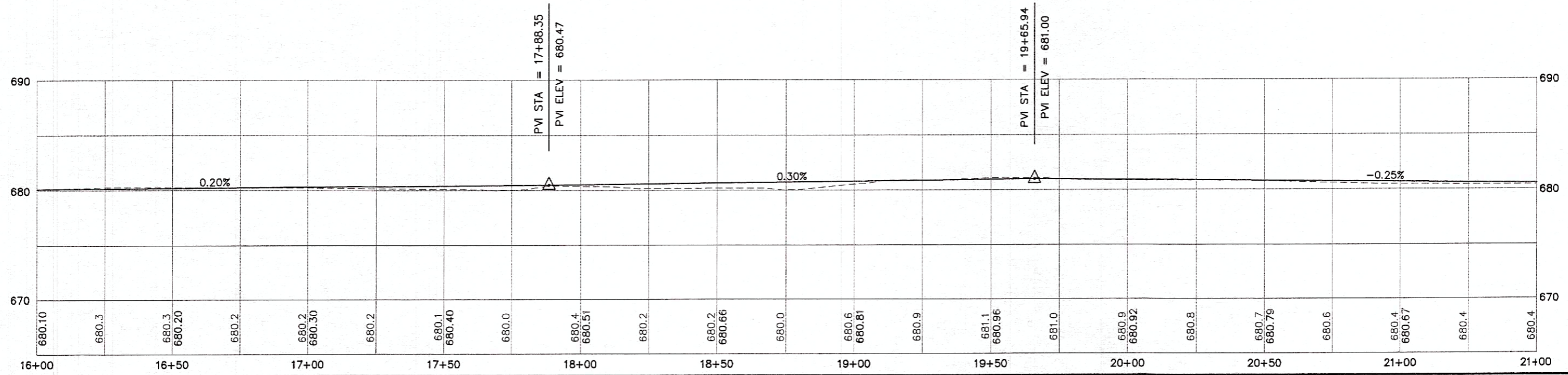
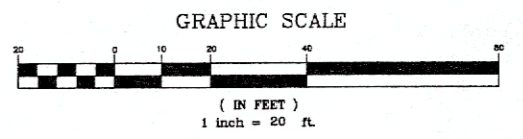

ATH NELSONVILLE BIKEPATH	PLAN + PROFILE STA. 16+00 to STA. 21+50	DESIGNED BY RLM ENGINEERING CO. 66 S. PLAINS RD. THE PLAINS, OHIO 43084
DATE 08/15/07	DRAWN DEB/DWR	CHECKED RLM
CITY OF NELSONVILLE 211 LAKE HURON DRIVE NELSONVILLE, OHIO 43084	PROJECT NO. 81806	SHEET NO. 01

[[RAM]] Z:\LAND PROJECTS 2007\NELSONVILLE BIKE PATH EXTENSION\DWG\81609GPOD1.DWG -- JUN 21, 2007 -- 10:44:00 -- PLOT: 1-1

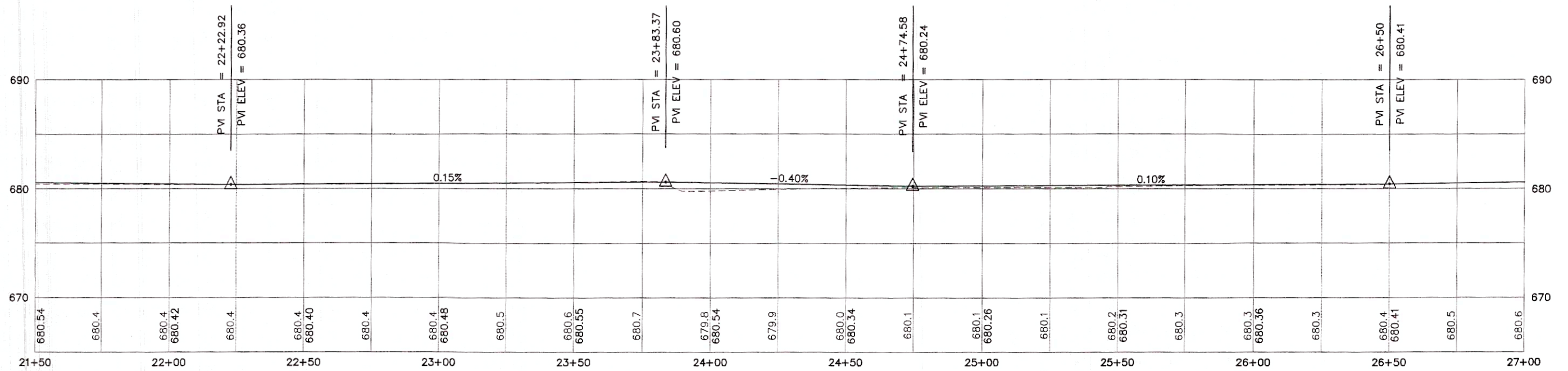
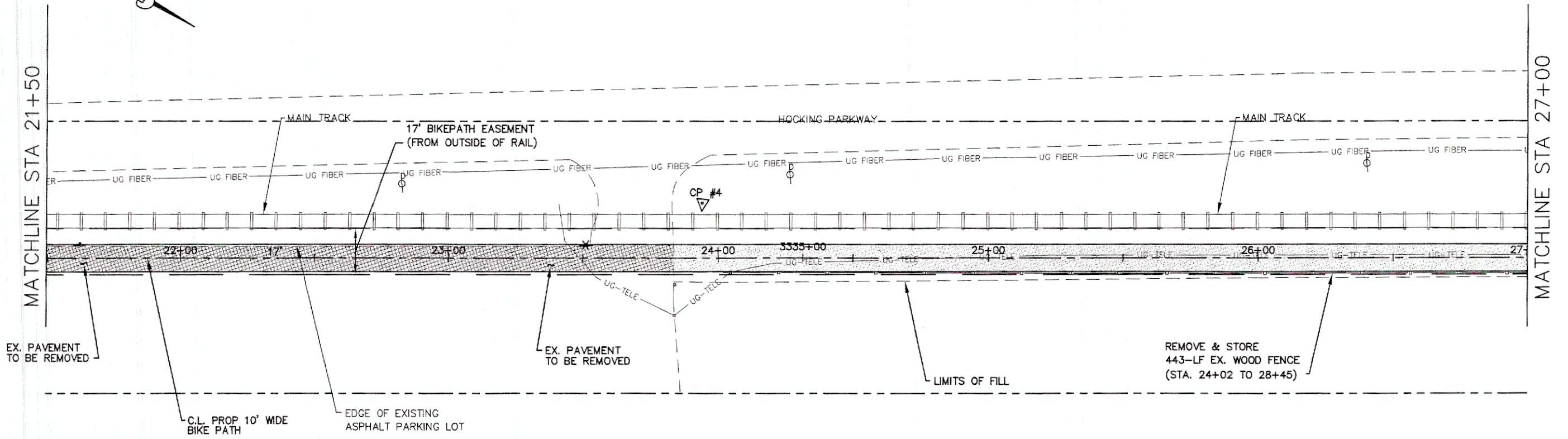
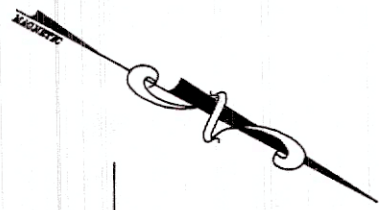

PLAN + PROFILE
STA. 21+50 to STA. 27+00

ATH NELSONVILLE BIKEPATH

[RAW] Z:\LAND PROJECTS 2007\NELSONVILLE BIKE PATH EXTENSION.DWG - JUN 21, 2007 - 10:44:00 - PLOT: 1-1

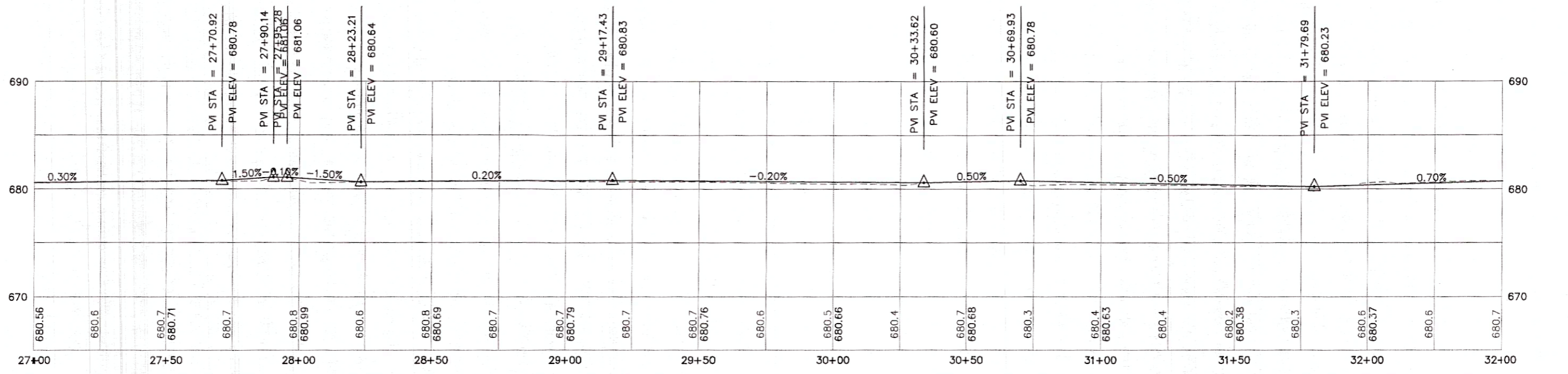
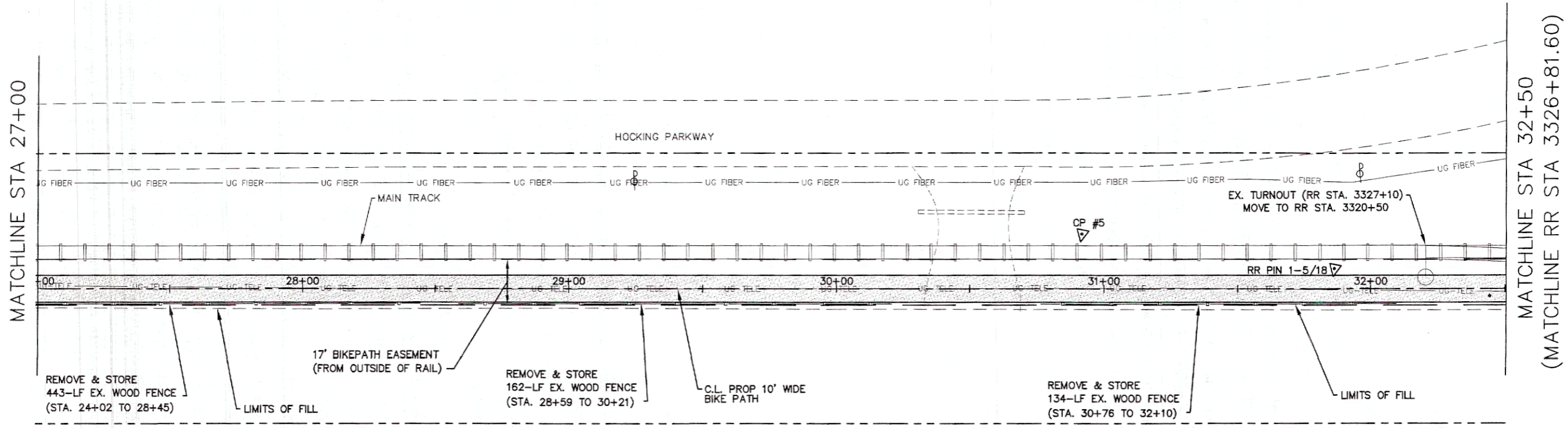

DESIGNED BY RLM ENGINEERING CO. 66 S. PLAINS BL. THE PLAINS, OHIO 43080	DATE 06/16/07
DRAWN BY DEB/DWR	CHECKED BY [Blank]
PROJECT CITY OF NELSONVILLE 211 LAKE HOPKINS DRIVE NELSONVILLE, OHIO 45741	TITLE PLAN + PROFILE STA. 27+00 to STA. 32+50
ATH NELSONVILLE BIKEPATH	

[[RJM]] Z:\LAND PROJECTS 2007\NELSONVILLE BIKE PATH EXTENSION\DWG\B1806P001.DWG - JUN 21, 2007 - 10:44:50 - PLOT: 1=1

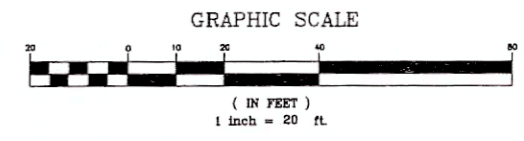
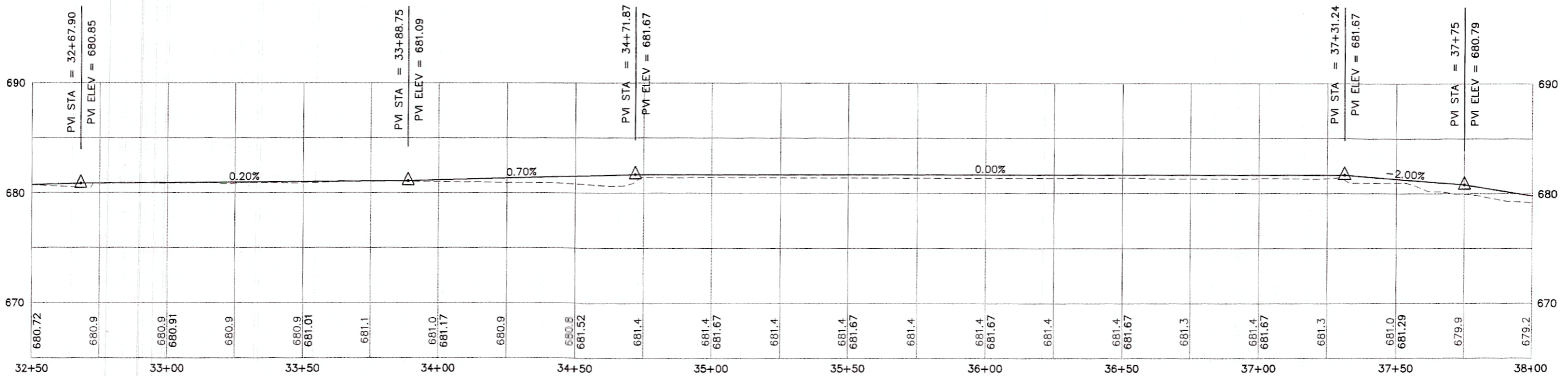
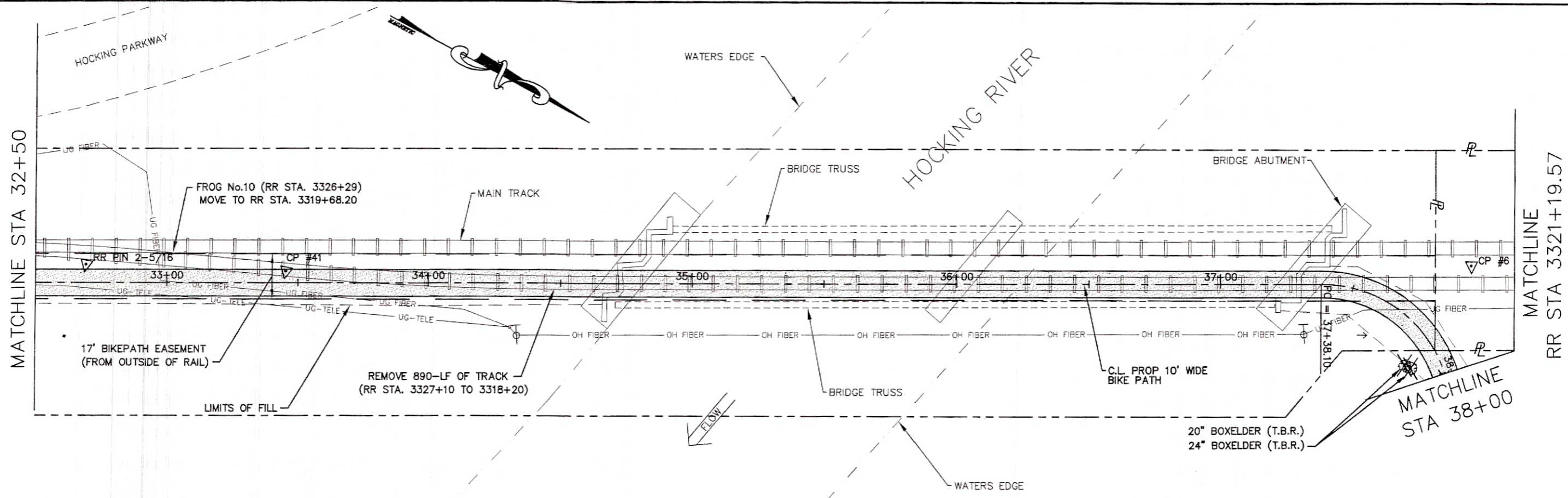

MATCHLINE STA 32+50

MATCHLINE STA 3321+19.57

MATCHLINE STA 38+00

Designed by
DAVID ENGINEERING CO.
28 S. PLAINS RD.
THE PLAINS, OHIO 43084

NO. 1
91600
DATE
08/15/07

DESIGNED BY
DES/DWR
REVIEWED

CHECKED BY
FLM
CHECKED

DATE
CITY OF NELSONVILLE
211 LANE NORTH AVE.
NELSONVILLE, OHIO 45741

PLAN + PROFILE
STA. 32+50 to STA. 38+00

ATH NELSONVILLE BIKEPATH

12
35

[[PLM]] Z:\LAND PROJECTS 2007\NELSONVILLE BIKE PATH EXTENSION\DWG\81809CP001.DWG - JUN 21, 2007 - 10:44:50 - PLOT: 1-1

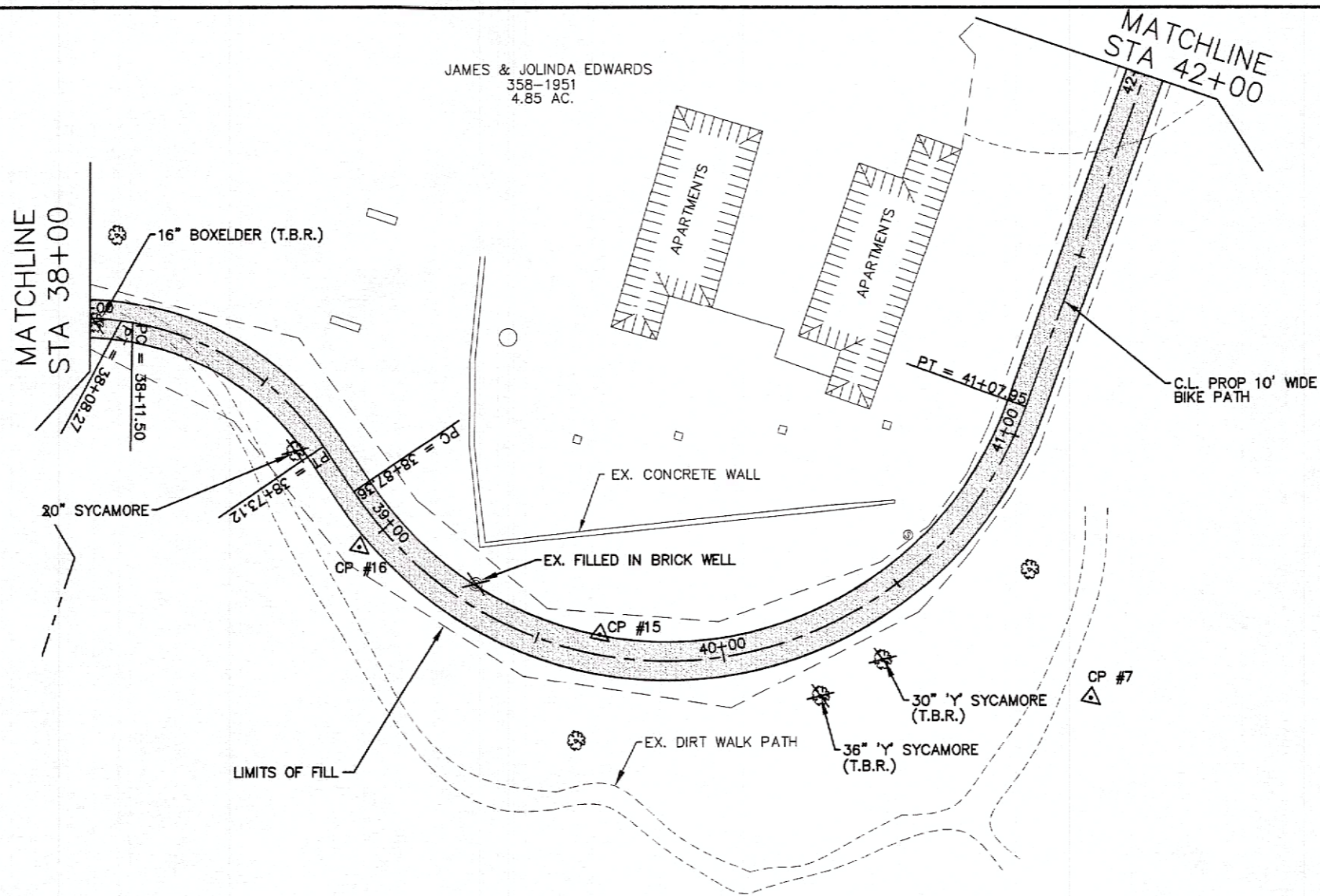
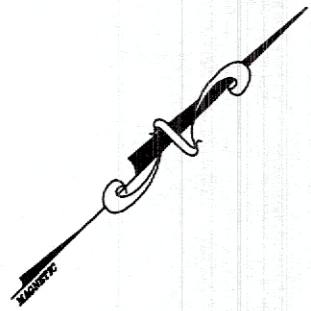

JAMES & JOLINDA EDWARDS
358-1951
4.85 AC.

MATCHLINE
STA 42+00

MATCHLINE
STA 38+00

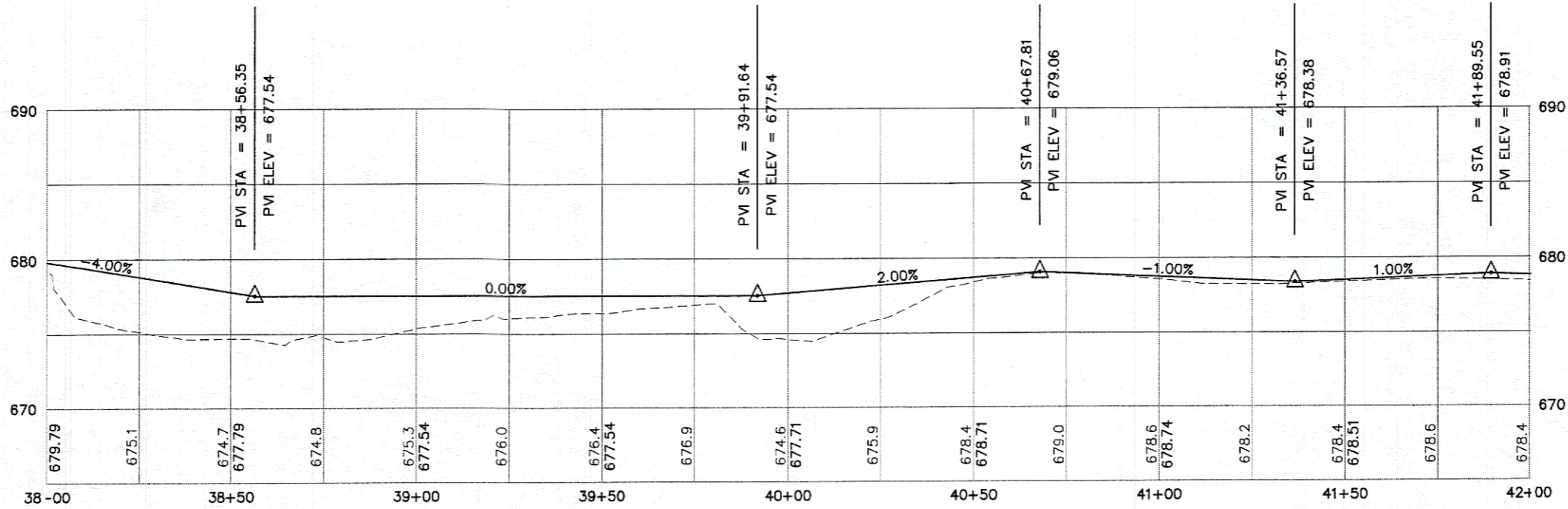
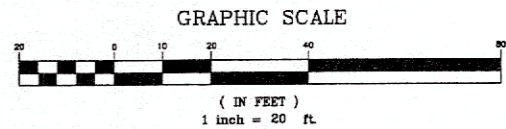

ATH NELSONVILLE BIKEPATH	PLAN + PROFILE STA. 38+00 to STA. 42+00	Drawn by RAM ENGINEERING CO. 68 S. PLANS RD. THE PLAINS, OHIO 45780
		Project No. 81809
		Date 06/15/07
		Designer DEB/DWR
		Checker FLM
		City of Nelsonville 211 LAKE HOP DRIVE NELSONVILLE, OHIO 45764

[[PLN]] Z:\LAND PROJECTS 2007\NELSONVILLE BIKE PATH EXTENSION\DWG\181809P001.DWG - JUN 21, 2007 - 10:44:50 - PLOT: 1=1

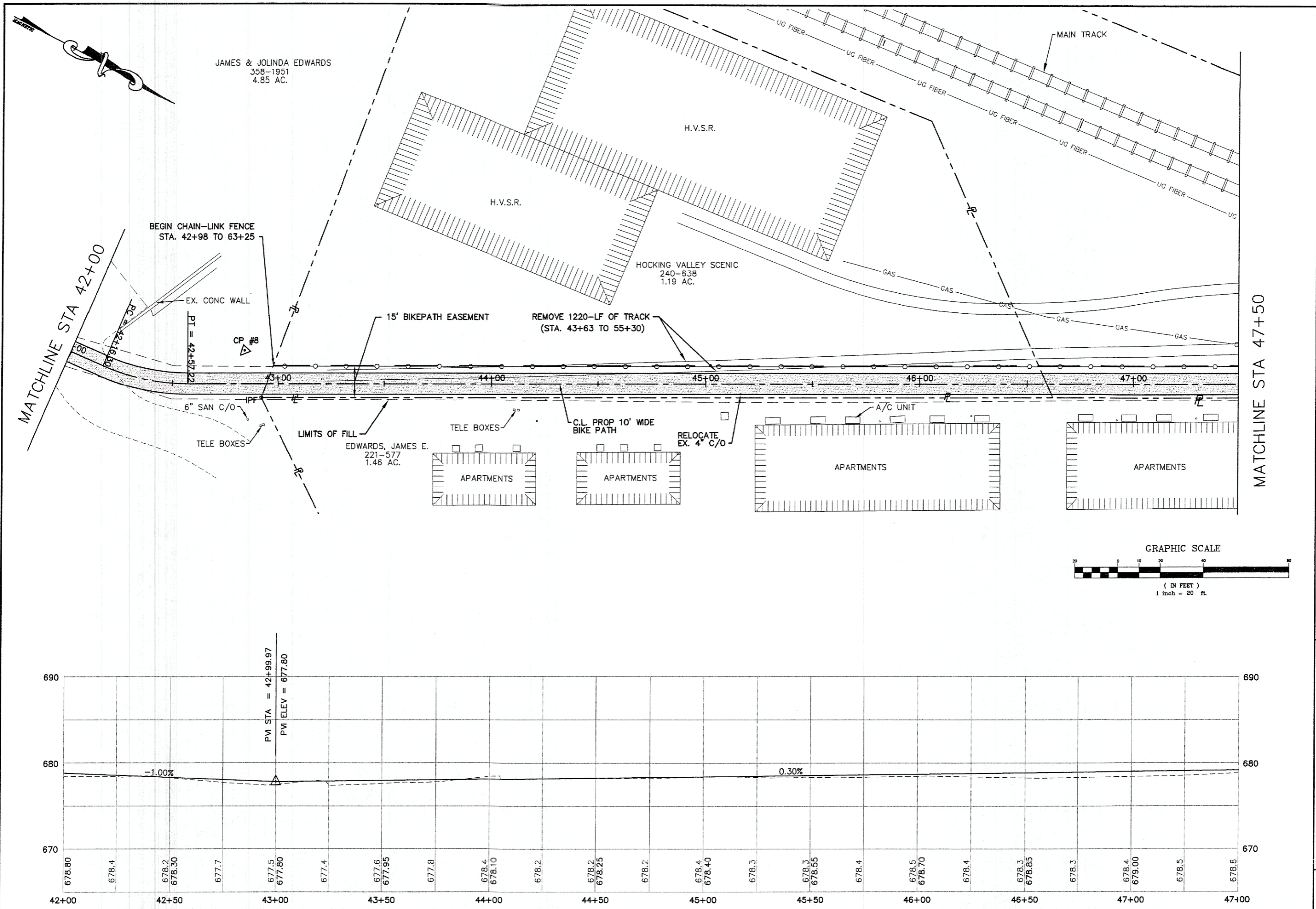

JAMES & JOLINDA EDWARDS
358-1951
4.85 AC.

DESIGNED BY	RAJ ENGINEERING CO.
DATE	06/16/07
DESIGNED	P.M.
CHECKED	
DATE	06/16/07
PROJECT	81809
DATE	06/16/07
PROJECT	81809
DATE	06/16/07
PROJECT	81809
DATE	06/16/07

PLAN + PROFILE
STA. 42+00 to STA. 47+50

ATH NELSONVILLE BIKEPATH

[[RJMJ]] Z:\LAND PROJECTS 2007\NELSONVILLE BIKE PATH EXTENSION\DWG\018006P001.DWG - JUN 21, 2007 - 10:44:50 - PLOT: 1=1

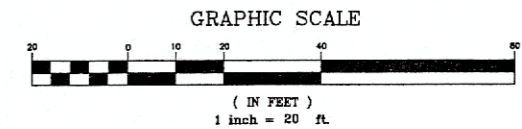
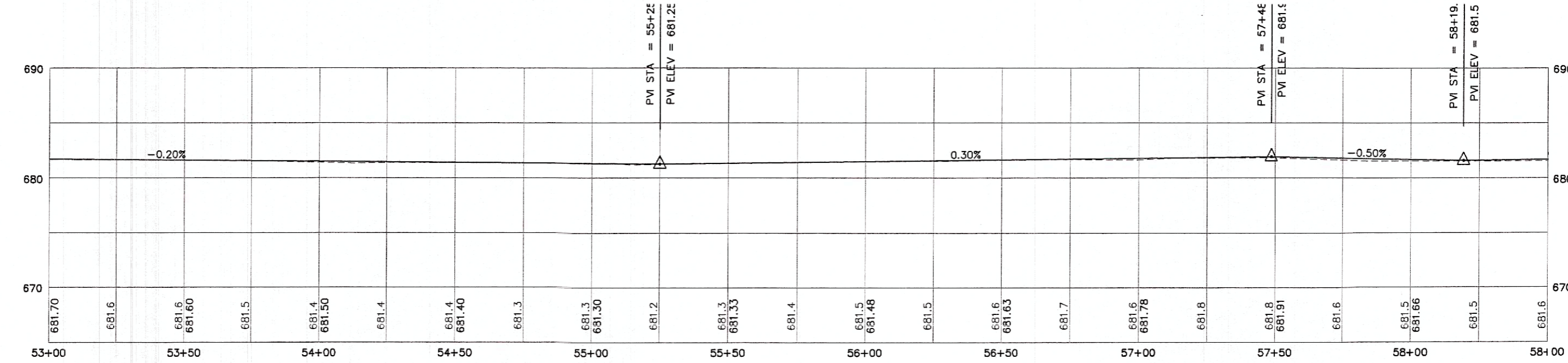
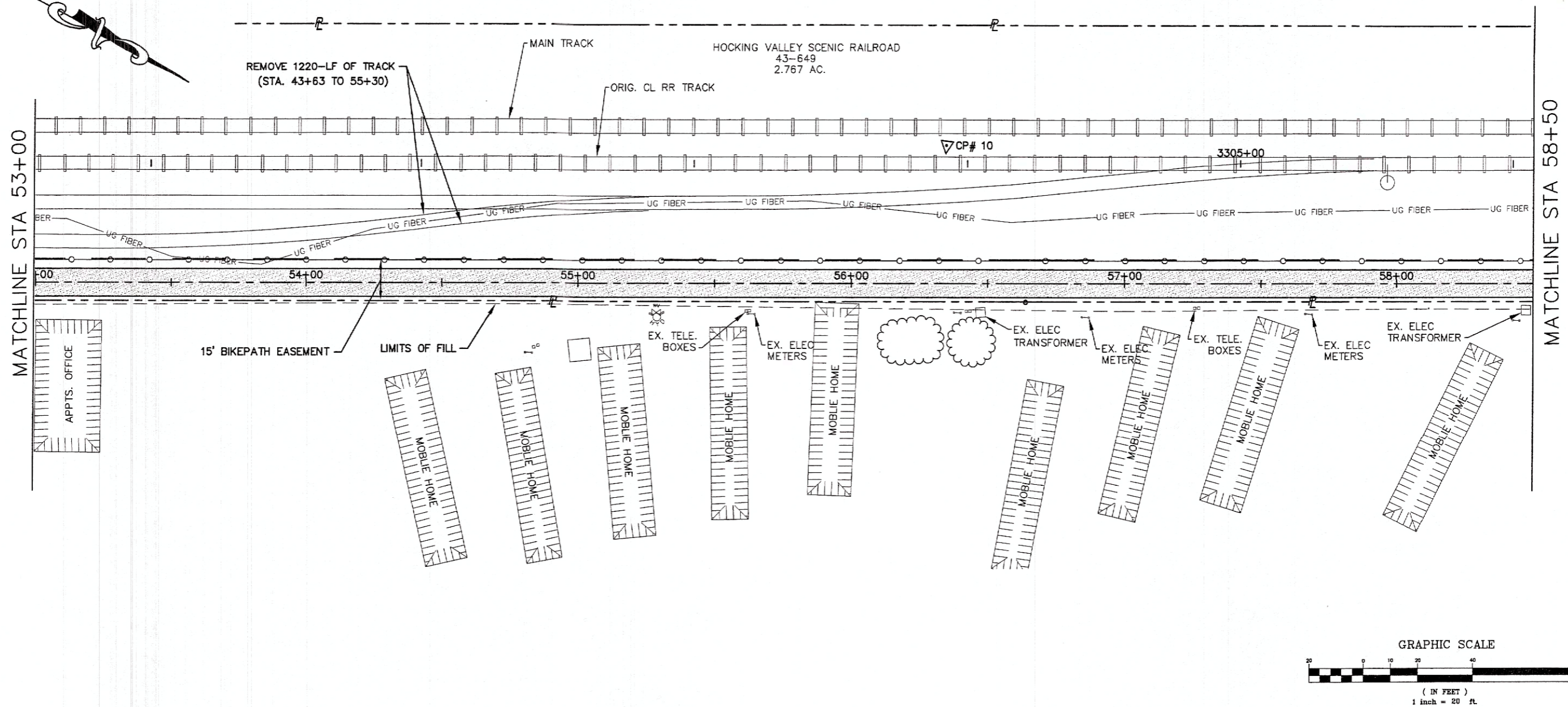
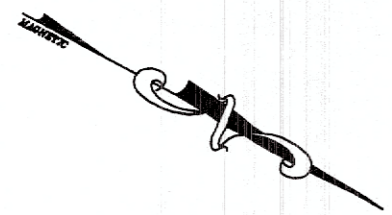

MATCHLINE STA 53+00

MATCHLINE STA 58+50

PLAN + PROFILE
STA. 53+00 to STA. 58+50

ATH NELSONVILLE BIKEPATH

DESIGNED BY	RAJ ENGINEERING CO.
DRAWN	DEB/DWR
CHECKED	FLM
DATE	06/15/07
CITY OF NELSONVILLE	207 LANE HAZE DRIVE
REYNOLDS, OHIO 45764	

[[PLM]] Z:\LAND PROJECTS 2007\NELSONVILLE BIKE PATH EXTENSION\DWG\B1800P001.DWG - JUN 21, 2007 - 10:44:00 - PLOT: 1-1

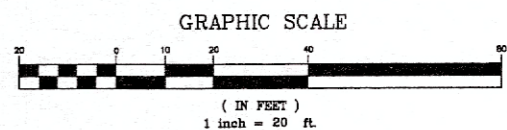
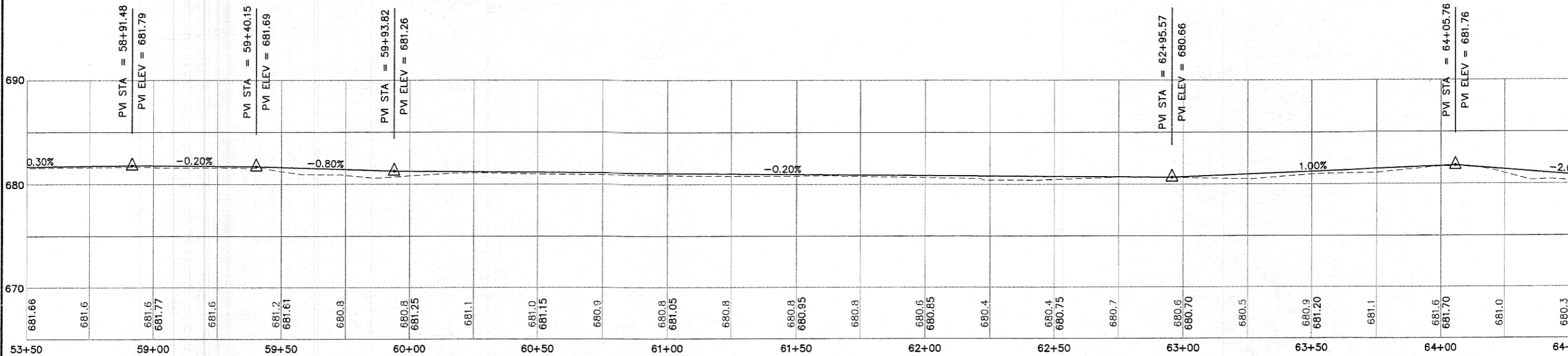
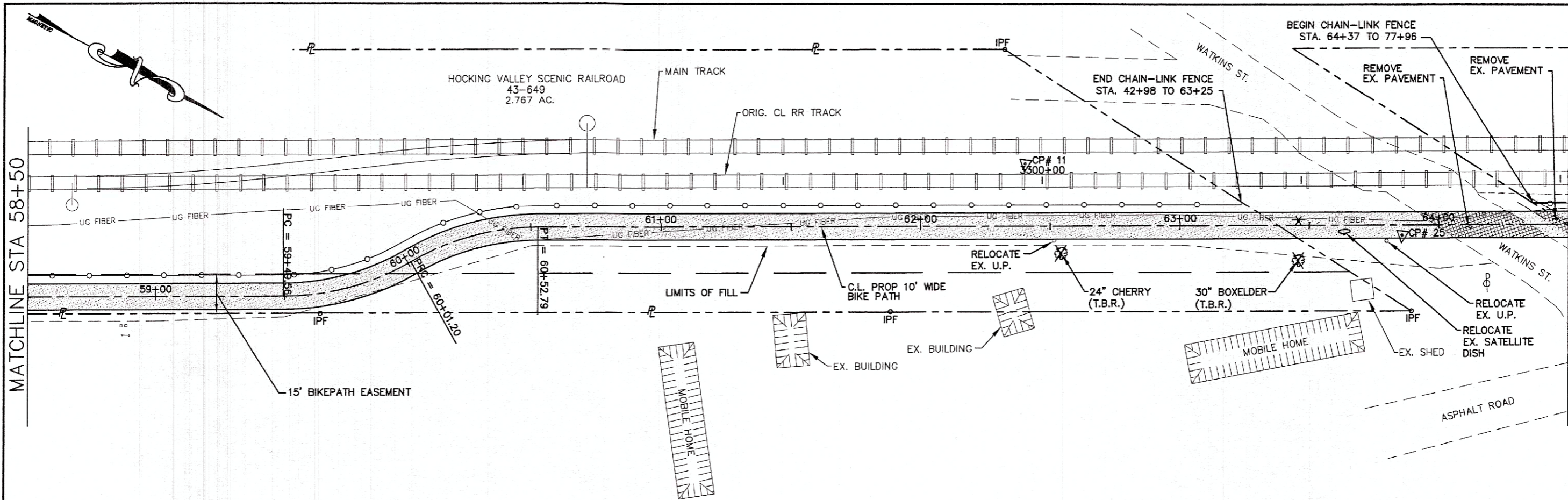

MATCHLINE STA 58+50

MATCHLINE STA 64+50

DESIGNED BY	DATE
DEB/DWR	06/16/07
PLM	
CITY OF NELSONVILLE	
211 LAKE HURON DRIVE	
NELSONVILLE, OH 43069	

PLAN + PROFILE
STA. 58+50 to STA. 64+50

ATH NELSONVILLE BIKEPATH

[R:\M\PROJECTS 2007\NELSONVILLE BIKE PATH EXTENSION\DWG\BTR000P001.DWG - JUN 21, 2007 - 10:44:00 - PLOT: 1=1

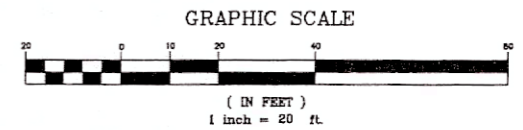
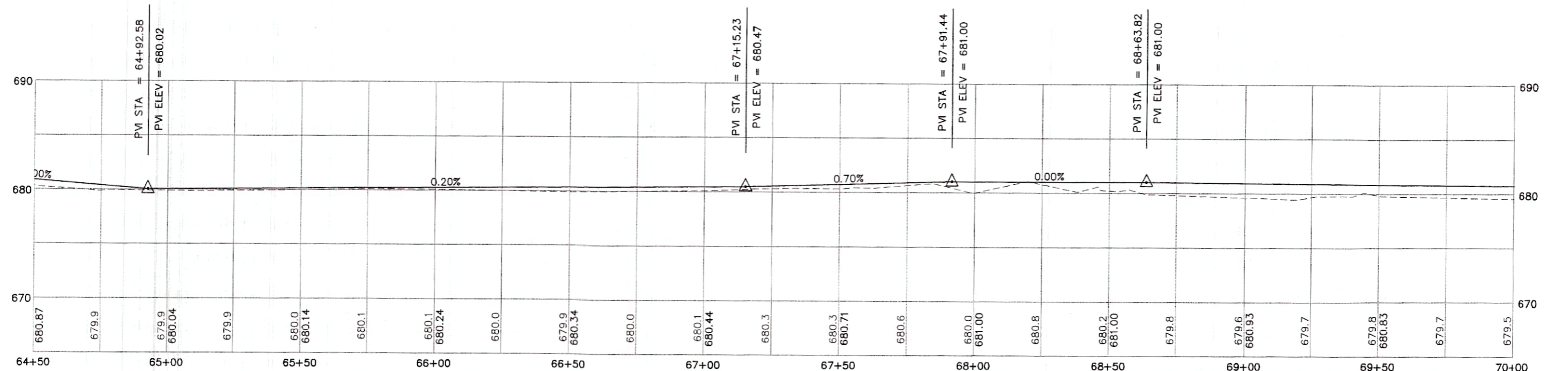
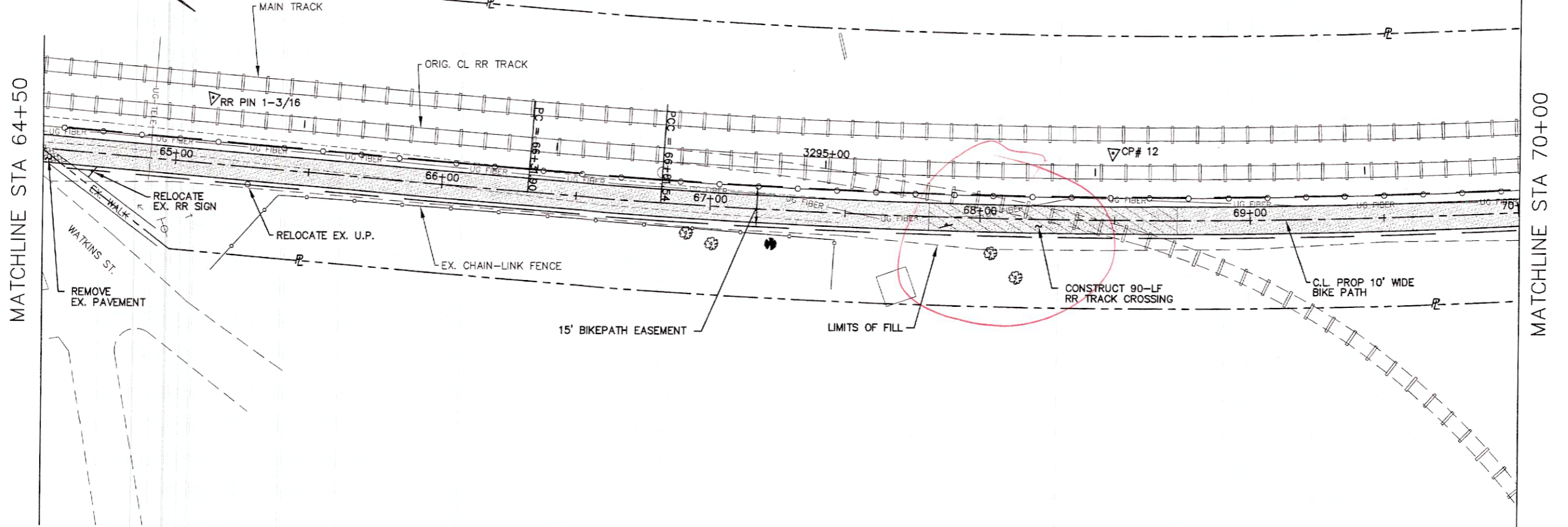

MATCHLINE STA 64+50

MATCHLINE STA 70+00

Designed by
RAM ENGINEERING CO.
66 S. PLAINS RD.
THE PLAINS, OHIO 45780

PROJ #
818009
DATE
08/15/07

DRAWN
DEB/DWR
REVISION

ISSUED
PLM
CHECKED

CHECKED
DATE
2/11/08
BY
NELSONVILLE, OHIO 45749

PLAN + PROFILE
STA. 64+50 to STA. 70+00

ATH NELSONVILLE BIKEPATH

[[PLM]] Z:\LAND PROJECTS 2007\NELSONVILLE BIKE PATH EXTENSION\DWG\18060001.DWG - JUN 21, 2007 - 10:44:40 - PLOT: 1-1

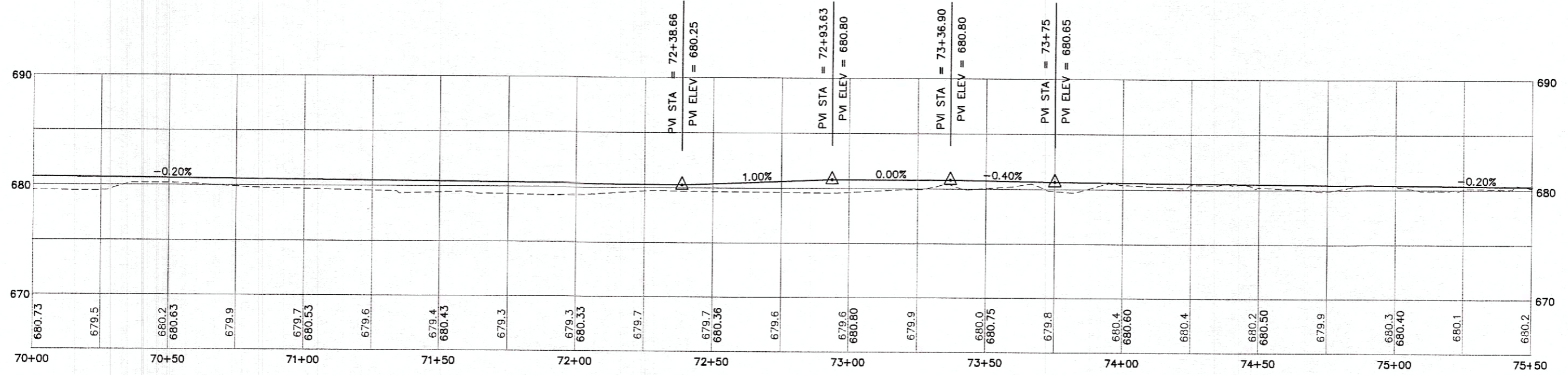
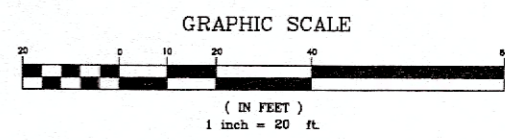
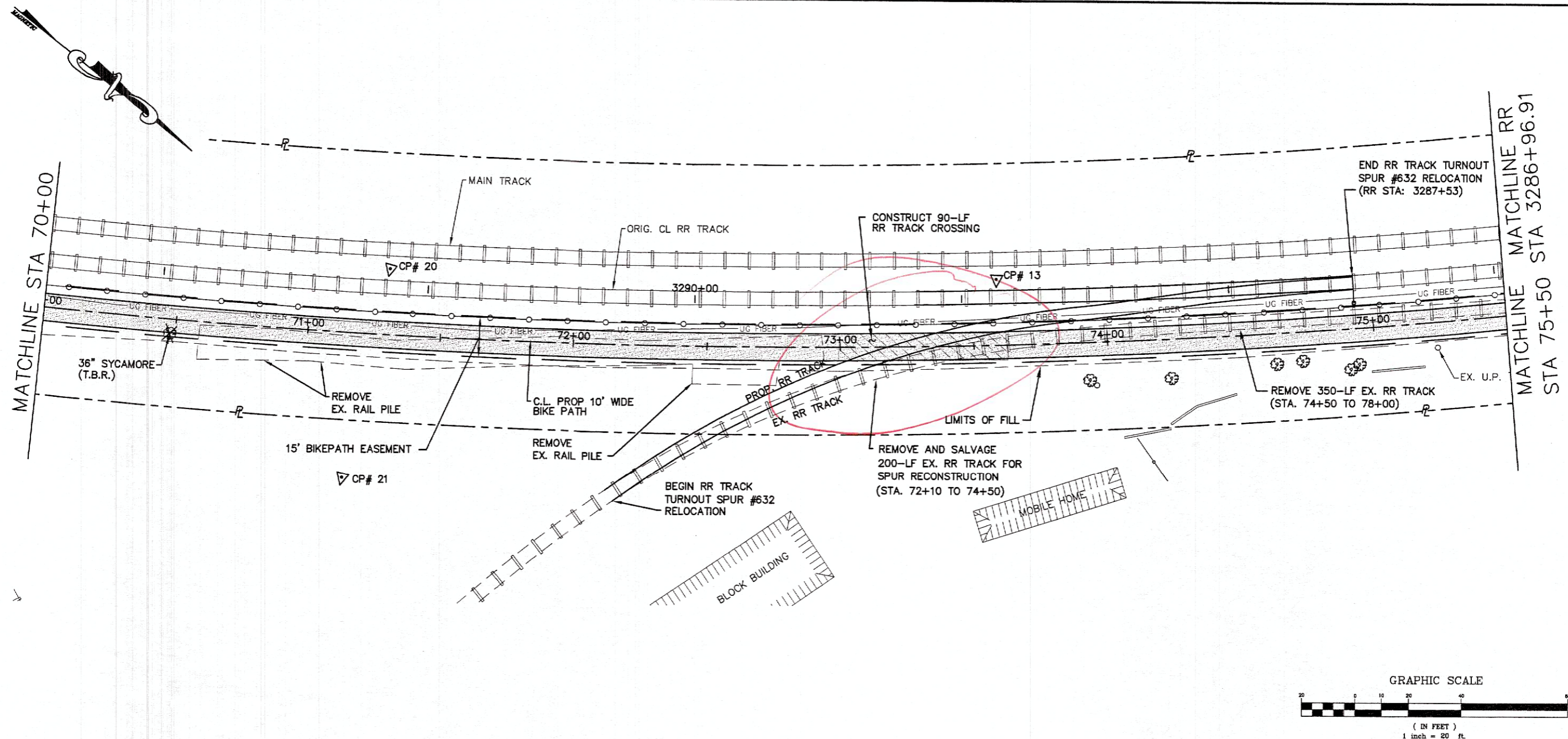

Designed by
PLM ENGINEERING CO.
66 S. PLAINS RD.
THE PLAINS, OH 43081

NO. /
81809
DATE
06/15/07

DESIGNER
DEB/DWR
CHECKED

PREPARED BY
PLM
CHECKED

DATE
CITY OF NELSONVILLE
271 LAKE WOOD DRIVE
NELSONVILLE, OH 45741

PLAN + PROFILE
STA. 70+00 to STA. 75+50

ATH NELSONVILLE BIKEPATH



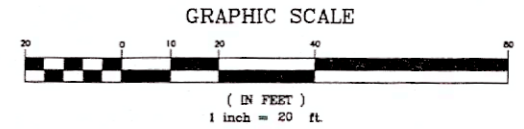
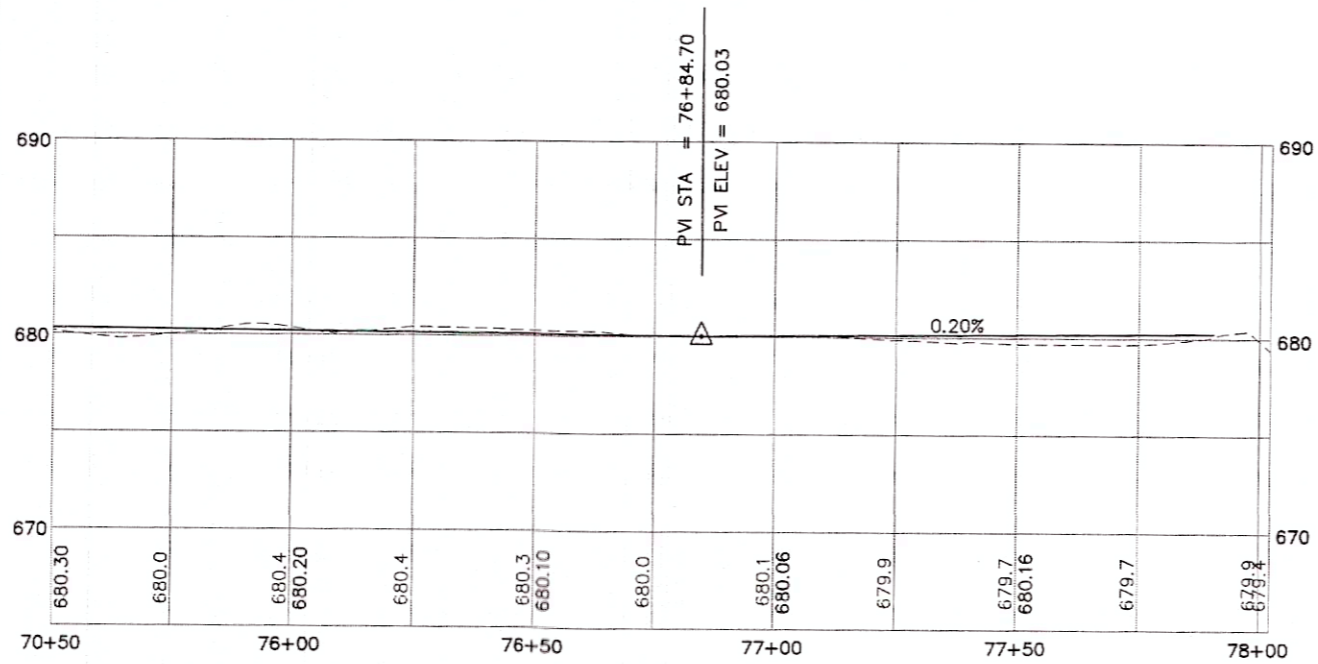
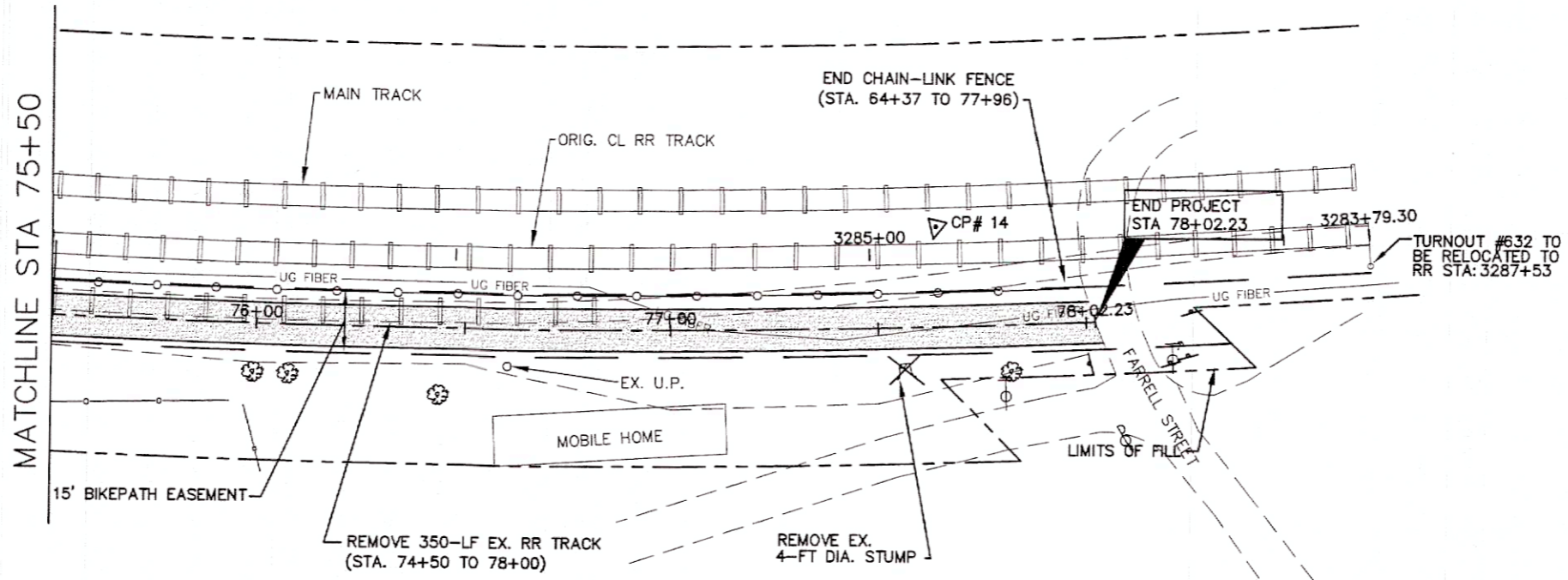
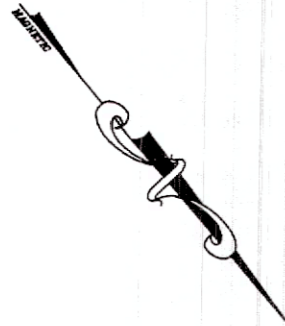

PLAN + PROFILE
STA. 75+50 to STA. 78+02.23

ATH NELSONVILLE BIKEPATH

DATE: 08/15/07
CITY OF NELSONVILLE
271 LAKE WOOD DRIVE
NELSONVILLE, OHIO 45764

DESIGNED BY: PLM
CHECKED BY: [blank]

DESIGNED BY: DES/DWR
REVIEWED BY: [blank]

PROJECT NO: 616009
DATE: 08/15/07

DESIGNED BY: [blank]
PAL ENGINEERING CO.
166 S. PLAINS AVE.
THE PLAINS, OHIO 43080

MATCHLINE RR STA 3321+19.57

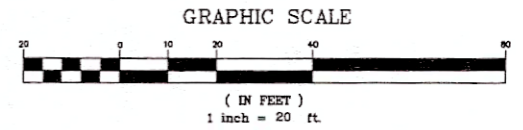
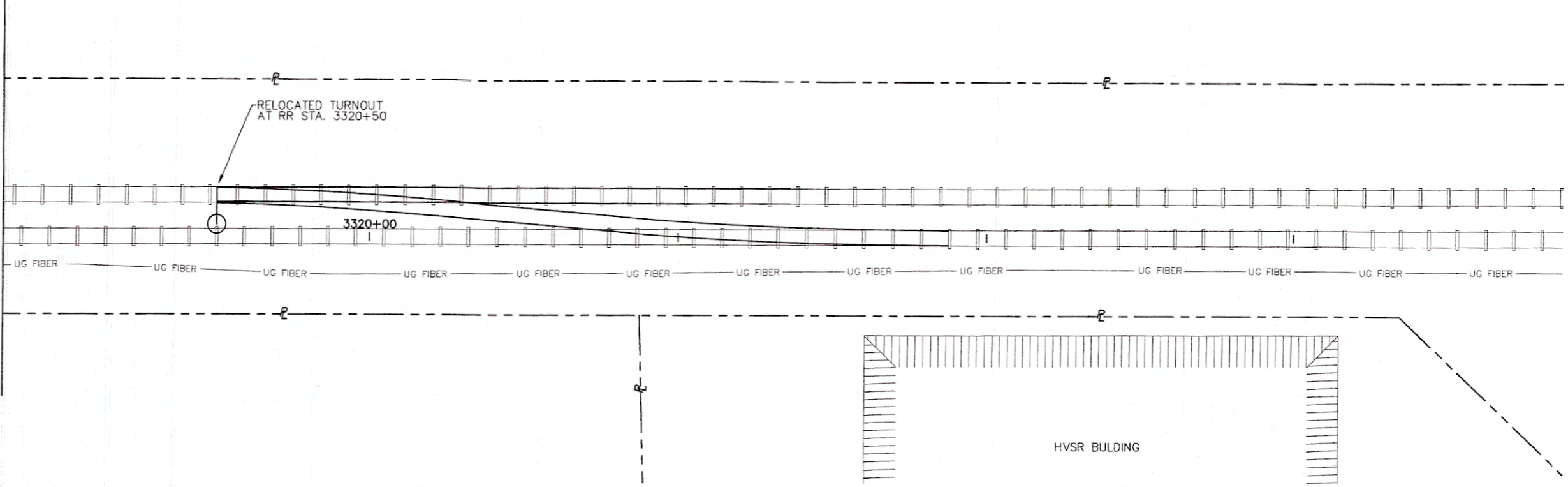

PLAN - TURNOUT RELOCATION

ATH NELSONVILLE BIKEPATH

DESIGNED BY FLJM	CHECKED BY FLJM	DATE 06/15/07	PROJ # 8800	DATE 06/15/07
DRAWN DES/DWR		REVISION		
DATE 06/15/07		DESIGNED BY FLJM		
CITY OF NELSONVILLE 271 LAKE RIDGE DRIVE NELSONVILLE, OHIO 45764		REGISTERED PROFESSIONAL ENGINEER OHIO ENGINEERING BOARD 68 S. PLAINS RD. THE PLAINS, OHIO 43084		

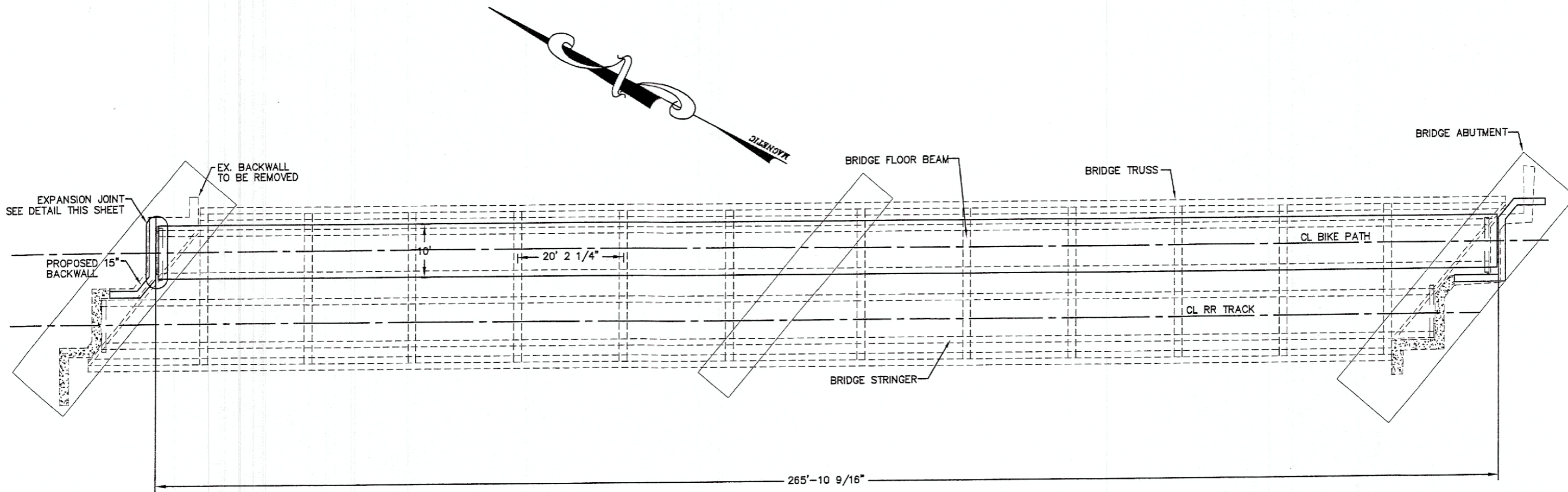

EX. BRIDGE STRUCTURE
SCALE: 1" = 10'

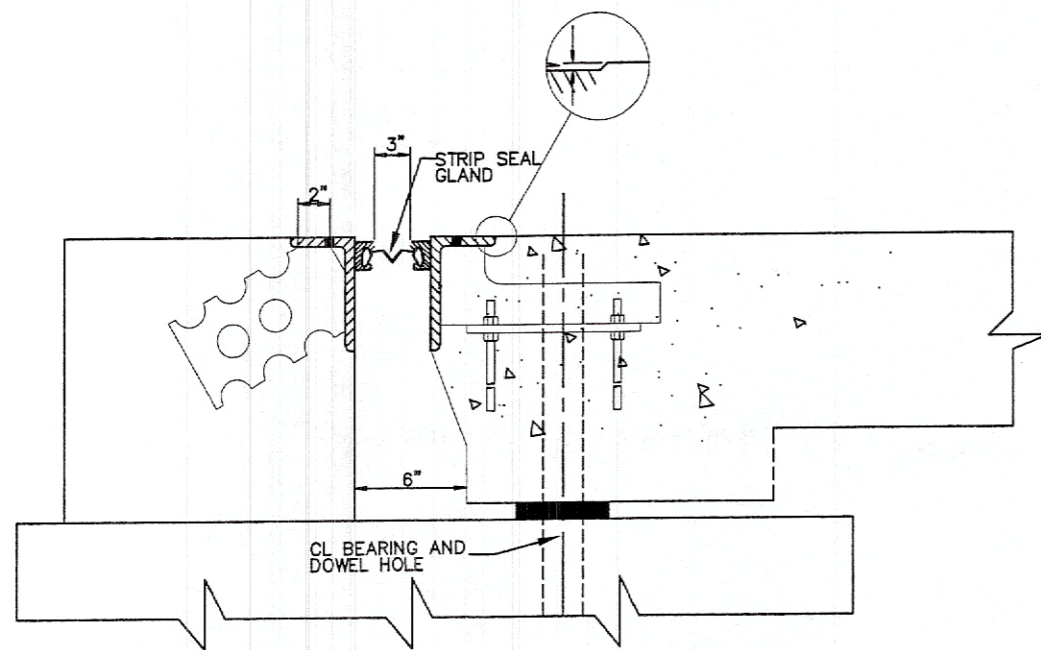

EXPANSION JOINT DETAIL
SCALE: 1" = .5'

[[PLOT]] Z:\LAND PROJECTS 2007\NELSONVILLE BIKE PATH EXTENSION\DWG\VALUEROADBRIDGE.DWG - JUN 15, 2007 - 08:13:00 - PLOT: 1-1

DESIGNED BY RJM ENGINEERING CO. 66 S. PLANK RD. THE PLAINS, OH 45750	NO. # 68809	DATE 06/15/07
DRAWN DWR	REVIEWED	
DESIGNED RJM	CHECKED	
CHECKED CITY OF NELSONVILLE 271 LAKE HURON DRIVE NELSONVILLE, OH 45741		
PLAN - BRIDGE STRUCTURE		
ATH NELSONVILLE BIKEPATH		
33 35		

[[R:\]] Z:\LAND PROJECTS 2007\NELSONVILLE BIKE PATH EXTENSION\DWG\MILROD\BRIDGE.DWG - JUN 15, 2007 - 08:13:00 - PLOT: 1-1

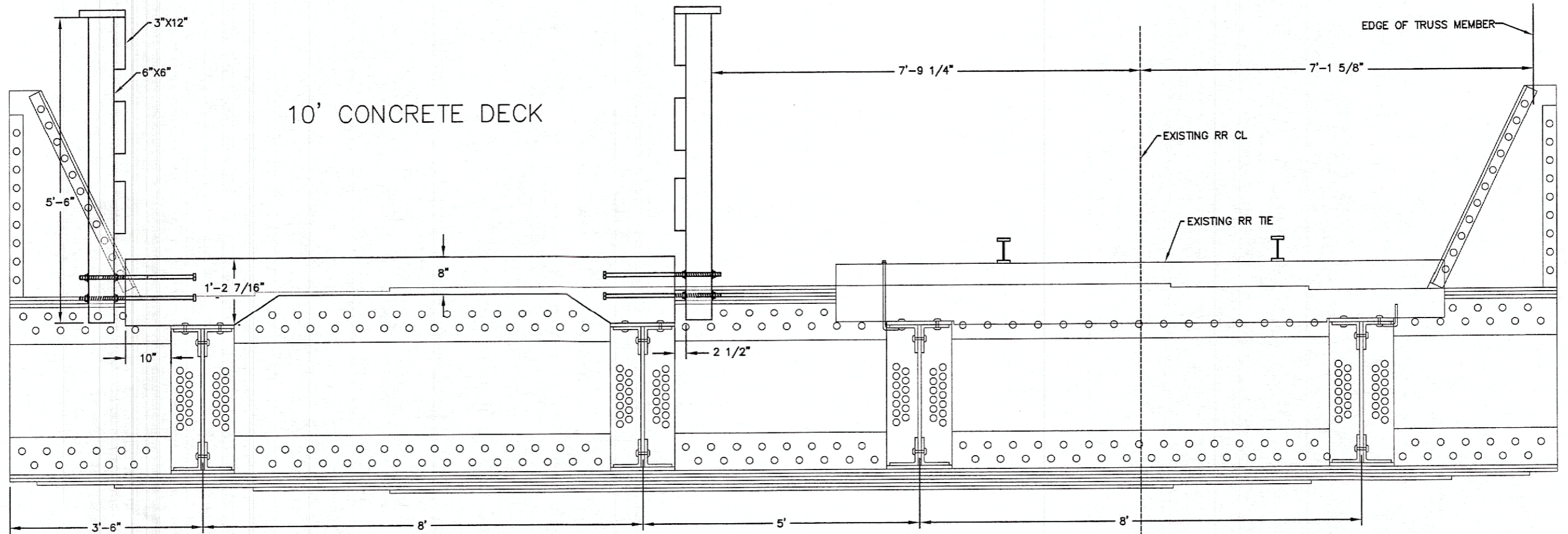

CROSS SECTION-BRIDGE DETAIL
 SCALE: 1" = 1'

DESIGNED BY
JAM ENGINEERING CO.
86 S. PLAINS RD.
THE PLAINS, OHIO 43080

PROJ #
61600

DATE
08/15/07

DRAWN
DWR

REVIEWED

DESIGNED
FLM

CHECKED

DATE
08/15/07

CITY OF NELSONVILLE
201 LAKE TAPE DRIVE
NELSONVILLE, OHIO 45754

CROSS SECTION-BRIDGE DETAIL

ATH NELSONVILLE BIKEPATH

34
35