

**DESCRIPTION OF
1.564 Acres**

Luke Sayers

Situated in Section 1, Town 5, Range 13, Canaan Township, Athens County Ohio, and being more particularly described as follows:

COMMENCING AT A POINT, said point being the Southwest corner of the Northeast quarter of Said Section 1; thence along the south line of said quarter S 88°09'13" E 403.65 feet to an iron pin set at

THE POINT OF BEGINNING OF THE TRACT HEREIN DESCRIBED;

thence leaving the quarter section line N 13°58'22" E, 382.68 feet to an iron pin set;
thence S 79°44'09" E, 141.13 feet to an iron pin set;
thence S 16°20'28" E, 49.01 feet to an iron pin set;
thence S 79°48'09" E, 24.70 feet to a point in the center of Township Road 538;
thence along the center of said road S 10°31'43" W, 73.62 feet to a railroad spike found;
thence S 10°40'20" W, 42.94 feet to a railroad spike found;
thence S 20°11'00" W, 198.19 feet to a point;
thence leaving the road N 88°09'13" W, 179.68 feet to an iron pin set (passing an iron pin set at 31.60 feet);
the point of beginning containing 1.564 acres.

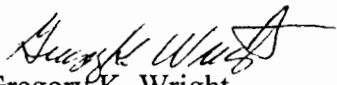
Gregory K. Wright
C:\My Documents\Deed Checks\Luke Sayers.doc

Description checked for
Mathematical Accuracy
ATHENS COUNTY
ENGINEER'S OFFICE
BY: S. Blausen
DATE: 5-6-02

CAN#1
106



Tawn V. Jutton etol
75-308 OR

Kincade
232-791 OR

Rose
22-852 OR

French
129-107 OR

Scott
315-775 Deed

Scott
315-775 Deed

68,128 sq. ft.
1.564 acres

- ▲ = Railroad Spike Found
- ▲ = Railroad Spike Set
- ⊙ = Iron Pin Found
- = Iron Pin Set
- = Stone Found
- ⊗ = Monument Found

LINE TABLE		
LINE	BEARING	LENGTH
L1	S16°20'28"E	49.01'
L2	S79°48'09"E	24.70'
L3	S10°31'43"W	73.62'
L4	S10°40'20"W	42.94'

Description checked for
Mathematical Accuracy
ATHENS COUNTY
ENGINEER'S OFFICE
BY: S. Blaeser
DATE: 5-6-02

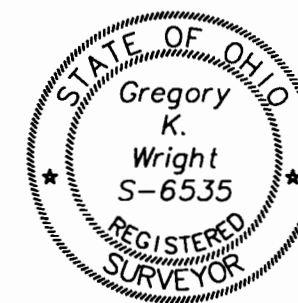

Plat of Survey of 1.564 Acres
Situated in Section 1, Town 5, Range 13, Canaan
Township, Athens County, Ohio
Surveyed April 2002 for:
Luke and Regina Sayers



(IN FEET)
1 inch = 100 ft.

108

Gregory K. Wright
Gregory K. Wright



Gregory K. Wright
Professional Engineer
Professional Surveyor

11684 Channingway Blvd
The Plains, Ohio 45780
740-797-4142
FAX 740-797-8623

109

P-00320