

Description Checked for
Mathematical Accuracy
Athens County
ENGINEER'S OFFICE

BY: Branch
DATE: 3/4/14

DESCRIPTION COMBINING 2 TRACTS OF RECORD

Situated in Section 2 ,T.5, R.13, Canaan Township, Athens County, Ohio and being all of the Third Tract (E010010014800) as described in Volume 276 , Page 1207 O.R. and all of a 1.000 acre tract as described in Volume 248, Page 641 O.R. (E010010014900) and being more particularly described as follows:

Beginning at a stone (calculated) to bear North 86 degrees 36 minutes 47 seconds West a distance of 489.06 feet from the North-east corner of the North-west Quarter of Section 2;

Thence, along the West-line of Storer (276-1207 O.R.)

South 03 Degrees 23 Minutes 13 Seconds West a distance of 495.00 feet to an iron pin;

South 67 Degrees 23 Minutes 13 Seconds West a distance of 241.84 feet to a point in the North Limited Access line of U.S. 50;

Thence, along said limited access line

North 63 Degrees 55 Minutes 33 Seconds West a distance of 1057.70 feet;

Thence, leaving said limited access line and along the east-line of Phillips (373-853 D.R.)

North 33 Degrees 40 Minutes 46 Seconds East a distance of 201.46 feet to an iron pin found

Thence, along the south -line of Philips (282-131 D.R.) and the North-line of Section 2

South 87 Degrees 36 Minutes 57 Seconds East a distance of 1091.76 feet to the point of beginning, and containing 11.137 Acres

Subject to all easements and rights of way of record

Bearings based on Grid North N.A.D. 83

The above description is based on O.D.O.T. Ath 50-18.54 Survey and description prepared by John M. Branner P.S. 6805



Description Approved
Jill A. Thompson
Athens County Auditor

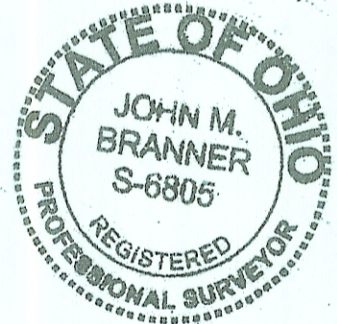

PHILLIPS
GERALD W &
373-853

284+06.24
324.69 Lt

N 33° 40' 46" E
201.46'

Sta. 283+79.56
125.00 Lt.

L/A

S 87° 36' 57" E
1091.76'

Sec. 3
Sec. 2

PHILLIPS
GERALD & OPAL
282-131
194.9100

11.14 Acres

STORER DONNA
276-1207OR
15.5600
E010010014800

STORER DONNA
248-641 OR
1.000 ac
E010010014900

Description Approved
Jill A. Thompson
Athens County Auditor

Description Checked for
Mathematical Accuracy
Athens County
ENGINEER'S OFFICE

BY: *J. A. Thompson*
DATE: 3/4/14

P.O.B. bears
N 86- 36-47 W
489.06' from
the N.E. Cor.
of the N.W.1/4
(calc.)

Stone
not recovered

S 3° 23' 13" W
495.00'

STORER DONNA
276-1207OR
15.0600

N 63° 55' 33" W
1057.70'

Limited Access U.S. 50

Iron pin
not recovered

S 67° 23' 13" W
241.84'

L/A

Plat Combining Two Existing Lots of Record
in Section 2, T.5, R.13, Canaan Township
Athens, County, Ohio

Prepared by:

John M. Branner
John M. Branner P.S. 6805
62 East First Street
The Plains, Ohio 45780
740-541-0350

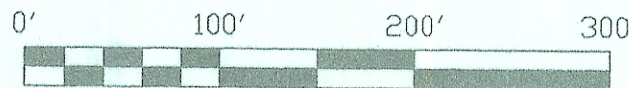
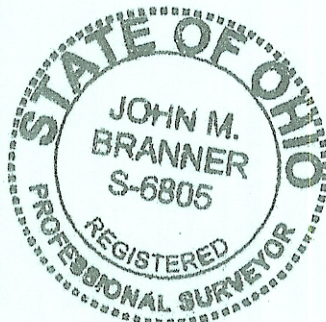

Scale 1 inch = 100 feet
Bearings: Based on N.A.D. 83 Grid North
Ref. Docs.: Tax Plat-Surveys - O.D.O.T. R/W Ath-50-18.54 Survey