

# Survey Plat

for

## BRUNER LAND CO. INC.

SITUATED IN THE STATE OF OHIO, COUNTY OF ATHENS, TOWNSHIP OF CANAAN, BEING IN THE SOUTHWEST QUARTER OF SECTION 5, RANGE 13 WEST, TOWNSHIP 5 NORTH OF "THE OHIO COMPANY PURCHASE".

THE BEARINGS ON THIS PLAT ARE FOR ANGLE CALCULATIONS ONLY AND ARE BASED ON AN ASSUMED BEARING ON THE WEST LINE OF THE SOUTHWEST QUARTER OF SECTION 5 USED AS NORTH 00°01'29" EAST.

SUBJECT TO ALL LEGAL RIGHT-OF-WAYS, EASEMENTS, RESTRICTIONS, RESERVATIONS, AND ZONING REGULATIONS OF RECORD. SUBJECT TO 100 YEAR FLOOD PLAIN RESTRICTIONS, IF APPLICABLE. SUBJECT TO ANY FACTS THAT MAY BE DISCLOSED IN A FULL AND ACCURATE TITLE SEARCH.

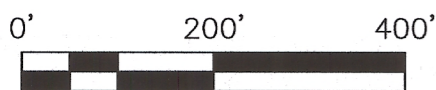
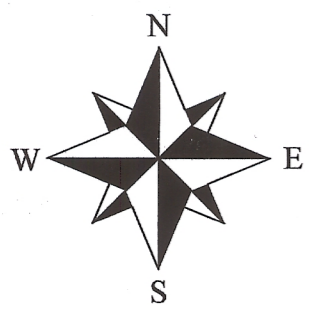

Scale : 1" = 200'

Mitchel L. & Catherine G. Blower  
First Part  
Vol. 269 Pg. 355  
72.34 Acres

Mitchel L. & Catherine G. Blower  
Second Part  
Vol. 269 Pg. 355  
25.81 Acres

LDK Lucas Rentals, LLC.  
Tract Ten  
O.R.V. 505 Pg. 1646  
15.429 Acres

Wanda S. Lowry  
Vol. 246 Pg. 314  
5.0885 Acres

Description Checked for  
Mathematical Accuracy  
Athens County  
ENGINEER'S OFFICE

BY: *Gregory A. Biedenbach*  
DATE: 7/17/16

- = 5/8" x 30" I.P. Set "Biedenbach Surveying, LLC. PS 7881 - PS 8534"
- + = survey angle point
- = 5/8" iron pin fnd. capped "L.F. Swoyer RLS 6765"
- = 5/8" I.P.F. uncapped
- = 5/8" iron pin fnd. capped "Newman 8043"

Susan A. Applegate  
O.R.V. 482 Pg. 1357  
25.403 Acres

### PERTINENT DOCUMENTS

- (1) ALL DEEDS AS SHOWN.
- (2) COUNTY TAX MAPS.
- (3) U.S.G.S. QUAD. MAP STEWART.
- (4) SURVEY PLATS BY C. TIM NEWMAN.
- (5) SURVEY PLATS BY LEONARD SWOYER, JR.
- (6) SURVEY PLAT BY BIEDENBACH SURVEYING, LLC.

Aaron L. Leatherwood  
O.R.V. 485 Pg. 1342  
24.117 Acres

### SURVEYORS CERTIFICATION:

I HEREBY CERTIFY THAT THIS PLAT IS TRUE AND CORRECT TO THE BEST OF MY KNOWLEDGE AND THAT IT WAS PREPARED FROM AN ACTUAL FIELD SURVEY OF THE PREMISES. TITLE IS NOT GUARANTEED BY THIS SURVEY.

*Gregory A. Biedenbach* July 7, 2016  
GREGORY A. BIEDENBACH  
OHIO REG. SURVEYOR PS 7881  
BIEDENBACH SURVEYING, LLC.  
114 ADAMS AVENUE  
WOODSFIELD, OHIO 43793  
1.740.472.1262 OFFICE  
1.740.472.5298 FAX

NOTE: THIS MAP IS AN ORIGINAL COPY ONLY WITH ORIGINAL SIGNATURE AND SEAL.

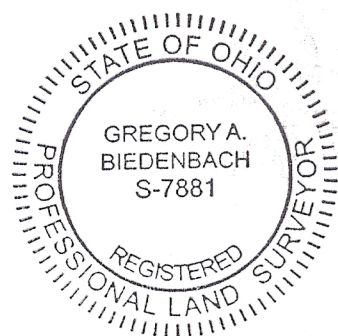

Raymond M. & Lori A. Houska  
Tract 2  
Vol. 188 Pg. 147  
86.50 Acres

Raymond M. & Lori A. Houska  
Tract 1  
Vol. 188 Pg. 147  
33 Acres

Kevin L. & Olivia J. Vogt  
O.R.V. 494 Pg. 438  
58.95 Acres

Section 11  
Section 5

P.O.B. Parcel #1

2618.20' = TOTAL

447.20' = TOTAL

753.05' = TOTAL

Section 11  
Section 10  
P.O.B. Parcel #4

N.W. Corner of S.W. 1/4 of Sec. 5

PARCEL #1  
16.013 ACRES

New Split from Bruner Land Co. Inc. O.R.V. 521 Pg. 2084 73.991 Acres Aud. P.N. E010010003900

1194.87' = TOTAL

PARCEL #4  
20.622 ACRES

New Split from Bruner Land Co. Inc. O.R.V. 521 Pg. 2084 73.991 Acres Aud. P.N. E010010003900

1423.33' = TOTAL

587.76'

PARCEL #2  
15.041 ACRES

New Split from Bruner Land Co. Inc. O.R.V. 521 Pg. 2084 73.991 Acres Aud. P.N. E010010003900

1157.37' = Total

PARCEL #3  
22.315 ACRES

New Split from Bruner Land Co. Inc. O.R.V. 521 Pg. 2084 73.991 Acres Aud. P.N. E010010003900

1457.25' = Total

Section 5  
Section 4  
P.O.B. Parcel #3

442.84'

PARCEL #2  
15.041 ACRES

New Split from Bruner Land Co. Inc. O.R.V. 521 Pg. 2084 73.991 Acres Aud. P.N. E010010003900

1157.37' = Total

PARCEL #3  
22.315 ACRES

New Split from Bruner Land Co. Inc. O.R.V. 521 Pg. 2084 73.991 Acres Aud. P.N. E010010003900

1457.25' = Total

Section 5  
Section 4  
P.O.B. Parcel #3

202.95'

PARCEL #2  
15.041 ACRES

New Split from Bruner Land Co. Inc. O.R.V. 521 Pg. 2084 73.991 Acres Aud. P.N. E010010003900

1157.37' = Total

PARCEL #3  
22.315 ACRES

New Split from Bruner Land Co. Inc. O.R.V. 521 Pg. 2084 73.991 Acres Aud. P.N. E010010003900

1457.25' = Total

Section 5  
Section 4  
P.O.B. Parcel #3

645.79' = Total

PARCEL #2  
15.041 ACRES

New Split from Bruner Land Co. Inc. O.R.V. 521 Pg. 2084 73.991 Acres Aud. P.N. E010010003900

1157.37' = Total

PARCEL #3  
22.315 ACRES

New Split from Bruner Land Co. Inc. O.R.V. 521 Pg. 2084 73.991 Acres Aud. P.N. E010010003900

1457.25' = Total

Section 5  
Section 4  
P.O.B. Parcel #3

1233.55' = TOTAL Parcel #2

PARCEL #2  
15.041 ACRES

New Split from Bruner Land Co. Inc. O.R.V. 521 Pg. 2084 73.991 Acres Aud. P.N. E010010003900

1157.37' = Total

PARCEL #3  
22.315 ACRES

New Split from Bruner Land Co. Inc. O.R.V. 521 Pg. 2084 73.991 Acres Aud. P.N. E010010003900

1457.25' = Total

Section 5  
Section 4  
P.O.B. Parcel #3

831.59' = TOTAL

PARCEL #2  
15.041 ACRES

New Split from Bruner Land Co. Inc. O.R.V. 521 Pg. 2084 73.991 Acres Aud. P.N. E010010003900

1157.37' = Total

PARCEL #3  
22.315 ACRES

New Split from Bruner Land Co. Inc. O.R.V. 521 Pg. 2084 73.991 Acres Aud. P.N. E010010003900

1457.25' = Total

Section 5  
Section 4  
P.O.B. Parcel #3

781.59'

PARCEL #2  
15.041 ACRES

New Split from Bruner Land Co. Inc. O.R.V. 521 Pg. 2084 73.991 Acres Aud. P.N. E010010003900

1157.37' = Total

PARCEL #3  
22.315 ACRES

New Split from Bruner Land Co. Inc. O.R.V. 521 Pg. 2084 73.991 Acres Aud. P.N. E010010003900

1457.25' = Total

Section 5  
Section 4  
P.O.B. Parcel #3

BRUNER LAND CO. INC.  
O.R.V. 521 PG. 2084  
73.991 ACRES  
PRIOR:  
TUSCO FORESTRY  
O.R.V. 514 PG. 207

LINE	BEARING	DISTANCE
L1	S34°01'30"W	33.43'
L2	S44°12'02"W	48.07'
L3	S53°31'34"W	43.94'
L4	S57°54'58"W	71.14'
L5	S59°13'42"W	85.60'
L6	S61°42'37"W	118.90'
L7	S64°40'28"W	99.30'
L8	S69°06'20"W	90.61'
L9	S76°53'28"W	91.97'
L10	S84°03'02"W	26.91'
L11	S84°03'02"W	59.37'
L12	N84°55'43"W	116.08'
L13	N81°15'39"W	75.45'
L14	N86°27'27"W	55.10'
L15	S84°56'18"W	54.37'
L16	S78°45'00"W	263.09'