

Phone 740-753-1264
Fax 740-753-1264

Description of a 1.933 Acre Tract

Situated in Section 16, T-9, R-12, Carthage Township, Athens County, State of Ohio and being a part of a tract as described in Volume 317, Page 2697 of the Official Records of Athens County and being more particularly described as follows:

BEGINNING at a Right of Way Monument found on the south Right of Way line of CR-53 that bears South 87°33'54"East, 498.26 feet (calculated) from the Northwest corner of the Southeast ¼ Of Section 16,
THENCE South 87°38'38"East, 256.22 feet to a Right of Way monument found on the West Right of Way line of US RT 50,
THENCE along said west line the following two courses;
South 18°31'13"East, 233.28 feet to a point,
South 19°38'44"East, 146.68 feet to a point,
THENCE North 63°14'27"West, 407.34 feet to an iron pin set,
THENCE North 33°12'17"West, 151.13 feet to an iron pin set on the south Right of Way line of CR-53,
THENCE along said line North 48°10'28"East, 90.00 feet to the point of beginning and containing 1.933 acres.

Bearings are to an assumed meridian and are for angular determination only

Subject to all Easements and Rights of Way of Record

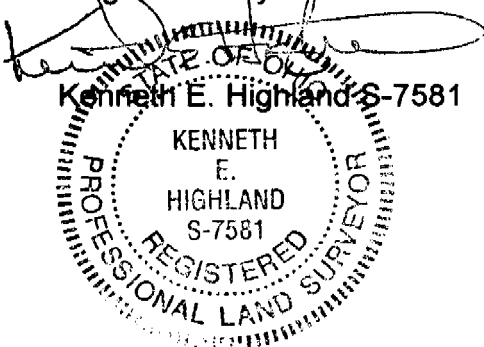

Description Checked for
Mathematical Accuracy
Athens County
ENGINEER'S OFFICE
BY: S. Blaus
DATE: 1-21-04



Bailey
221-440

CR-53

US RT-50

N.W. corner of the
S.E. 1/4 of Section 16

Bailey
221-440

S 87°33'54"E
498.26'

N 38°17'03"E
213.32'

S 26°10'18"E
223.50'

S 87°38'38"E
256.22'

1.933 Ac.

Castle
317-2697 OR

Castle
317-2697 OR

Scale 1"=80'



○ = Iron Pin Set

Description: **CR-53 RW Monument Found**
 Accuracy: **Mathematical Accuracy**
 Athens County
 ENGINEER'S OFFICE

Line	Bearing	Distance
3	N 48°10'28"E	33.90'

BY: S. Blausch
 DATE: 1-21-04

REVISED

PLAT OF SURVEY OF A 1.933 Ac. TRACT

SURVEYED FOR VERN CASTLE

SUBDIVISION —

TOWNSHIP CARLIAGE SECTION 16 TOWN 9 RANGE 1

CORPORATION — COUNTY ATHENS STATE OHIO

SCALE 1"= 80' DATE JAN, 2004

Kenneth E. Highland
80 Fayette St.
Nelsonville, Ohio 45764
740-753-1264

Kenneth E. Highland S-7581

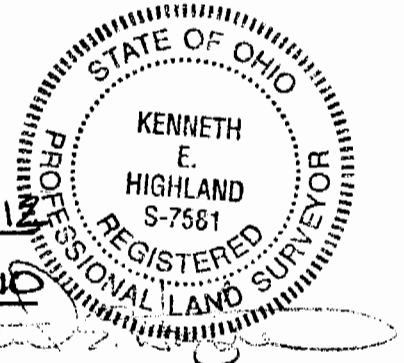

CAR #16