

Description of 1.368 Acre Tract

Situated in Fraction 19, Section 20, T-5 R-12 Carthage Township, Athens County Ohio and being more particularly described as follows:

Commencing at the Northeast corner of Fraction 19; thence along the East line of said fraction, South 04° 38' West, 1025.47 feet to an iron pin at the Southeast corner of an 8.6 acre tract (deed ref. Vol 60 Page 817) thence South 88° 02' 08" West 553.52 feet to a point in the center of County Road 53. Said point being the true point of beginning for this tract. Thence leaving County Road 53 South 72° 57' 09" West 299.57 feet to an iron pin set passing an iron pin at 18.45 feet, thence North 10° 03' 47" West 248.23 feet to an iron pin set thence North 81° 54' 13" East 225.26 feet to a point in County Road 53 passing an iron pin at 205.36 feet. Thence along said road South 29° 33' 00" East 216.47 feet to the point of beginning and containing 1.368 acres.

Subject to all easements and rights of way of record.

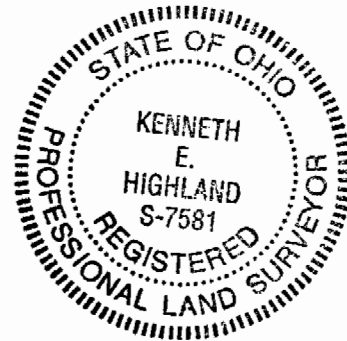

Description checked for
Mathematical Accuracy
ATHENS COUNTY
ENGINEER'S OFFICE
BY: B. Blaise
DATE: 5-16-94

154

CAE#20

BOGGS
37-867

N 81° 54' 13" E
225.26'

+ 205.36

1.368 Acres

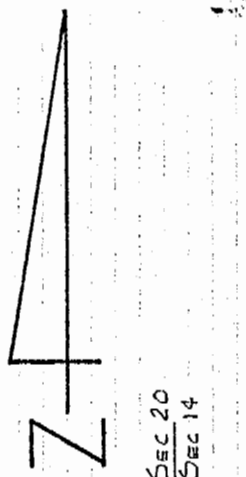

SEC 20
SEC 14

N.E. CORNER
FRACTION 19

S 4° 38' W
1025.47'

S 29° 33' 00" E
216.47'

+ 18.45

L1 = S 88° 02' 08" W
553.52

S 72° 57' 09" W
299.57'

N 10° 03' 47" W
248.25'

BOGGS
37-867

BOGGS
37-867

PLAT OF SURVEY

1.368 Ac
TRACT

SITUATED IN SEC 20 FRAC 19
CARTHAGE TOWNSHIP, ATHENS
COUNTY OHIO

SURVEYED BY
HIGHLAND SURVEYING
NELSONVILLE, OHIO

O = IRON PIN SET

SCALE 1" = 50'

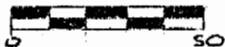

Kenneth E. Highland
KENNETH E. HIGHLAND S-7581

155