

DESCRIPTION OF A 22.11 ACRE TRACT

Situated in Section 1, T.5, R.12, Carthage Township, Athens County, Ohio and being a part of a tract of land as described in Volume 222, Page 214, Athens County Deed Records and being more particularly described as follows:

Commencing at the South-east corner of Section 1, thence, along the South-line of said section South 87 Degrees 05 Minutes 16 Seconds West, 3771.57 feet (deeds) to an iron Pin set at the South-west corner of Grantor's tract, said Pin being the Point of beginning for the tract of land herein described:

Thence, along Grantor's west-line, North 02 Degrees 39 Minutes 25 Seconds West, 1444.65 feet to a fence corner; thence, North 86 Degrees 25 Minutes East, 516.94 feet to a Point in County Road 65, Passing an iron Pin set at 490.31 feet; thence, along said road South 61 Degrees 15 Minutes 38 Seconds East, 372.80 feet to a Point; thence, South 31 Degrees 41 Minutes 34 Seconds West, 250.21 feet to an iron Pin set, Passing an iron Pin set at 26.67 feet; thence, South 66 Degrees 55 Minutes 47 Seconds East, 411.24 feet to an iron Pin set; thence, South 41 Degrees 01 Minutes 13 Seconds West, 651.04 feet to an iron Pin set; thence, South 54 Degrees 06 Minutes 26 Seconds West, 735.00 feet to the Point of beginning and containing 22.11 acres.

Subject to all easements and rights of way of record.

John M. Branner R.L.S. 6805

Description checked for
Mathematical Accuracy
ATHENS COUNTY
ENGINEERING OFFICE
BY: Archie Staley
DATE: 6-18-86

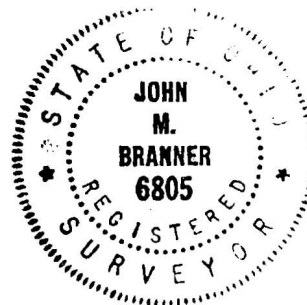

Sec #1, Carthage

VANNIETER

FENCE COR.

DOMIGAN

N 86° 25' E 516.94'

+490.31'

S 61° 15' 38" E 372.80'

+26.67'

S 31° 41' 34" W 250.21'

2.38 AC.

N 49° 37' 38" W 121.67'

S 66° 33' 47" E 111.24'

11.24'

214.34'

1.79 AC.

S 58° 38' 57" W

N 53° 40' 40" W 11.30'

N 43° 47' 30" W 120.83'

COUNTY ROAD 65

22.11 AC.

N 02° 33' 25" W 1444.65'

S 4° 01' 13" W 651.04'

N 54° 06' 26" E 867.86'

S 54° 06' 26" W 735.00'

3.47 AC.

S 21° 53' 54" E 423.38'

S 87° 05' 16" W 755.00'

35

LINDA SUE BARTON RITCHIE
340/703

CHARLES DAVID BARTON
349/331
18.28 AC.



SCALE 1"=100'

● IRON PIN FOUND

○ IRON PIN SET

▲ RRS. FOUND

SOUTH-LINE SEC. 1

USED AS BASIS OF BRGS

PLAT OF SURVEY

OF FOUR TRACTS IN
SECTION 1 T5 R.12
CARTHAGE TWP. ATHENS
COUNTY OHIO

SURVEYED JUNE 86

John M. Branner
JOHN M BRANNER
REGISTERED LAND SURVEYOR 6805
RT 3, ATHENS, O. - 592-5778

SEC. 1 ATHENS COUNTY
MUSKIE COUNTY
1951.44 (DEED & SURVEY)

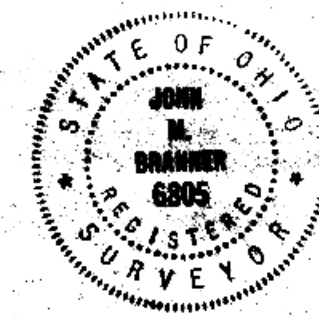
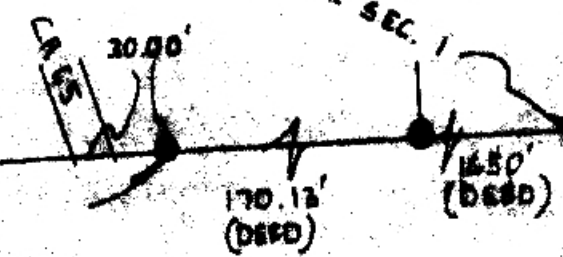

36