

**HIGHLAND SURVEYING LTD.**

80 Fayette St.  
Nelsonville, Ohio 45764

Phone 740-753-1264  
Fax 740-753-1264

**Description of a 16.460 Acre Tract**

Situated in Section 2, T-5, R-12, Carthage Township, Athens County, State of Ohio and being a part of a tract as described in Volume 1, Page 122 of the Official Records of Athens County and being more particularly described as follows:

Commencing at an iron pin found at the northwest corner of a 16.08 acre tract as described in OR Volume 283, Page 730 that bears North 82°40'32"West, 1800.00 feet and South 7°10'28"West, 132.00 feet from the northeast corner of Section 2 (deed), thence along the west line of said tract South 7°10'28"West, 829.35 feet to the southwest corner thereof and the POINT OF BEGINNING of this tract, (a wood corner post bears South 41°19'01"West, 4.99 feet from this corner)

THENCE along grantors westerly most north line and the south line of the Church tract (OR 283-730), South 85°40'16"East, 602.08 feet to a point in the center of TR-119, (passing an iron pin set at 582.08 feet),

THENCE along the center of said road the following nineteen courses:

South 31°09'30"West, 134.44 feet to a point,  
South 30°44'06"West, 332.08 feet to a point,  
South 22°54'11"West, 57.33 feet to a point,  
South 7°47'31"West, 60.80 feet to a point,  
South 11°29'11"East, 86.48 feet to a point,  
South 15°30'47"East, 111.67 feet to a point,  
South 11°02'57"East, 83.04 feet to a point,  
South 0°10'38"West, 97.03 feet to a point,  
South 14°25'36"West, 89.80 feet to a point,  
South 21°17'06"West, 114.80 feet to a point,  
South 23°10'25"West, 172.38 feet to a point,  
South 28°42'48"West, 203.55 feet to a point,  
South 41°15'03"West, 58.51 feet to a point,  
South 49°28'15"West, 73.55 feet to a point,  
South 57°10'29"West, 38.13 feet to a point,  
South 60°33'47"West, 59.02 feet to a point,  
South 72°30'15"West, 43.32 feet to a point,

HIGHLAND SURVEYING LTD.

80 Fayette St.  
Nelsonville, Ohio 45764

Phone 740-753-1264  
Fax 740-753-1264

South  $72^{\circ}59'16''$ West, 89.85 feet to a point,  
South  $73^{\circ}47'16''$ West, 70.31 feet to a point, ( a stone found bears South  
 $7^{\circ}10'28''$ West, 29.33 feet),  
THENCE leaving said road and along the east line of the Mildren tract (OR 140-  
513) and grantors west line North  $7^{\circ}10'28''$ East, 1674.30 feet to the point of  
beginning, (passing an iron pin set at 30.00 feet) and containing 16.460 acres.

Bearings are to an assumed meridian and are for angular determination only

Subject to all Easements and Rights of Way of Record

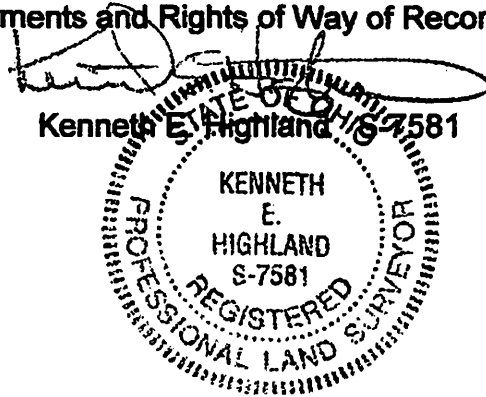

Description Checked for  
Mathematical Accuracy  
Athens County  
ENGINEER'S OFFICE  
BY: *S. Blaus*  
DATE: 5-16-05

**HIGHLAND SURVEYING Ltd.**  
Registered Professional Land Surveyor

N.W. corner of a 16.08 Acre tract (283-730 OR) that bears N 82°40'32"W, 1800.00 feet and S 7°10'28"W, 132.00' from the N.E. corner of Section 2 (Deed)

Wood corner post found bears S 41°19'01"W, 4.99' from corner

Church  
283-730 OR

Mildren  
140-513 OR

**16.460  
Acres**



Scale 1"=200'



- =Iron Pin Set
- =Iron Pin Found
- =Stone Found

Davis  
1-122 OR

Line	Bearing	Distance
50	S 31°09'30"W	134.44'
51	S 22°54'11"W	57.33'
52	S 7°47'31"W	60.80'
53	S 11°29'11"E	86.48'
54	S 15°30'47"E	111.67'
55	S 11°02'57"E	83.04'
56	S 0°10'38"W	97.03'
57	S 14°25'36"W	89.80'
58	S 21°17'06"W	114.80'
59	S 41°15'03"W	58.51'
60	S 49°28'15"W	73.55'
61	S 57°10'29"W	38.13'
62	S 60°33'47"W	59.02'
63	S 72°30'15"W	43.32'
64	S 72°59'16"W	89.85'
65	S 73°47'16"W	70.31'

Description Checked for  
Mathematical Accuracy  
Athens County  
ENGINEER'S OFFICE

BY: *S. Blaisie*  
DATE: *5-16-05*

TR-119  
S 7°10'28"W  
29.33'

PLAT OF SURVEY OF A 16.460 AC. TRACT

SURVEYED FOR JESSIE DAVIS

SUBDIVISION —

TOWNSHIP CARTHAGE SECTION 2 TOWN 5 RANGE 12

CORPORATION — COUNTY ATHENS STATE OHIO

SCALE 1"= 200' DATE MAY 2005

Kenneth E. Highland  
80 Fayette St.  
Nelsonville, Ohio 45764  
740-753-1264

Kenneth E. Highland S-7581

