



GUY & GERALDINE SWADLEY
301-275

ARDEN RAY DEPO
212-257

MYRTLE WELSH et al
285-130

HINCHCLIFF PRODUCTS
309-643

ROGER G. & MANDA L. ALLEN
284-586

NED J. & MILDRED A. SIMPSON
334-471

- Iron Pin Found
- Iron Pin Set

PLAT OF SURVEY
164.5214 ACRES
LOCATED IN SECTION 22, TOWN 5,
RANGE 12, CARTHAGE TOWNSHIP,
ATHENS COUNTY, OHIO
SCALE: 1" = 200' MAY, 1982
FOR Ellsworth Holden

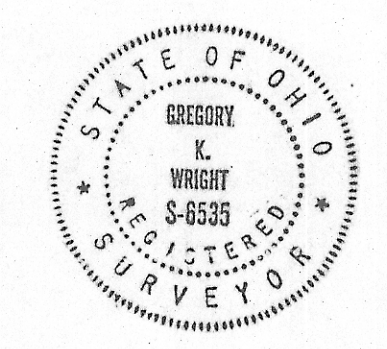

PREPARED BY
EVANS, MECHWART, HAMBLETON & TILTON INC.
CONSULTING ENGINEERS AND SURVEYORS
GAHANNA, OHIO

Gregory K. Wright
Registered Surveyor #6535

Description checked for
Mathematical Accuracy
ATHENS COUNTY
ENGINEERS OFFICE
BY: *Ellsworth Holden*
DATE: *July 14, 1982*