

FOR : Mr. Lowell Boggs  
 DATE: 24 September 1981

Situate in Section 24, Town 5, Range 12, Carthage Township, Athens County, State of Ohio and being more particularly described as follows:

Commencing at an "X" notched sandstone found in the Northwest corner of Section 24; thence S  $04^{\circ}30'40''$  W along the West line of Section 24 and the East line of Section 30, 1,822.5 feet (+/-) to a  $1\frac{1}{4}$ " iron pipe set at the Section lines' intersection with the centerline (survey) of Carthage Township Road No. 142, said  $1\frac{1}{4}$ " iron pipe set also being the real point of beginning of the tract herein described:

Thence S  $84^{\circ}29'03''$  E along the said survey centerline and the Grantor's North property line, 534.03 feet to a railroad spike found in the Grantor's Northeast property corner and the Northwest property corner of a 6.00 acre tract owned by S. Lowell & Catherine M. Boggs as recorded in Deed Book 332, Page 131 in the Athens County Recorder's Office, Athens County, Ohio; thence S  $05^{\circ}23'16''$  W along the West line of said 6.00 acre tract and the Grantor's most Easterly property line, 904.38 feet to a 1" iron pinch pipe found in the Southwest corner of said 6.00 acre tract, passing through a 1" iron pinch pipe found at 20.00 feet; thence N  $85^{\circ}14'10''$  W along one of the Grantor's Southerly lines, 263.90 feet to an iron pin found in one of the Grantor's Southeasterly property corners and the most Northerly Northwesterly property corner of an existing 10.99 acre tract owned also by Lowell & Catherine Boggs as recorded in Deed Book 304, Page 413 in said Recorder's Office; thence N  $10^{\circ}00'56''$  W along a random line, 942.52 feet to the point of beginning, passing through a  $1\frac{1}{4}$ " iron pipe set for reference at 912.52 feet, and containing 8.5113 acres.

Subject to all legal highways and easements of record.

Grantor claims title for the above described tract by Deed Book 220, Page 259 as recorded in the Athens County Recorder's Office, Athens County, Ohio.

The above description is based on a survey by Gerald W. Bayha, Registered Professional Surveyor No. S-6139 (Job No. 981-03), completed on 24 September 1981.

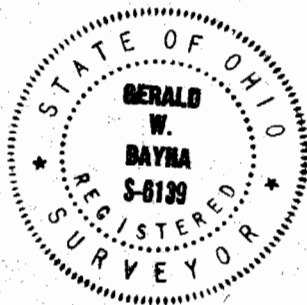

Description checked for  
 Mathematical Accuracy  
 ATHENS COUNTY  
 ENGINEER'S OFFICE

By: \_\_\_\_\_

Date: \_\_\_\_\_

CAP 2/24

