

HIGHLAND SURVEYING LTD.

80 Fayette St.
Nelsonville, Ohio 45764

Phone 740-753-1264
Fax 740-753-1264

Description of a 17.944 Acre Tract

Situated in Section 31, T-5, R-12, Carthage Township, Athens County, State of Ohio and being a part of a tract as described in Volume 380, Page 361 of the Deed Records of Athens County and being more particularly described as follows:

BEGINNING at a point in the center of CR-44 that bears North 77°19'52"East, 1485.93 from the Northwest corner of the Southwest ¼ of Section 31,

THENCE North 24°48'02"East, 552.75 feet to an iron pin set, (passing an iron pin set at 18.00 feet),

THENCE South 88°01'32"East, 534.43 feet to an iron pin set,

THENCE South 56°58'19"East, 641.78 feet to an iron pin set,

THENCE South 21°02'30"West, 349.70 feet to an 18" White Oak Tree,

THENCE South 17°18'59"West, 302.86 feet to a point in the center of CR-44, (passing an iron pin set at 275.86 feet),

THENCE along the center of said road the following five courses:

North 63°20'41"West, 444.51 feet to a point,

North 72°20'41"West, 204.31 feet to a point, *4410*

North 73°07'09"West, 94.38 feet to a point,

North 67°09'27"West, 150.37 feet to a point,

North 63°15'24"West, 299.54 feet to the point of beginning and containing 17.944 acres.

Bearings are to an assumed meridian and are for angular determination only

Subject to all Easements and Rights of Way of Record

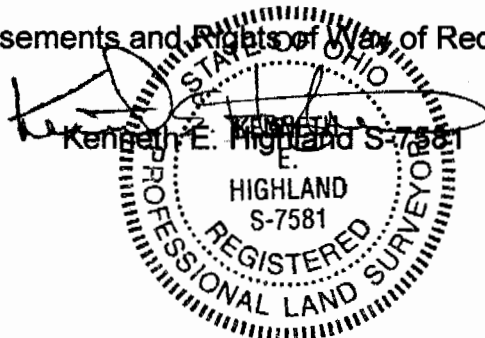

Description Checked for
Mathematical Accuracy
Athens County
ENGINEER'S OFFICE
BY: *S. Blaus*
DATE: *6-14-04*

Guthrie
291-630



17.944 Acres

Point of Beginning
bears N 77° 19' 52" E,
1485.93' from the N.W.
corner of the S.W. 1/4
of Section 31

Pesek
380-361

Mould, etal
358-1084 OR

18" White Oak

Guthrie
31-387 OR

CR-44

Pesek
380-361

O=Iron Pin Set

Description Checked for
Mathematical Accuracy
Athens County
ENGINEER'S OFFICE

BY: S. Blaise
DATE: 6-14-04

Scale 1"=200'



PLAT OF SURVEY OF A 17.944 AC. TRACT

SURVEYED FOR PESEK

SUBDIVISION -

TOWNSHIP CARTLAGE SECTION 31 TOWN 5 RANGE 12

CORPORATION - COUNTY ATHENS STATE OHIO

SCALE 1"= 200' DATE JUNE 2004

Kenneth E. Highland
80 Fayette St.
Nelsonville, Ohio 45764
740-753-1264



Kenneth E. Highland S-7581

CAR # 31