

**Description of Parcel No. 2**  
**(22.938 Acres)**

Situated in the State of Ohio, County of Athens, Township of Carthage, being in the south half of the northeast quarter of Section 6, Range 12 West, Township 5 North, of the "Ohio Company's Purchase" and being bounded and described as follows:

Beginning at a 2 1/2" iron pipe found at the southeast corner of the northeast quarter of Section 6 (Note: Reference bearing on the south line of the northeast quarter of Section 6 used as North 89°56'21" West);

thence, from said Point of Beginning and running with said quarter-section line, North 89°56'21" West a distance of 2,034.30 feet to a point in the centerline of County Road No. 65 (Deep Hollow Road), passing through two iron pins set at distances of plus 1,904.30 feet and plus 2,004.30 feet, respectively;

thence, with the centerline of County Road No. 65, the following 28 courses:

1. North 38°26'35" East a distance of 36.04 feet to a point;
2. thence North 35°25'33" East a distance of 102.93 feet to a point;
3. thence North 36°59'24" East a distance of 90.59 feet to a point;
4. thence North 39°55'11" East a distance of 100.62 feet to a point;
5. thence North 43°24'08" East a distance of 49.90 feet to a point;
6. thence North 44°34'42" East a distance of 130.55 feet to a point;
7. thence North 50°22'10" East a distance of 95.90 feet to a point;
8. thence North 61°56'06" East a distance of 108.84 feet to a point;
9. thence North 78°42'39" East a distance of 73.72 feet to a point;
10. thence South 84°29'32" East a distance of 97.11 feet to a point;
11. thence South 73°32'21" East a distance of 56.52 feet to a point;
12. thence South 71°58'32" East a distance of 116.09 feet to a point;
13. thence South 77°22'02" East a distance of 56.43 feet to a point;
14. thence South 86°17'36" East a distance of 103.25 feet to a point;
15. thence North 84°10'04" East a distance of 105.17 feet to a point;
16. thence North 81°41'18" East a distance of 93.02 feet to a point;
17. thence North 82°15'33" East a distance of 90.93 feet to a point;
18. thence North 85°31'54" East a distance of 152.11 feet to a point;
19. thence North 77°15'47" East a distance of 55.88 feet to a point;
20. thence North 63°45'05" East a distance of 68.64 feet to a point;

- 21. thence North 58°33'10" East a distance of 174.53 feet to a point;
- 22. thence North 51°44'08" East a distance of 96.29 feet to a point;
- 23. thence North 46°15'31" East a distance of 68.60 feet to a point;
- 24. thence North 44°34'49" East a distance of 71.54 feet to a point;
- 25. thence North 39°46'32" East a distance of 88.70 feet to a point;
- 26. thence North 36°06'06" East a distance of 72.87 feet to a point;
- 27. thence North 34°27'10" East a distance of 71.36 feet to a point;
- 28. thence North 35°43'30" East a distance of 43.95 feet to a point in the east line of the southeast quarter of the northeast quarter of Section 6;

thence, with said section line, South 00°04'12" East a distance of 1,001.11 feet to the Point of Beginning, passing through two iron pins set at distances of plus 30.00 feet and plus 130.00 feet, respectively;

Containing 22.938 acres, more or less, from Parcel No. F01-001-0015900.

Subject to all legal right-of-ways, easement, restrictions, reservations, and zoning regulations of record.

Subject to the right-of-way of County Road No. 65 (Deep Hollow Road).

Subject to the 100-Year Flood Plain restrictions, if applicable.

All iron pins set are 5/8" x 30" rebar capped "Biedenbach Surveying, LLC. 7881 – 8534".

The bearings in this description are for angle calculations only and are based on the south line of the northeast quarter of Section 6 used as an assumed bearing of North 89°56'21" West.

A plat for the above-described survey has been submitted for file at the County Engineer's Office.

The above description was prepared by Russell Claus, Registered Surveyor No. 8534, based on an actual field survey of January 29, 2016; said survey being subject to any facts that may be disclosed in a full and accurate title search.

Prior deed: Official Records Volume 510, Page 1060.

Surveyor: Russell Claus  
Date: 1/29/2016  
Survey File: GB-2407



Pennington Land Co.  
18.114 Acres  
O.R.V. 360, Pg. 1904

THE BEARINGS ON THIS PLAT ARE FOR ANGLE CALCULATIONS ONLY AND ARE BASED ON THE NORTH LINE OF THE NORTHWEST QUARTER OF THE NORTHEAST QUARTER OF SECTION 6 USED AS NORTH 89°53'21" EAST.

SUBJECT TO ALL LEGAL RIGHT-OF-WAYS, EASEMENTS, RESTRICTIONS, RESERVATIONS, AND ZONING REGULATIONS OF RECORD. SUBJECT TO 100 YEAR FLOOD PLAIN RESTRICTIONS, IF APPLICABLE. SUBJECT TO ANY FACTS THAT MAY BE DISCLOSED IN A FULL AND ACCURATE TITLE SEARCH.



Campbell's Manor LLC  
80 Acres  
O.R.V. 186, Pg. 64

- ⊙ = Iron Pipe Found (Size Noted)
- ⊠ = Marked Stone Found
- ⊞ = 5/8" Iron Pin Found "CTS 6844"
- ⊚ = 1/2" Iron Pin Found "MBH 7397"
- = 5/8" I.P. Set "Biedenbach 7881 - Claus 8543"

Jerry D. Gibson and Deborah A. Gibson  
55.136 Acres  
O.R.V. 242, Pg. 676

Jerry D. Gibson - 72.93 Acres  
D.V. 308, Pg. 2663

Jerry D. Gibson - 9.696 Ac.  
O.R.V. 242, Pg. 676

Basis of Bearings  
N 89°53'21" E 1343.95' Total

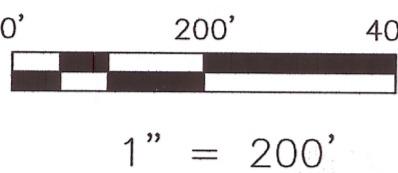

## Survey Plat for Tusco Forestry

SITUATED IN THE STATE OF OHIO, COUNTY OF ATHENS, TOWNSHIP OF CARTHAGE, BEING THE NORTHEAST QUARTER OF SECTION 6, RANGE 12 WEST, TOWNSHIP 5 NORTH, OF "THE OHIO COMPANY'S PURCHASE".

### PERTINENT DOCUMENTS

- (1) ALL DEEDS AS SHOWN.
- (2) COUNTY TAX MAPS.
- (3) U.S.G.S. QUAD. MAPS "CUTLER"
- (4) SURVEY PLAT BY CHARLES SMITH
- (5) SURVEY PLAT BY JOHN BRANNER

Brian Helms Miller and Ann Patrice Miller  
97.028 Acres  
O.R.V. 268, Page 1546

Parcel No. 3  
46.745 Acres

New Split From:  
Tusco Forestry, LLC  
162 Acres Deed  
O.R.V. 510, Pg. 1060  
Parcel No.  
F01-001-0015900

Note A:  
Marked stone called for by Branner in 1998 was not found.  
Held Smith pin from 2014.

Parcel No. 4  
41.331 Acres

New Split From:  
Tusco Forestry, LLC  
162 Acres Deed  
O.R.V. 510, Pg. 1060  
Parcel No.  
F01-001-0015900

Parcel No. 5  
46.133 Acres

New Split From:  
Tusco Forestry, LLC  
162 Acres Deed  
O.R.V. 510, Pg. 1060  
Parcel No.  
F01-001-0015900

Parcel No. 2  
22.938 Acres

New Split From:  
Tusco Forestry, LLC  
162 Acres Deed  
O.R.V. 510, Pg. 1060  
Parcel No.  
F01-001-0015900

Parcel No. 1  
10.262 Acres

New Split From:  
Tusco Forestry, LLC  
162 Acres Deed  
O.R.V. 510, Pg. 1060  
P.N. F01-001-0015900

**167.409 Acres**

Tusco Forestry, LLC  
162 Acres Deed  
O.R.V. 510, Pg. 1060

Marlin S. Gainer  
Tract II  
163.620 Acres  
O.R.V. 345, Page 902

### SURVEYORS CERTIFICATION:

I HEREBY CERTIFY THAT THIS PLAT IS TRUE AND CORRECT TO THE BEST OF MY KNOWLEDGE AND THAT IT WAS PREPARED FROM AN ACTUAL FIELD SURVEY OF THE PREMISES. TITLE IS NOT GUARANTEED BY THIS SURVEY.

*Russell Claus* 1/29/2016  
DATE:

RUSSELL W. CLAUS  
REG. SURVEYOR 8534  
BIEDENBACH SURVEYING, LLC.  
114 ADAMS AVENUE  
WOODSFIELD, OHIO 43793  
1.740.472.1262 OFFICE  
1.740.472.5298 FAX

NOTE: THIS MAP IS AN ORIGINAL COPY ONLY WITH ORIGINAL SIGNATURE AND ORIGINAL STAMP.

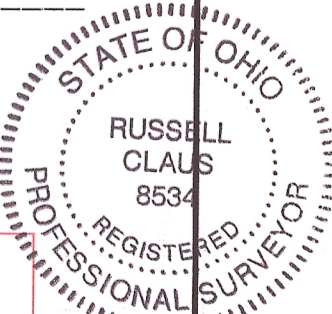

Survey File No.: GB-2407

LINE	BEARING	DISTANCE
L1	S 35°43'30" W	43.95'
L2	S 34°27'10" W	71.36'
L3	S 36°06'06" W	72.87'
L4	S 39°46'32" W	88.70'
L5	S 44°34'49" W	71.54'
L6	S 46°15'31" W	68.60'
L7	S 51°44'08" W	96.29'
L8	S 58°33'10" W	174.53'
L9	S 63°45'05" W	68.64'
L10	S 59°34'14" W	100.26'
L11	S 48°10'03" E	53.88'
L12	S 69°08'55" E	88.25'
L13	S 50°00'49" E	87.52'
L14	S 78°45'32" E	80.01'
L15	S 60°38'41" E	115.61'
L16	S 53°41'24" E	99.85'
L17	S 72°40'54" E	61.04'
L18	S 46°11'51" E	100.58'
L19	S 87°32'29" E	43.67'
L20	S 50°15'30" E	71.11'
L21	S 13°25'36" E	53.36'
L22	S 30°43'56" E	65.75'
L23	N 07°09'38" E	52.96'

Marlin S. Gainer  
Tract II  
163.620 Acres  
O.R.V. 345, Page 902

L24	N 45°28'12" W	74.11'
L25	N 03°54'53" W	43.30'
L26	N 36°19'50" W	90.81'
L27	N 20°20'34" W	64.85'
L28	N 65°00'41" W	63.92'
L29	N 11°36'16" E	121.30'
L30	N 34°13'24" W	79.11'
L31	N 09°26'09" W	109.49'
L32	N 12°53'30" E	73.92'
L33	N 41°56'08" E	36.67'
L34	N 25°19'36" E	45.96'
L35	N 08°45'49" W	115.45'
L36	N 56°12'05" W	114.33'
L37	N 48°30'45" W	106.85'
L38	N 27°46'58" W	88.85'
L39	N 14°59'17" E	16.07'
L40	N 38°27'10" W	87.99'
L41	N 33°56'27" W	117.93'
L42	N 23°28'29" W	58.22'
L43	N 47°19'36" W	51.96'
L44	N 39°14'04" W	94.33'
L45	N 19°17'49" W	90.10'

L46	N 16°12'37" W	58.23'
L47	N 27°34'14" W	46.62'
L48	N 25°13'53" W	39.47'
L49	N 37°31'19" E	73.23'
L50	N 17°27'22" W	61.77'
L51	N 16°57'33" E	56.97'
L52	N 26°03'46" E	44.01'
L53	N 73°37'41" E	31.82'
L54	N 44°46'24" E	137.54'
L55	N 33°54'28" E	82.60'
L56	N 40°42'07" E	183.72'
L57	N 37°36'23" E	101.89'
L58	N 32°53'58" E	21.31'
L59	N 43°24'08" E	49.90'
L60	N 44°34'42" E	130.55'
L61	N 50°22'10" E	95.90'
L62	N 61°56'06" E	108.84'
L63	N 78°42'39" E	73.72'
L64	S 84°29'32" E	97.11'
L65	S 73°32'21" E	56.52'
L66	S 77°15'47" W	55.88'
L67	S 85°31'54" W	152.11'
L68	S 82°15'33" W	90.93'
L69	S 81°41'18" W	93.02'
L70	S 84°10'04" W	105.17'
L71	N 86°17'36" W	103.25'
L72	N 77°22'02" W	56.43'

L73	N 71°58'32" W	116.09'
L74	N 89°53'21" E	338.32'
L75	S 38°26'35" W	36.04'
L76	S 35°25'33" W	102.93'
L77	S 36°59'24" W	90.59'
L78	S 39°55'11" W	100.62'