

Description of Parcel No. 3 (46.745 Acres)

Situated in the State of Ohio, County of Athens, Township of Carthage, being in the northeast quarter of Section 6, Range 12 West, Township 5 North, of the "Ohio Company's Purchase" and being bounded and described as follows:

Beginning at a marked stone found at the northwest corner of the northeast quarter of Section 6 (Note: Reference bearing on the north line of the northwest quarter of the northeast quarter of Section 6 used as North 89°53'21" East), passing through four iron pins set at distances of plus 481.26 feet, plus 749.66 feet, plus 910.10 feet, and plus 975.63 feet, respectively;

thence, from said Point of Beginning and running with said section line, North 89°53'21" East a distance of 1,005.63 feet to a point in the centerline of a run;

thence, with the centerline of said run, the following 36 courses:

1. South 32°53'58" West a distance of 21.31 feet to a point;
2. thence South 37°36'23" West a distance of 101.89 feet to a point;
3. thence South 40°42'07" West a distance of 183.72 feet to a point;
4. thence South 33°54'28" West a distance of 82.60 feet to a point;
5. thence South 44°46'24" West a distance of 137.54 feet to a point;
6. thence South 73°37'41" West a distance of 31.82 feet to a point;
7. thence South 26°03'46" West a distance of 44.01 feet to a point;
8. thence South 16°57'33" West a distance of 56.97 feet to a point;
9. thence South 17°27'22" East a distance of 61.77 feet to a point;
10. thence South 37°31'19" West a distance of 73.23 feet to a point;
11. thence South 25°13'53" East a distance of 39.47 feet to a point;
12. thence South 27°34'14" East a distance of 46.62 feet to a point;
13. thence South 16°12'37" East a distance of 58.23 feet to a point;
14. thence South 19°17'49" East a distance of 90.10 feet to a point;
15. thence South 39°14'04" East a distance of 94.33 feet to a point;
16. thence South 47°19'36" East a distance of 51.96 feet to a point;
17. thence South 23°28'29" East a distance of 58.22 feet to a point;
18. thence South 33°56'27" East a distance of 117.93 feet to a point;
19. thence South 38°27'10" East a distance of 87.99 feet to a point;
20. thence South 14°59'17" West a distance of 16.07 feet to a point;

21. thence South 27°46'58" East a distance of 88.85 feet to a point;
22. thence South 48°30'45" East a distance of 106.85 feet to a point;
23. thence South 56°12'05" East a distance of 114.33 feet to a point;
24. thence South 08°45'49" East a distance of 115.45 feet to a point;
25. thence South 25°19'36" West a distance of 45.96 feet to a point;
26. thence South 41°56'08" East a distance of 36.67 feet to a point;
27. thence South 12°53'30" West a distance of 73.92 feet to a point;
28. thence South 09°26'09" East a distance of 109.49 feet to a point;
29. thence South 34°13'24" East a distance of 79.11 feet to a point;
30. thence South 11°36'16" West a distance of 121.30 feet to a point;
31. thence South 65°00'41" East a distance of 63.92 feet to a point;
32. thence South 20°20'34" East a distance of 64.85 feet to a point;
33. thence South 36°19'50" East a distance of 90.81 feet to a point;
34. thence South 03°54'53" East a distance of 43.30 feet to a point;
35. thence South 45°28'12" East a distance of 74.11 feet to a point;
36. thence South 07°09'38" West a distance of 52.96 feet to a point in the centerline intersection with County Road No. 65 (Deep Hollow Road);

thence, with the centerline of County Road No. 65, the following seven courses:

1. North 73°32'21" West a distance of 56.52 feet to a point;
2. thence North 84°29'32" West a distance of 97.11 feet to a point;
3. thence South 78°42'39" West a distance of 73.72 feet to a point;
4. thence South 61°56'06" West a distance of 108.84 feet to a point;
5. thence South 50°22'10" West a distance of 95.90 feet to a point;
6. thence South 44°34'42" West a distance of 130.55 feet to a point;
7. thence South 43°24'08" West a distance of 49.90 feet to a point in the centerline intersection with a run;

thence, with the centerline of said run, the following thirteen courses:

1. North 30°43'56" West a distance of 65.75 feet to a point;

2. thence North $13^{\circ}25'36''$ West a distance of 53.36 feet to a point;
3. thence North $50^{\circ}15'30''$ West a distance of 71.11 feet to a point;
4. thence North $87^{\circ}32'29''$ West a distance of 43.67 feet to a point;
5. thence North $46^{\circ}11'51''$ West a distance of 100.58 feet to a point;
6. thence North $72^{\circ}40'54''$ West a distance of 61.04 feet to a point;
7. thence North $53^{\circ}41'24''$ West a distance of 99.85 feet to a point;
8. thence North $60^{\circ}38'41''$ West a distance of 115.61 feet to a point;
9. thence North $78^{\circ}45'32''$ West a distance of 80.01 feet to a point;
10. thence North $50^{\circ}00'49''$ West a distance of 87.52 feet to a point;
11. thence North $69^{\circ}08'55''$ West a distance of 88.25 feet to a point;
12. thence North $48^{\circ}10'03''$ West a distance of 53.88 feet to a point;
13. thence North $59^{\circ}34'14''$ West a distance of 100.26 feet to a point in the west line of the southwest quarter of the northeast quarter of Section 6;

thence, with said quarter-section line, North $01^{\circ}02'53''$ East a distance of 562.18 feet to an iron pin set at the southwest corner of the northwest quarter of the northeast quarter of Section 6, passing through two iron pins set at distances of plus 30.00 feet and plus 130.00 feet, respectively;

thence, with the west line of the northwest quarter of the northeast quarter of Section 6, North $00^{\circ}56'50''$ West a distance of 1,372.47 feet to the Point of Beginning;

Containing 46.745 acres, more or less, from Parcel No. F01-001-0015900.

Subject to all legal right-of-ways, easement, restrictions, reservations, and zoning regulations of record.

Subject to the right-of-way of County Road No. 65 (Deep Hollow Road).

Subject to the 100-Year Flood Plain restrictions, if applicable.

All iron pins set are 5/8" x 30" rebar capped "Biedenbach Surveying, LLC. 7881 – 8534".

The bearings in this description are for angle calculations only and are based on the north line of the northwest quarter of the northeast quarter of Section 6 used as an assumed bearing of North $89^{\circ}53'21''$ East.

A plat for the above-described survey has been submitted for file at the County Engineer's Office.

The above description was prepared by Russell Claus, Registered Surveyor No. 8534, based on an actual field survey of January 29, 2016; said survey being subject to any facts that may be disclosed in a full and accurate title search.

Page 4 of 4
Description of Parcel No. 3 – 46.745 Acres

Prior deed: Official Records Volume 510, Page 1060.

Surveyor: Russell Claus
Date: 1/29/2016
Survey File: GB-2407



Pennington Land Co.
18.114 Acres
O.R.V. 360, Pg. 1904

THE BEARINGS ON THIS PLAT ARE FOR ANGLE CALCULATIONS ONLY AND ARE BASED ON THE NORTH LINE OF THE NORTHWEST QUARTER OF THE NORTHEAST QUARTER OF SECTION 6 USED AS NORTH 89°53'21" EAST.

SUBJECT TO ALL LEGAL RIGHT-OF-WAYS, EASEMENTS, RESTRICTIONS, RESERVATIONS, AND ZONING REGULATIONS OF RECORD. SUBJECT TO 100 YEAR FLOOD PLAIN RESTRICTIONS, IF APPLICABLE. SUBJECT TO ANY FACTS THAT MAY BE DISCLOSED IN A FULL AND ACCURATE TITLE SEARCH.

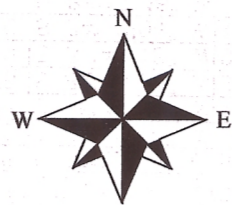

Campbell's Manor LLC
80 Acres
O.R.V. 186, Pg. 64

- ⊙ = Iron Pipe Found (Size Noted)
- ⊠ = Marked Stone Found
- ⊞ = 5/8" Iron Pin Found "CTS 6844"
- ⊚ = 1/2" Iron Pin Found "MBH 7397"
- = 5/8" I.P. Set "Biedenbach 7881 - Claus 8543"

Jerry D. Gibson - 72.93 Acres
D.V. 308, Pg. 2663

Jerry D. Gibson - 9.696 Ac.
O.R.V. 242, Pg. 676

Jerry D. and Deborah A. Gibson
55.136 Acres
O.R.V. 242, Pg. 676

Basis of Bearings
N 89°53'21" E 1343.95' Total

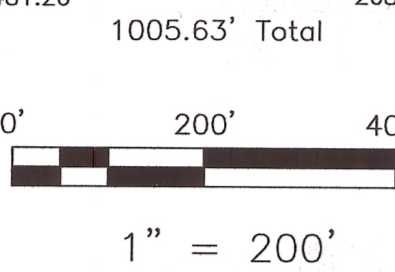

Survey Plat for Tusco Forestry

SITUATED IN THE STATE OF OHIO, COUNTY OF ATHENS, TOWNSHIP OF CARTHAGE, BEING THE NORTHEAST QUARTER OF SECTION 6, RANGE 12 WEST, TOWNSHIP 5 NORTH, OF "THE OHIO COMPANY'S PURCHASE".

PERTINENT DOCUMENTS

- (1) ALL DEEDS AS SHOWN.
- (2) COUNTY TAX MAPS.
- (3) U.S.G.S. QUAD. MAPS "CUTLER"
- (4) SURVEY PLAT BY CHARLES SMITH
- (5) SURVEY PLAT BY JOHN BRANNER

Parcel No. 3
46.745 Acres

New Split From:
Tusco Forestry, LLC
162 Acres Deed
O.R.V. 510, Pg. 1060
Parcel No. F01-001-0015900

Note A:
Marked stone called for by Branner in 1998 was not found.
Held Smith pin from 2014.

Parcel No. 4
41.331 Acres

New Split From:
Tusco Forestry, LLC
162 Acres Deed
O.R.V. 510, Pg. 1060
Parcel No. F01-001-0015900

Parcel No. 5
46.133 Acres

New Split From:
Tusco Forestry, LLC
162 Acres Deed
O.R.V. 510, Pg. 1060
Parcel No. F01-001-0015900

Parcel No. 2
22.938 Acres

New Split From:
Tusco Forestry, LLC
162 Acres Deed
O.R.V. 510, Pg. 1060
Parcel No. F01-001-0015900

Parcel No. 1
10.262 Acres

New Split From:
Tusco Forestry, LLC
162 Acres Deed
O.R.V. 510, Pg. 1060
P.N. F01-001-0015900

167.409 Acres

Tusco Forestry, LLC
162 Acres Deed
O.R.V. 510, Pg. 1060

Marlin S. Gainer
Tract II
163.620 Acres
O.R.V. 345, Page 902

SURVEYORS CERTIFICATION:

I HEREBY CERTIFY THAT THIS PLAT IS TRUE AND CORRECT TO THE BEST OF MY KNOWLEDGE AND THAT IT WAS PREPARED FROM AN ACTUAL FIELD SURVEY OF THE PREMISES. TITLE IS NOT GUARANTEED BY THIS SURVEY.

Russell Claus 1/29/2016
DATE:

RUSSELL W. CLAUS
REG. SURVEYOR 8534
BIEDENBACH SURVEYING, LLC.
114 ADAMS AVENUE
WOODSFIELD, OHIO 43793
1.740.472.1262 OFFICE
1.740.472.5298 FAX

NOTE: THIS MAP IS AN ORIGINAL COPY ONLY WITH ORIGINAL SIGNATURE AND ORIGINAL STAMP.

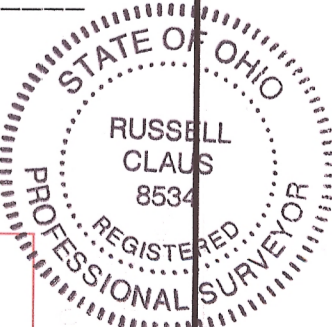

Survey File No.: GB-2407

LINE	BEARING	DISTANCE
L1	S 35°43'30" W	43.95'
L2	S 34°27'10" W	71.36'
L3	S 36°06'06" W	72.87'
L4	S 39°46'32" W	88.70'
L5	S 44°34'49" W	71.54'
L6	S 46°15'31" W	68.60'
L7	S 51°44'08" W	96.29'
L8	S 58°33'10" W	174.53'
L9	S 63°45'05" W	68.64'
L10	S 59°34'14" E	100.26'
L11	S 48°10'03" E	53.88'
L12	S 69°08'55" E	88.25'
L13	S 50°00'49" E	87.52'
L14	S 78°45'32" E	80.01'
L15	S 60°38'41" E	115.61'
L16	S 53°41'24" E	99.85'
L17	S 72°40'54" E	61.04'
L18	S 46°11'51" E	100.58'
L19	S 87°32'29" E	43.67'
L20	S 50°15'30" E	71.11'
L21	S 13°25'36" E	53.36'
L22	S 30°43'56" E	65.75'
L23	N 07°09'38" E	52.96'

Marlin S. Gainer
Tract II
163.620 Acres
O.R.V. 345, Page 902

L24	N 45°28'12" W	74.11'
L25	N 03°54'53" W	43.30'
L26	N 36°19'50" W	90.81'
L27	N 20°20'34" W	64.85'
L28	N 65°00'41" W	63.92'
L29	N 11°36'16" E	121.30'
L30	N 34°13'24" W	79.11'
L31	N 09°26'09" W	109.49'
L32	N 12°53'30" E	73.92'
L33	N 41°56'08" E	36.67'
L34	N 25°19'36" E	45.96'
L35	N 08°45'49" W	115.45'
L36	N 56°12'05" W	114.33'
L37	N 48°30'45" W	106.85'
L38	N 27°46'58" W	88.85'
L39	N 14°59'17" E	16.07'
L40	N 38°27'10" W	87.99'
L41	N 33°56'27" W	117.93'
L42	N 23°28'29" W	58.22'
L43	N 47°19'36" W	51.96'
L44	N 39°14'04" W	94.33'
L45	N 19°17'49" W	90.10'

L46	N 16°12'37" W	58.23'
L47	N 27°34'14" W	46.62'
L48	N 25°13'53" W	39.47'
L49	N 37°31'19" E	73.23'
L50	N 17°27'22" W	61.77'
L51	N 16°57'33" E	56.97'
L52	N 26°03'46" E	44.01'
L53	N 73°37'41" E	31.82'
L54	N 44°46'24" E	137.54'
L55	N 33°54'28" E	82.60'
L56	N 40°42'07" E	183.72'
L57	N 37°36'23" E	101.89'
L58	N 32°53'58" E	21.31'
L59	N 43°24'08" E	49.90'
L60	N 44°34'42" E	130.55'
L61	N 50°22'10" E	95.90'
L62	N 61°56'06" E	108.84'
L63	N 78°42'39" E	73.72'
L64	S 84°29'32" E	97.11'
L65	S 73°32'21" E	56.52'
L66	S 77°15'47" W	55.88'
L67	S 85°31'54" W	152.11'
L68	S 82°15'33" W	90.93'
L69	S 81°41'18" W	93.02'
L70	S 84°10'04" W	105.17'
L71	N 86°17'36" W	103.25'
L72	N 77°22'02" W	56.43'

L73	N 71°58'32" W	116.09'
L74	N 89°53'21" E	338.32'
L75	S 38°26'35" W	36.04'
L76	S 35°25'33" W	102.93'
L77	S 36°59'24" W	90.59'
L78	S 39°55'11" W	100.62'