

**PROPERTY DESCRIPTION OF A 4.294 ACRE TRACT
LOCATED AT 21346 CHAPMAN ROAD
FOR LAURETTA D. WEEKLEY**

SITUATE IN AND BEING A PART OF SECTION 17, TOWN 5, RANGE 12, LOCATED IN THE TOWNSHIP OF CARTHAGE, COUNTY OF ATHENS, AND STATE OF OHIO.

BEGINNING AT THE SOUTHEAST CORNER OF THE SOUTHWEST QUARTER OF SECTION 17 (PER OR 511-1683).

THENCE NORTH 01 DEGREES 27 MINUTES 59 SECONDS EAST A DISTANCE OF 884.40 FEET (PER OR 511-1683) WITH THE EAST LINE OF THE SOUTHWEST QUARTER OF SECTION 17 TO A STANDING SIGN POST (FOUND) AT THE COMMON CORNER BETWEEN THE LAURETTA D. WEEKLEY 4.294 ACRE TRACT, OFFICIAL RECORD 511, PAGE 1683 AND THE JOHN N. DEPOY, JR. 11.36 ACRE TRACT, DEED VOLUME 333, PAGE 867, BEING THE TRUE PLACE OF BEGINNING.

THENCE SOUTH 47 DEGREES 49 MINUTES 26 SECONDS WEST A DISTANCE OF 1151.77 FEET WITH THE COMMON LINE BETWEEN THE LAURETTA D. WEEKLEY 4.294 ACRE TRACT AND THE JOHN N. DEPOY, JR. 11.36 ACRE TRACT TO A 5/8" DIAMETER CAPPED IRON REBAR (SET) IN THE NORTHERLY RIGHT OF WAY LINE OF CHAPMAN ROAD (T-507B), OFFICIAL RECORD 280, PAGE 1428, AS DESCRIBED ON THE RIGHT OF WAY PLAN SHEETS FOR U.S. ROUTE 50 ATH-50-27.21 SHEET 725 OF 781, PASSING A STANDING 1" DIAMETER IRON PIN (FOUND) AT 1004.47 FEET;

THENCE NORTH 45 DEGREES 13 MINUTES 55 SECONDS WEST A DISTANCE OF 259.25 FEET WITH THE NORTHERLY RIGHT OF WAY LINE OF CHAPMAN ROAD TO A 5/8" DIAMETER REBAR (FOUND) WITH AN ALUMINUM CAP AT THE COMMON CORNER BETWEEN THE PATRICIA S. DEPOY 19.219 ACRE TRACT, OFFICIAL RECORD 508, PAGE 954 AND THE LAURETTA D. WEEKLEY 4.294 ACRE TRACT;

THENCE NORTH 59 DEGREES 58 MINUTES 06 SECONDS EAST A DISTANCE OF 692.54 FEET WITH THE COMMON LINE BETWEEN THE PATRICIA S. DEPOY 19.219 ACRE TRACT AND THE LAURETTA D. WEEKLEY 4.294 ACRE TRACT TO A STANDING AXLE (FOUND);

THENCE NORTH 47 DEGREES 20 MINUTES 45 SECONDS EAST A DISTANCE OF 601.30 FEET CONTINUING WITH THE COMMON LINE BETWEEN THE PATRICIA S. DEPOY 19.219 ACRE TRACT AND THE LAURETTA D. WEEKLEY 4.294 ACRE TRACT TO A STANDING AXLE (FOUND) ON THE EAST LINE OF THE SOUTHWEST QUARTER OF SECTION 17;

THENCE SOUTH 01 DEGREES 27 MINUTES 59 SECONDS WEST A DISTANCE OF 163.34 FEET WITH THE EAST LINE OF THE SOUTHWEST QUARTER OF SECTION 17 TO THE TRUE PLACE OF BEGINNING;

CONTAINING 4.294 ACRES.

BEING ALL OF THAT SAME TRACT OF LAND DEEDED TO LAURETTA D. WEEKLEY, BY THOMAS E. WEEKLEY, JR. AND DESCRIBED IN OFFICIAL RECORD 511, PAGE 1683.

SUBJECT TO ALL LEGAL HIGHWAYS, RIGHTS OF WAYS, RESERVATIONS, PROTECTIVE COVENANTS, UTILITY EASEMENTS, GAS, OIL, MINERAL LEASES, AND ALL RESTRICTIONS OF RECORD IN THE CHAIN OF TITLE.

BEING TAXED AS PARCEL F010010024700.

THIS DESCRIPTION WAS PREPARED BY NELSON B. DOUGLASS P.S. #7296 AND WAS PREPARED FROM A FIELD SURVEY COMPLETED ON JULY 19, 2019, THE PLAT - DATED JULY 23, 2019, (PROJECT #2019-0046) IS ATTACHED HERETO, AND THEREBY MADE A PART OF THIS DESCRIPTION.

MONUMENTS DESCRIBED AS SET ARE IRON REBAR (5/8" DIAMETER, 30 INCHES LONG), BEARING YELLOW PLASTIC CAPS INSCRIBED "DOUGLASS" - "PS 7296".

THE BEARINGS AND DISTANCES USED IN THE ABOVE DESCRIPTION ARE BASED ON THE OHIO STATE PLANE COORDINATE SYSTEM, SOUTH ZONE, NAD '83 (2011) epoch 2010, ODOT MOUNTPOINT, ODOT NAD '83 (2011)_CMR_PLUS, U.S. SURVEY FEET.

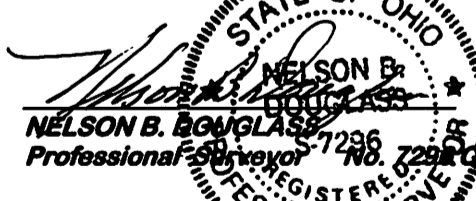
NELSON B. DOUGLASS
Professional Engineer No. 7296
July 23, 2019
(Date)

WATERMAN DOUGLASS ASSOCIATES, L.L.C.
Professional Engineers and Surveyors

P.O. BOX 126
533 ROSEMAR ROAD
PARKERSBURG, WV 26102-0126
1-304-428-5715 TEL
e-mail ndouglass@watermandouglass.com

Legal Description Pre-Approval
APPROVED
All transfers are subject to
Athens County Conveyance Standards

PERSON (S) PLANNING TO DISTURB 1 OR MORE ACRES MAY NEED TO OBTAIN A NATIONAL POLLUTION DISCHARGE ELIMINATION SYSTEM CONSTRUCTION GENERAL PERMIT FROM THE APPROPRIATE STATE AGENCY. OTHER LOCAL SEDIMENT EROSION CONTROL PERMITS MAY ALSO APPLY. PLEASE CONTACT THE COUNTY ENGINEER OR THE SOIL AND WATER CONSERVATION DISTRICT REPRESENTING THE AREA FOR REFERENCES TO LOCAL SEDIMENT EROSION CONTROL PERMITS.

THOMAS E WEEKLEY
JENNIFER L WEEKLEY
OR 330-487
73.400 ACRES

Reference: Platbook & Associates
2146 Chapman Road, Athens, Ohio 45924
Phone: 740.593.1111 Fax: 740.593.1112
Email: info@platbook.com
Survey No. 2019-0046



TRUE P.O.B.

PATRICIA S. DEPOY
OR 508-954
19.219 ACRES

PATRICIA S DEPOY
OR 508-954
68.89 ACRES

LAURETTA D. WEEKLEY
OR 511-1683
4.294 ACRES
PARCEL: F010010024700

JOHN N. DEPOY, JR
DV 333-867
11.36 ACRES

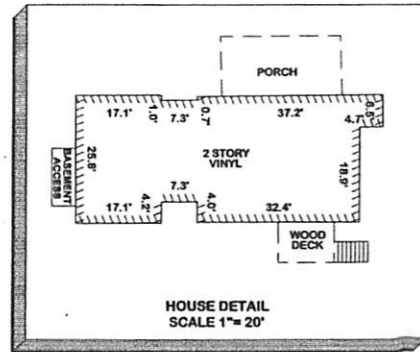

LEGEND

- These standard symbols may be found in the drawing.
- x Point
 - 1" Standing Iron Pin (Found)
 - ⊙ 5/8" Rebar (Found)
 - ⊙ 5/8" Rebar (Found) with aluminum cap
 - ⊙ Standing Axle (Found)
 - ⊙ Standing Sign Post (Found)
 - ⊙ 5/8" X 30" Capped Rebar (Set)
 - Electric Pole

This Survey is valid only if the print has the Surveyor's original signature and an original blue inked seal. Otherwise it is a fraudulent or altered copy and is void.

All rights reserved. Copyright © 2019 by Nelson B. Douglas

REV.	DATE	COMMENT
0	07/23/19	ISSUED

NELSON B. DOUGLAS P.E.
WATERMAN-DOUGLASS AND ASSOCIATES, L.L.C.
 Engineers and Surveyors
 533 ROSEMAR ROAD
 PARKERSBURG, WV 26102-0128
 304-428-5715 e-mail ndouglass@watermandouglass.com

Section 17, Town 5, Range 12
Carthage Township
Athens County, OHIO
Tax Map 16

21346 Chapman Road
For: Laurretta D. Weekley

DATE: 07/23/2019

PROJ NO. 2019-0046

