

Resolved, Fuller

15.2.

CHAUNCEY

Is situated in 17th division lots No 341 342 343 344 345 346 347 348 and 349 Sections 19 & 20 and a part of Section 26 all in Town 10 Range 14 Ohio Company's Purchase main street is 100 links in width all other streets are 100 links wide The Alleys are 25 links wide The lots 75 links in width and 227 links in length parallel or at right angles to the streets they join with the exception of such as are fractional Main street bears N 74° E all other streets are either parallel or at right angles to main unless their particular bearings be noted on the plat

Table showing the contents of fractional lots

Section	Lot	Area	Area	Area	Area	Area	Area	Area	Area	Area		
1	1	165	14	176	105	6	49	127	25	372	093	
"	2	044	"	177	095	"	50	113	"	370	153	
"	3	105	"	178	109	"	90	095	30	329	090	
"	4	091	"	179	109	"	94	081	"	380	106	
"	5	187	"	180	172	"	95	067	"	331	120	
"	6	117	"	181	186	"	96	108	"	413	110	
"	7	183	19	214	101	"	97	082	41	489	159	
"	9	113	"	215	115	"	98	105	"	500	143	
"	10	150	"	216	129	4	67	147	45	374	200	
"	14	190	"	217	067	"	68	108	46	579	200	
"	15	176	"	218	090	"	69	068	53	579	188	
"	16	161	"	219	104	9	70	063	"	580	144	
"	2	5	023	"	237	062	"	71	049	"	581	140
"	3	31	085	"	238	043	"	72	127	"	582	136
"	32	095	"	239	044	"	73	166	"	583	132	
"	4	27	181	"	240	175	10	145	043	"	584	128
"	25	112	"	241	161	"	146	084	"	585	124	
"	29	075	"	242	147	"	147	121	"	586	120	
"	30	039	23	250	169	"	148	160	54	587	115	
"	33	149	"	251	130	11	149	169	"	588	111	
"	5	17	187	24	252	038	"	146	141	"	589	107
"	18	170	"	253	112	14	144	110	"	590	103	
"	19	159	"	254	175	"	145	137	"	591	099	
"	40	140	25	268	163	"	146	145	"	592	093	
"	46	129	"	269	090	"	147	124	"	593	091	
"	47	115	"	270	023	"	148	138	"	594	072	
"	48	141	"	271	001	"	149	152	57	412	127	

A table showing how corner stones were set

Section	Lot	Corner
1	1	NE
2	8	NE
3	52	NE
9	70	SW
10	146	NE
"	150	SE
16	196	SE
17	309	SE
23	262	SE
25	371	SW
"	380	SE
26	388	SE
27	396	SE
28	404	SE
29	412	SE
30	419	SE
31	426	SE
32	434	SE
42	501	SW
52	578	NE
56	611	NE

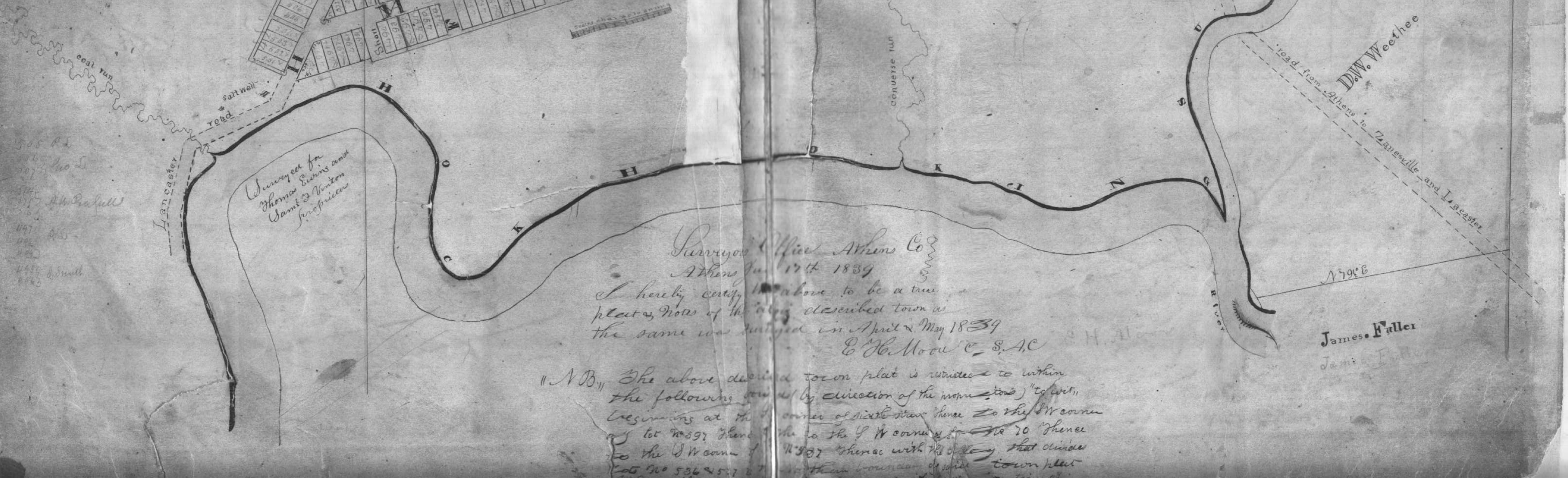

Surveyed for Athens Co
Athens July 17th 1839
I hereby certify the above to be a true
plat & now of the city described town as
the same was surveyed in April & May 1839
E. H. Moore C. S. A. C.

"A B" The above described town plat is situated to within
the following bearings & by direction of the instrument "to wit"
beginning at the corner of sixth street thence to the SW corner
of lot No 397 thence to the SE corner of lot No 397 thence
to the SW corner of lot No 397 thence with the alley that divides
lot No 536 & 537 to the SE corner of lot No 536 & 537 thence
to the SE corner of lot No 536 & 537 thence to the SE corner of lot No 536 & 537

James Fuller

James B. Weston