

Situate in the City of Athens, County of Athens, State of Ohio, and being a part of Lease Lot #49 and Lease Lot #50 in Section 11 and Section 17, Twp.-9N, Rng.-14W Congress Lands East of the Scioto River.

Being a survey of a 16.10 acre parcel and of a 16.94 acre parcel conveyed to M. Michael and JoAnne L'Heureux of record in Official Record 228 page 205, and a survey of a 3.761 acre parcel conveyed to Mark A. Lee, Etal, of record in Official Record 288 page 1951 in the Office of the recorder, Athens County, Ohio.

The undersigned, M. Michael L'Heureux, JoAnne L'Heureux, and Mark A. Lee, hereby certify that the attached plat correctly represents their "Columbus Road Commercial Subdivision", a subdivision of Lot #1 through Lot #9 and Reserve "A".

The undersigned further agrees that any use of the improvements made on this land shall be in conformity with all existing valid zoning, platting, health and other lawful rules and regulations for the benefit of themselves and all other subsequent owners or assignees taking title from, under, or through the undersigned.

General Notes:

Floodway as conditionally approved by the Federal Emergency Management Agency in Case #96-05-16-167R on file at the Athens City Code Enforcement Office.

The entire acreage contained in this Columbus Road Commercial Subdivision is located in the City of Athens Wellhead Protection Area as approved by the Ohio Environmental Protection Agency on February 25, 1997, and is on file at the Athens City Code Enforcement Office.

Easements shown on this plat are for the construction, installation, operation, maintenance, repair, replacement, of removal of water, sewer, electric, telephone, cable, or other utilities or services of the same and are to be maintained as such forever.

In witness thereof this 29th day of August, 2002.

Witness Cheryl D. Dawson Signed M. Michael L'Heureux  
M. Michael L'Heureux

Witness Jedd M. Bean Signed JoAnne L'Heureux  
JoAnne L'Heureux

Witness Amber Bamberach Signed Mark A. Lee  
Mark A. Lee

State of Ohio, County of Athens:

Before me a Notary Public in and for said County personally came

M. Michael L'Heureux,

JoAnne L'Heureux,

Mark A. Lee, who acknowledge the signing of the foregoing instrument to be of their voluntary act and deed for the purposes therein expressed. In witness whereof I have hereunto set my hand and affixed my official seal this 29th day of August, 2002.

Notary: Deborah J. Allen DEBORAH J. ALLEN

My Commission Expires: 4-17-07

Address: 2433 LOTTRIDGE ROAD

City & State COOLVILLE, OH 45723

# Columbus Road Commercial Subdivision

City of Athens County of Athens State of Ohio

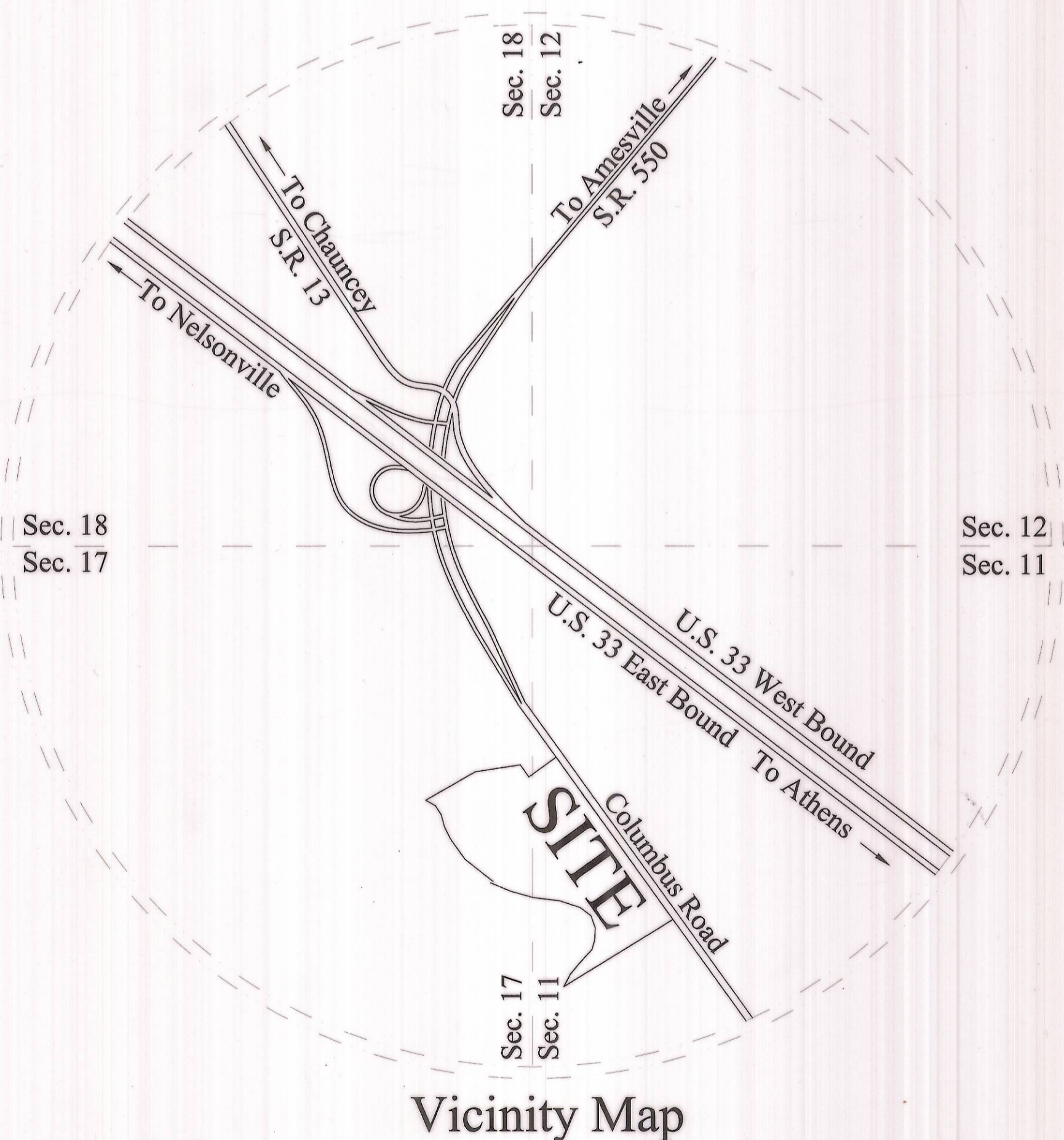

#400 transferred

Approved this 26th day of August, 2002.

Joanne D. Piskary  
City Planning Commission Athens, Ohio.

Approved this 27th day of August, 2002.

Wayne C. Key  
Service-Safety Director Athens, Ohio.

Approved and Accepted this 29th day of July, 2002 by ordinance number 0-84-02

In witness thereof, I have hereon set my hand and affixed my seal this 13th day of August, 2002

Debra J. Walker  
City Clerk, Athens, Ohio.

Transferred this 13 day of Sept, 2002

Jill A. Thompson  
County Auditor Athens County, Ohio.

Filed for record this 17 day of September 2002

at 10:45 A.M Fee \$ 86.40, File Number 02-8666  
02-8557

Julia Michael Scott / gm  
Recorder, Athens County, Ohio.

Recorded this 17 day of September 2002

Plat Envelope Number 525 A+B

Julia Michael Scott / gm  
Recorder, Athens County, Ohio.

Description checked for Mathematical Accuracy  
ATHENS COUNTY ENGINEERS OFFICE  
BY: Julia Scott  
DATE: 9-18-02

200200008556  
Filed for Record in ATHENS COUNTY, OHIO  
JULIA MICHAEL SCOTT  
09-17-2002 RE 10:45 AM.  
PLAT 525 A 43.20

Owner \ Developer:  
M. Michael and JoAnne L'Heureux  
Mark A. Lee



Surveyors Certification:  
I, do hereby certify, that I have prepared this plat based on a actual field survey by S.A. England & Associates, Scott A. England, P.S. #7452 in May - June, 2002, and that said plat is true and correct to the best of my knowledge.

Date 5/28/02

Scott A. England  
Ohio Registered Surveyor #7452

DRAWN BY:	t.m.	DATE:	05/08/2002
CHECKED BY:	s.a.e.	DRAWING NO.:	n/a
JOB NO.:	marklee	SHEET:	1 of 2



# Columbus Road Commercial Subdivision

## City of Athens County of Athens State of Ohio

33.050 Acres Total Acres Surveyed  
2.784 Acres Within Road Right-of-Way

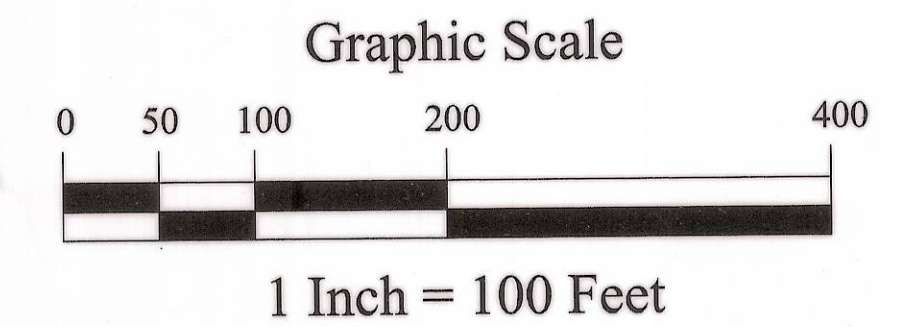
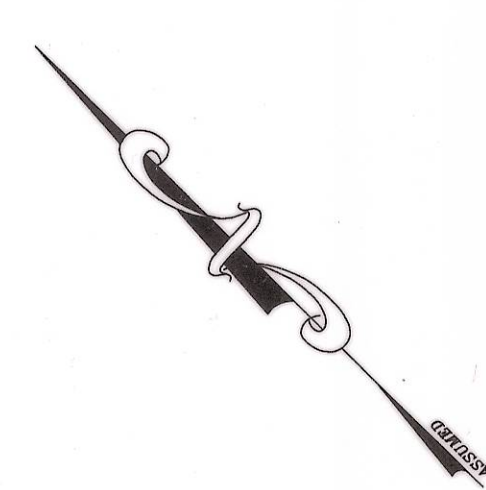

### LEGEND

- - IRON PIN FOUND
- ⊙ - IRON PIN SET  
75' from C.L. Roadway
- - IRON PIN SET  
As Indicated
- △ - RAILROAD SPIKE FOUND
- ▲ - RAILROAD SPIKE SET
- ⊕ - POWER POLE
- ⊗ - TELEPHONE POLE
- ⊙ - LIGHT POLE
- - CONCRETE MONUMENT FOUND
- ⊙ - TREE
- ⊙ - FIRE HYDRANT

200200008557  
Filed for Record in  
ATHENS COUNTY, OHIO  
JULIA MICHAEL SCOTT  
09-17-2002 RE 10:45 AM.  
PLAT 525 B 43.20

DRAWN BY:	T.M.	DATE:	09-09-2002
CHECKED BY:	S.A.E.	REVISED:	09-09-02
JOB NO.:	MARKLEE	SHEET:	1 OF 1

